

Axial piston variable motor
A6VM Series 63



All-purpose high pressure motor
Sizes 28 to 200:
Nominal pressure 400 bar
Maximum pressure 450 bar
Sizes 250 to 1000:
Nominal pressure 350 bar
Maximum pressure 400 bar
Open and closed circuits

Features

Robust motor with long service life
Approved for very high rotational speeds
High control range (can be swiveled to zero)
High torque
Variety of controls
Optionally with flushing and boost-pressure valve mounted
Optionally with integrated or mounted counterbalance valve
Bent-axis design



Axial piston variable motor | A6VM Series 63 Type code

PRANCE HYDRAULIC

01	02	03	04	05	06	07	08	09	10	11	12	13	14	15	16	17	18	19	20
	A6V		M				/	63	W		-	V							-

Overrides for the HA1 and HA2 controls

		28	55	80	107	140	160	200	250	355	500	1000		
08	Without override (without code)	●	●	●	●	●	●	●	●	●	●	●		
	Hydraulic override, remote control, proportional	●	●	●	●	●	●	●	●	●	●	●	T	
	Remote control electric override, two-point	U=12V	●	●	●	●	●	●	●	-	-	-	-	U1
		U=24V	●	●	●	●	●	●	●	-	-	-	-	U2
	Electric override +travel direction valve, electric	U=12V	●	●	●	●	●	●	●	-	-	-	-	R1
U=24V		●	●	●	●	●	●	●	-	-	-	-	R2	

Series

09	Series 6, index 3	63
----	-------------------	----

Direction of rotation

10	Viewed on drive shaft, bidirectional	W
----	--------------------------------------	---

Setting ranges for displacement³⁾

		28	55	80	107	140	160	200	250	355	500	1000	
11	$V_{g\ min} = 0$ to $0.7 V_{g\ max}$	●	●	●	●	●	●	●	-	-	-	-	
	$V_{g\ min} = 0$ to $0.4 V_{g\ max}$ $V_{g\ max} = V_{g\ max}$ to $0.8 V_{g\ max}$	-	-	-	-	-	-	-	●	●	●	●	1
	$V_{g\ min} > 0.4 V_{g\ max}$ to $0.8 V_{g\ max}$ $V_{g\ max} = V_{g\ max}$ to $0.8 V_{g\ max}$	-	-	-	-	-	-	-	●	●	●	●	2

Sealing material

12	FKM (fluoroelastomer)	V
----	-----------------------	---

Drive shaft

		28	55	80	107	140	160	200	250	355	500	1000	
13	Splined shaft DIN 5480	●	●	●	●	●	●	●	-	-	-	-	A
		●	●	●	●	●	●	●	●	●	●	●	Z
	Parallel keyed shaft DIN 6885	-	-	-	-	-	-	-	●	●	●	●	P

Mounting flange

		28	55	80	107	140	160	200	250	355	500	1000	
14	ISO 3019-2	4-hole	●	●	●	●	●	●	●	-	-	-	B
		8-hole	-	-	-	-	-	-	-	-	●	●	●

Port plate for working line⁴⁾

		28	55	80	107	140	160	200	250	355	500	1000			
15	SAE working ports A and B at rear	01	0	●	●	●	●	●	●	●	●	●	010		
		7	●	●	●	●	●	●	●	●	●	●	017		
	SAE working ports A and B lateral, opposite	02	0	●	●	●	●	●	●	●	●	●	020		
		7	●	●	●	●	●	●	●	●	●	●	027		
	SAE working ports A and B lateral, opposite + rear	15	0	-	-	-	-	-	-	●	●	●	150		
	Port plate with 1-stage pres- sure-relief valves for ,mounting a counterbalance valve ⁵⁾	for BVD20	37	0	-	-	●	-	-	-	-	-	-	370	
			8	-	-	-	●	-	-	-	-	-	-	378	
		for BVD20/BVD25	38	0	-	●	●	●	●	●	● ⁶⁾	-	-	-	380
			8	-	-	●	●	●	●	●	● ⁶⁾	-	-	-	388
for BVE	38	0	-	-	-	●	●	●	●	-	-	-	380		
	8	-	-	-	●	●	●	●	●	-	-	-	388		

Valve

Without valve	0
Flushing and boost-pressure valve, mounted	7
Counterbalance valve mounted ⁷⁾	8

● = Available ○ = On request - = Not available

- 3) Please specify exact settings for $V_{g\ min}$ and $V_{g\ max}$ in plain text when ordering: $V_{g\ min} = \dots \text{ cm}^3, V_{g\ max} = \dots \text{ cm}^3$
- 4) Fastening thread, metric
- 5) Only possible in combination with HD, EP and HA control.
- 6) Type code for counterbalance valve to be quoted separately in accordance with data sheet 95522- BVD or 95525-BVE.
- 7) Counterbalance valve MHB32, please contact us.



A6VM Series 63 | Axial piston variable motor Type code

PRANCE HYDRAULIC

01	02	03	04	05	06	07	08	09	10	11	12	13	14	15	16	17	18	19	20
	A6V		M				/	63	W		-	V							-

Speed sensor

		28	55	80	107	140	160	200	250	355	500	1000 ⁹⁾	
16	Without speed sensor (without code)	●	●	●	●	●	●	●	●	●	●	●	O
	Prepared for HDD speed sensor	▲	▲	▲	▲	▲	▲	▲	●	●	●	-	F
	HDD speed sensor mounted ⁹⁾	▲	▲	▲	▲	▲	▲	▲	●	●	●	-	H
	Prepared for DSM/DSA speed sensor	●	●	●	●	●	●	●	-	-	-	-	U
	DSM/DSA speed sensor mounted ⁹⁾	●	●	●	●	●	●	●	-	-	-	-	V

Swivel angle sensor

		28	55	80	107	140	160	200	250	355	500	1000	
17	Without swivel angle sensor	●	●	●	●	●	●	●	●	●	●	-	
	Optical swivel angle sensor	-	-	-	-	-	-	-	-	●	●	●	V
	Electric swivel angle sensor	-	-	-	-	-	-	-	-	●	●	●	E

Connector for solenoids

		28 to 200	250 to 1000	
18	Without connector (without solenoid, with hydraulic control only) (sizes 250 to 1000)	●	-	O
	DEUTSCH molded connector, 2-pin-without suppressor diode	●	-	P
	HIRSCHMANN connector-without suppressor diode	-	●	

Beginning of control

		28	55	80	107	140	160	200	250	355	500	1000	
19	At $V_{g\ min}$ (standard for HA)	●	●	●	●	●	●	●	●	●	●	●	A
	At $V_{g\ max}$ (standard for HD, HZ, EP, EZ, DA)	●	●	●	●	●	●	●	●	●	●	●	B

Standard / special version

20	Standard version	
	Standard version with installation variants, e.g. T ports open and closed contrary to standard	-Y
	Special version	-S

● = Available ○ = On request ▲ = Not for new projects - = Not available

Notice

- In addition to the type code, please specify the relevant technical data when placing your order.

8) Please contact us.

9) Specify type code separately for sensor in accordance with data sheet 95132-DSM or 95133-DSA, 95135-HDD and observe the requirements for the electronics.



A6VM Series 63 | Axial piston variable motor Type code

PRANCE HYDRAULIC

Technical data

Size	NG	28	55	80	107	140	160		
Geometric displacement, per revolution ¹⁾	$V_{g\max}$	cm ³	28.1	54.8	80	107	140	160	
	$V_{g\min}$	cm ³	0	0	0	0	0	0	
	V_{gx}	cm ³	18	35	51	68	88	61	
Maximum rotational speed ²⁾ (while adhering to the maximum permissible inlet flow)	at $V_{g\max}$	n_{nom}	rpm	5550	4450	3900	3550	3250	3100
	at $V_g < V_{gx}$	n_{max}	rpm	8750	7000	6150	5600	5150	4900
Inlet flow ³⁾	where V_{g0}	n_{max}	rpm	10450	8350	7350	6300	5750	5500
	at n_{nom} and $V_{g\max}$	$q_{v\max}$	l/min	156	244	312	380	455	496
Torque ⁴⁾	at $V_{g\max}$ and $\Delta p = 400\text{bar}$	T	Nm	179	349	509	681	891	1019
	at $V_{g\max}$ and $\Delta p = 350\text{bar}$	T	Nm	157	305	446	596	778	891
Rotary stiffness	$V_{g\max}$ to $V_{g/2}$	c_{min}	kNm/rad	6	10	16	21	34	35
	$V_{g/2}$ to 0 (interpolated)	c_{min}	kNm/rad	18	32	48	65	93	105
Moment of inertia for rotary group	JTW	kgm ²	0.0014	0.0042	0.008	0.127	0.0207	0.0253	
Maximum angular acceleration	α	rad/s ²	47000	31500	24000	19000	11000	11000	
Case volume	V	l	0.5	0.75	1.2	1.5	1.8	2.4	
Weight approx.	m	kg	16	28	36	46	61	62	
Size	NG		200	250	355	500	1000		
Geometric displacement, per revolution ¹⁾	$V_{g\max}$	cm ³	200	250	355	500	1000		
	$V_{g\min}$	cm ³	0	0	0	0	0		
	V_{gx}	cm ³	76	205	300	417	1000		
Maximum rotational speed ²⁾ (while adhering to the maximum permissible inlet flow)	at $V_{g\max}$	n_{nom}	rpm	2900	2700	2240	2000	1600	
	at $V_g < V_{gx}$	n_{max}	rpm	4600	3300	2650	2400	1600	
Inlet flow ³⁾	where V_{g0}	n_{max}	rpm	5100	3300	2650	2400	1600	
	at n_{nom} and $V_{g\max}$	$q_{v\max}$	l/min	580	675	795	1000	1600	
Torque ⁴⁾	at $V_{g\max}$ and $\Delta p = 400\text{ bar}$	T	Nm	1273	-	-	-	-	
	at $V_{g\max}$ and $\Delta p = 350\text{ bar}$	T	Nm	1114	1391	1978	2785	5571	
Rotary stiffness	$V_{g\max}$ to $V_g/2$	c_{min}	kNm/rad	44	60	75	115	281	
	$V_g/2$ to 0 (interpolated)	c_{min}	kNm/rad	130	181	262	391	820	
Moment of inertia for rotary group	JTW	kgm ²	0.0353	0.061	0.102	0.178	0.55		
Maximum angular acceleration	α	rad/s ²	11000	10000	8300	5500	4000		
Case volume	V	l	2.7	3.00	5.0	7.0	16.0		
Weight approx.	m	kg	78	100	170	210	430		

Speed range

The minimum rotational speed n_{min} is not restricted. Please consult us regarding applications requiring uniformity of the rotatory motion at low speeds.

- The minimum and maximum displacement can be steplessly adjusted, (standard setting for sizes 250 to 1000 if ordering code is missing, $V_{g\min} = 0.2 \times V_{g\max}$, $V_{g\max} = V_{g\max}$)
- The values are applicable:
 - for the optimum viscosity range from $V_{opt} = 36$ to $16\text{ mm}^2/\text{s}$
 - with hydraulic fluid based on mineral oils
- Observe limitation of displacement due to counterbalance valve
- Torque without radial force, with radial force.

Notice

- Theoretical values, without efficiency and tolerances; values rounded

Operation above the maximum values or below the minimum values may result in a loss of function, a reduced service life or in the destruction of the axial piston unit. Other permissible limit values, such as speed variation, reduced angular acceleration as a function of the frequency and the permissible angular acceleration at start (lower than the maximum angular acceleration) can be found in data sheet 90261.



PRANCE HYDRAULIC

Axial piston variable motor | A6VM Series 63 Type code

Technical data

Permissible displacement in relation to rotational speed

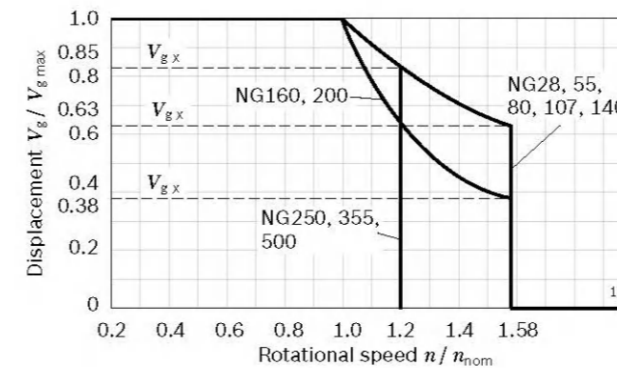

Determining the operating characteristics

Inlet flow	$q_v = \frac{V_g \times n}{1000 \times \eta_v}$	[l/min]
Rotational speed	$n = \frac{q_v \times 1000 \times \eta_v}{V_g}$	[rpm]
Torque	$T = \frac{V_g \times \Delta p \times \eta_{hm}}{20 \times \pi}$	[Nm]
Power	$P = \frac{2 \pi \times T \times n}{60000} = \frac{q_v \times \Delta p \times \eta_t}{600}$	[kW]

Key

V_g	Displacement per revolution [cm ³]
Δp	Differential pressure [bar]
n	Rotational speed [rpm]
η_v	Volumetric efficiency
η_{hm}	Hydraulic-mechanical efficiency
η_t	Total efficiency ($\eta_t = \eta_v \times \eta_{hm}$)

EP1, EP2 - Proportional control, electric

Port plate 2- SAE working ports A and B lateral, opposing

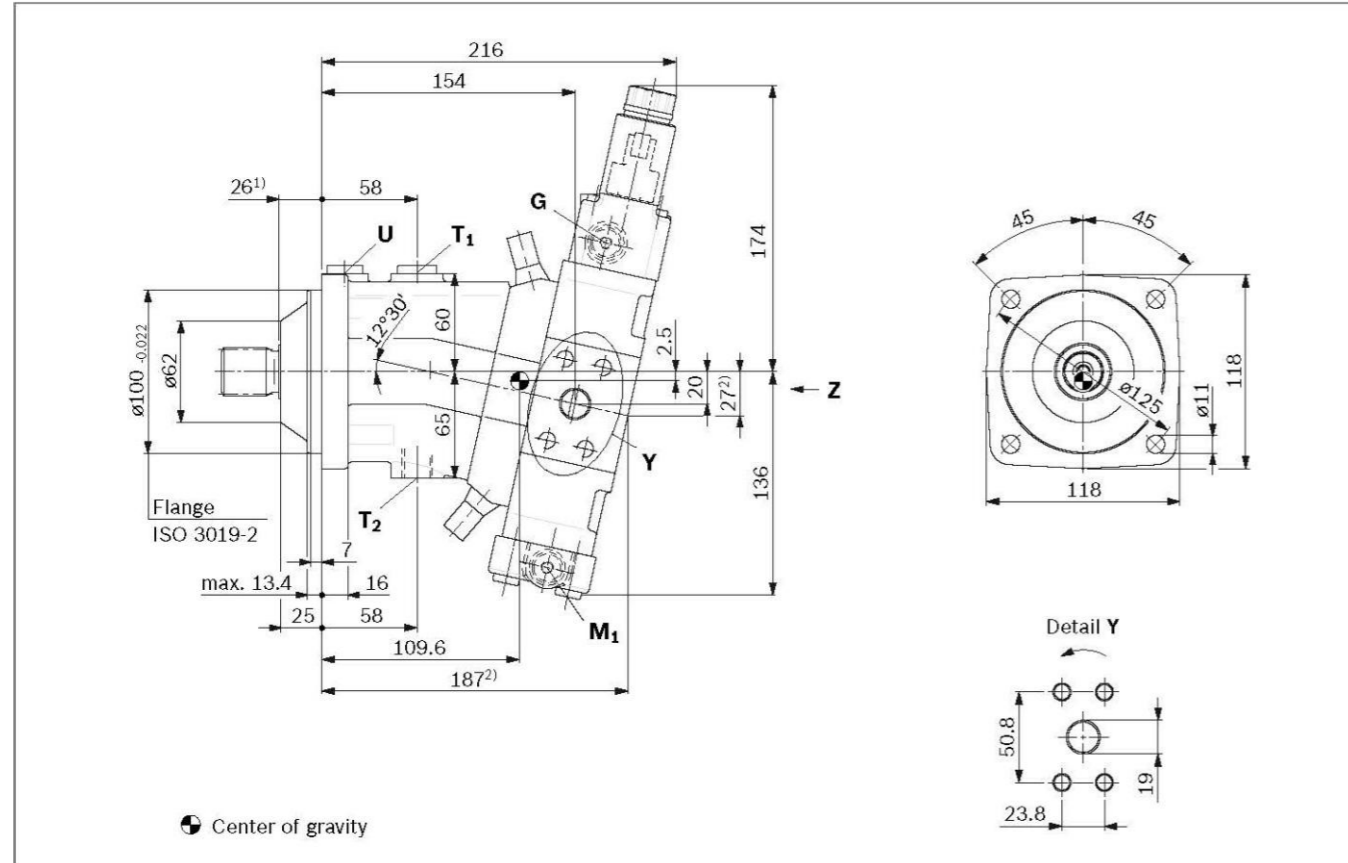

Ports	Standard	Size ³⁾	p_{max} [bar] ₄₎	State ⁶⁾
A, B	Working port Fastening thread	SAE J518 ⁵⁾ DIN 13	3/4 in M10 x 1.5; 17 deep	450 O
T ₁	Drain port	DIN 3852 ⁷⁾	M18 x 1.5; 12 deep	3 X ⁸⁾
T ₂	Drain port	DIN 3852 ⁷⁾	M18 x 1.5; 12 deep	3 O ⁸⁾
G	Synchronous control	DIN 3852 ⁷⁾	M14 x 1.5; 12 deep	450 X
G ₂	2nd pressure setting (HD.E, EP.E)	DIN 3852 ⁷⁾	M14 x 1.5; 12 deep	100 X
U	Bearing flushing	DIN 3852 ⁷⁾	M16 x 1.5; 12 deep	3 X
X	Pilot signal (HD, HZ, HA1T/HA2T)	DIN 3852 ⁷⁾	M14 x 1.5; 12 deep	100 O
X	Pilot signal (HA1, HA2)	DIN 3852 ⁷⁾	M14 x 1.5; 12 deep	3 X
X ₁ , X ₂	Pilot signal (DA1, DA4)	DIN 2353-CL	8B-ST	40 O
X ₁	Pilot signal (DA2, DA3, DA5, DA6)	DIN 3852 ⁷⁾	M14 x 1.5; 12 deep	40 O
X ₃	Pilot signal (DA2, DA3, DA5, DA6)	DIN 3852 ⁷⁾	M14 x 1.5; 12 deep	40 X
M ₁	Stroke chamber measurement	DIN 3852 ⁷⁾	M14 x 1.5; 12 deep	450 X

1) To shaft collar

2) Port plate 1- SAE working ports A and B at rear

3) For notes on tightening torques, see the instruction manual

4) Depending on the application, momentary pressure peaks can occur.

Keep this in mind when selecting measuring devices and fittings.

5) Only dimensions according to SAE J518, metric fastening thread is a deviation from the standard

6) Depending on installation position, T₁ or T₂ must be connected.

7) The countersink can be deeper than as specified in the standard.

8) O= Must be connected (plugged when delivered)

X= Plugged (in normal operation)

▼ Location of the working ports on the port plates (view Z)

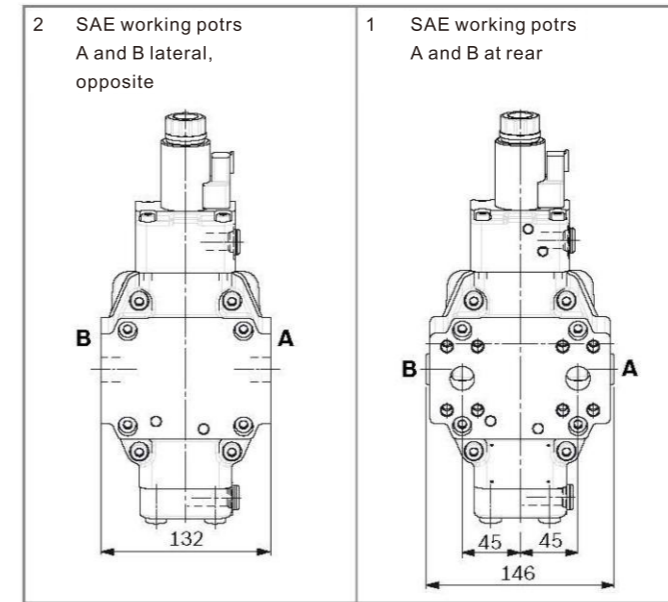

▼ Splined shaft DIN 5480

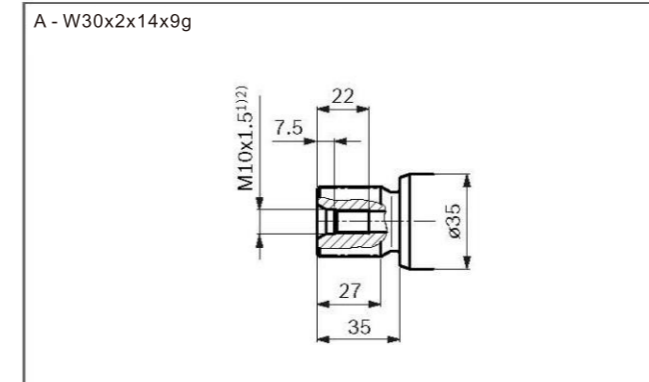

▼ Splined shaft DIN 5480

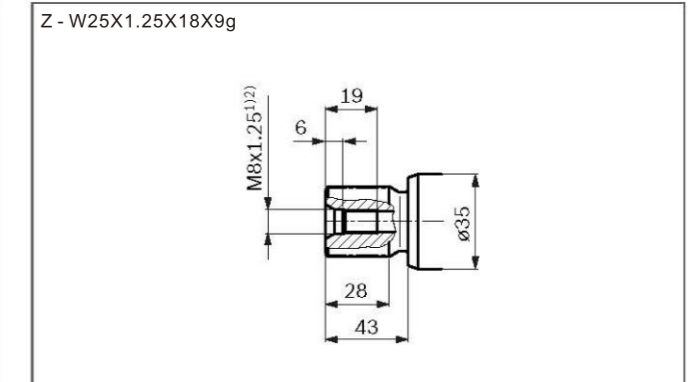

1) For notes on tightening torques, see the instruction manual
2) Center bore according to DIN 332 (thread according to DIN 13)

▼ EP.D - Proportional control, electric,
with pressure control fixed setting

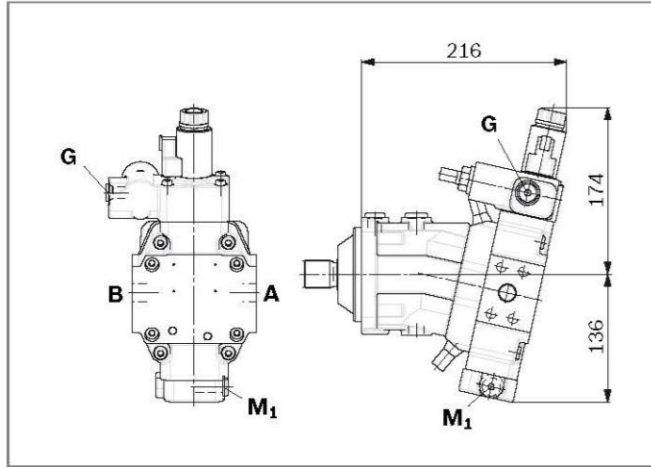

▼ EP.E - Proportional control, electric,
with pressure control hydraulic override, two-point

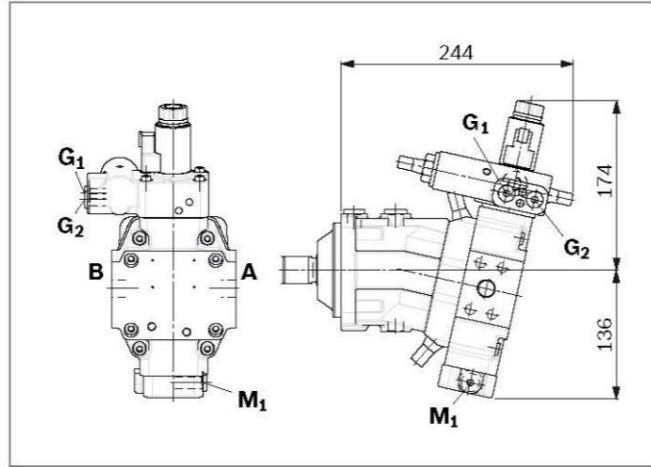

▼ HD1, HD2 - Proportional control, hydraulic

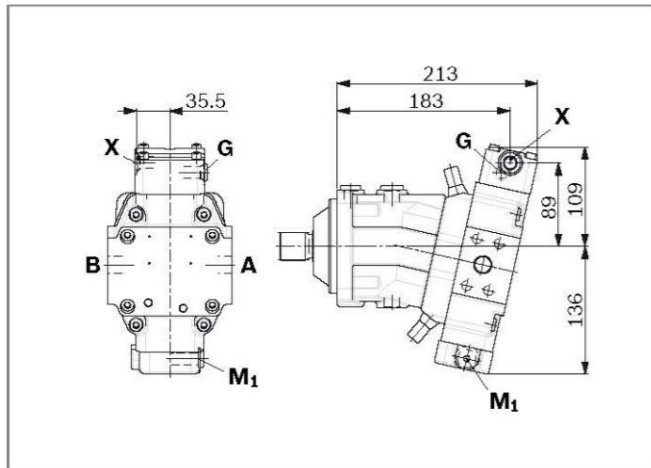

▼ HD.D - Proportional control, hydraulic,
with pressure control fixed setting

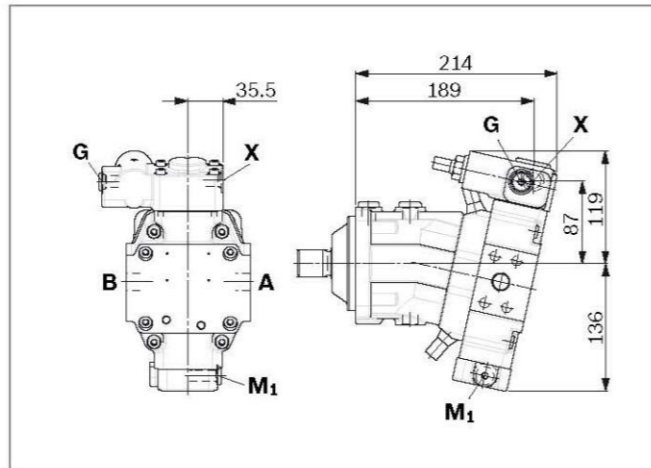

▼ HD.E - Proportional control, hydraulic,
with pressure control hydraulic override, two-point

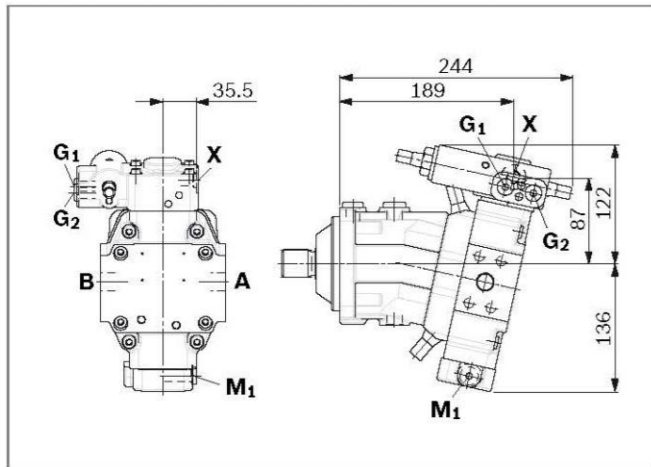

▼ HZ1 - Two-point control, hydraulic

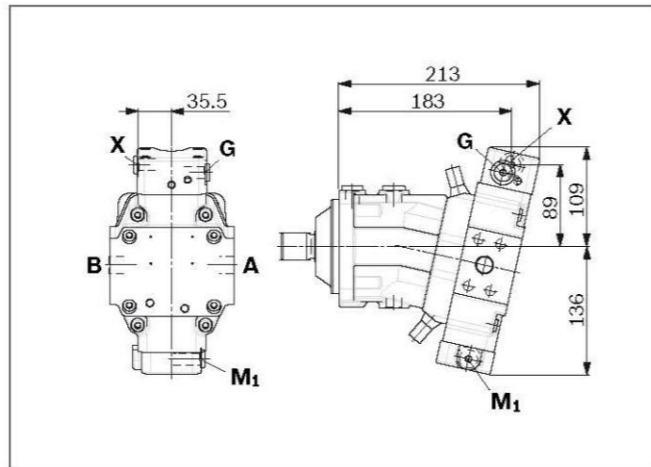

▼ EZ1, EZ2 - Two-point control, electric

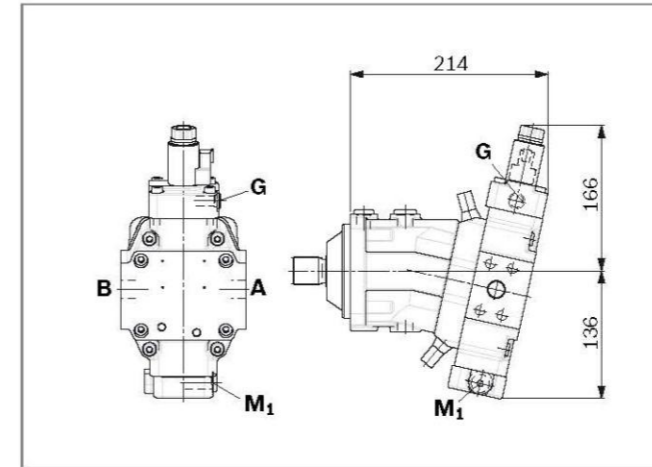

▼ HA1, HA2 / HA1T, HA2T - Automatic high-pressure related
control, with override, hydraulic remote control, proportional

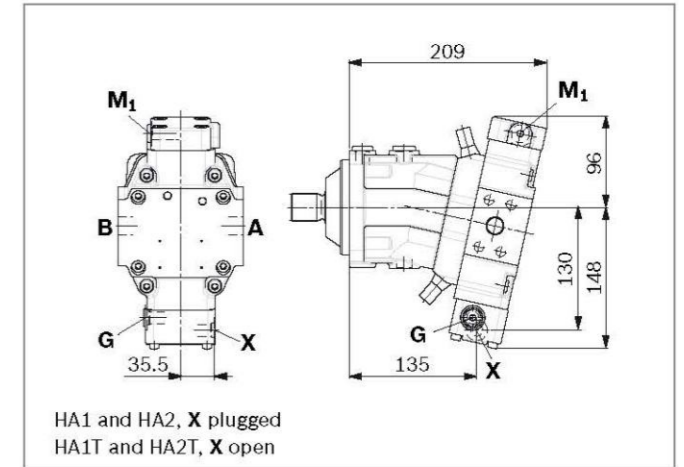

▼ HA1U1, HA2U2 - Automatic high-pressure related control,
with electric override, two-point

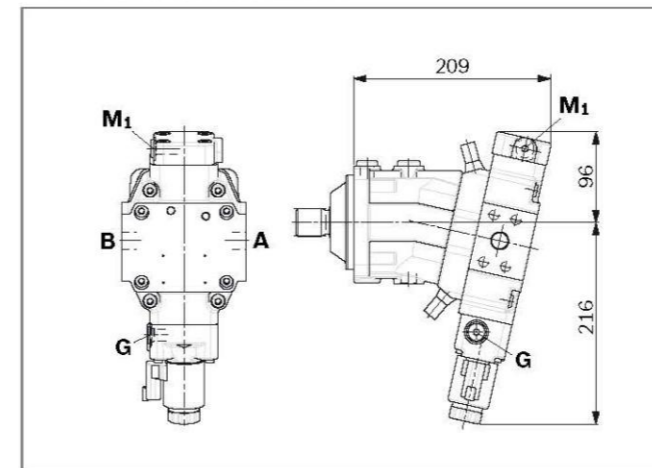

▼ HA1R1, HA2R2 - Automatic high-pressure related control,
with electric override and electric travel direction valve

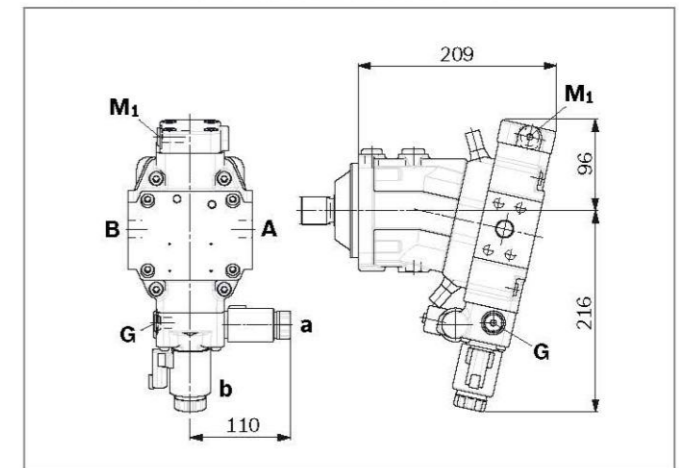

▼ DA1 DA4 - Automatic speed related control, with hydraulic travel
direction valve

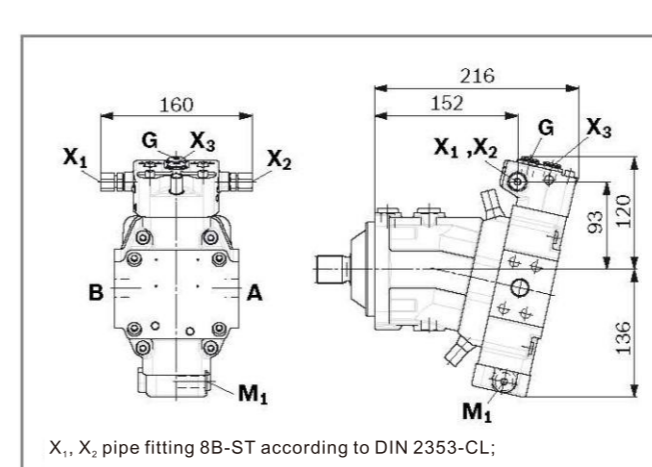

X₁, X₂ pipe fitting 8B-ST according to DIN 2353-CL;
use installed fittings!

▼ DA2, DA3, DA5, DA6 - Automatic speed related control,
with electric travel direction valve and electric
V_{gmax}-circuit

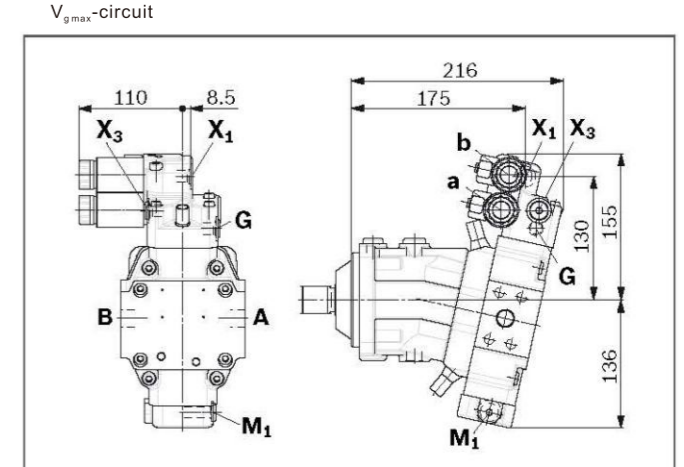

EP1, EP2 - Proportional control, electric

Port plate 2 - SAE working ports A and B lateral, opposing

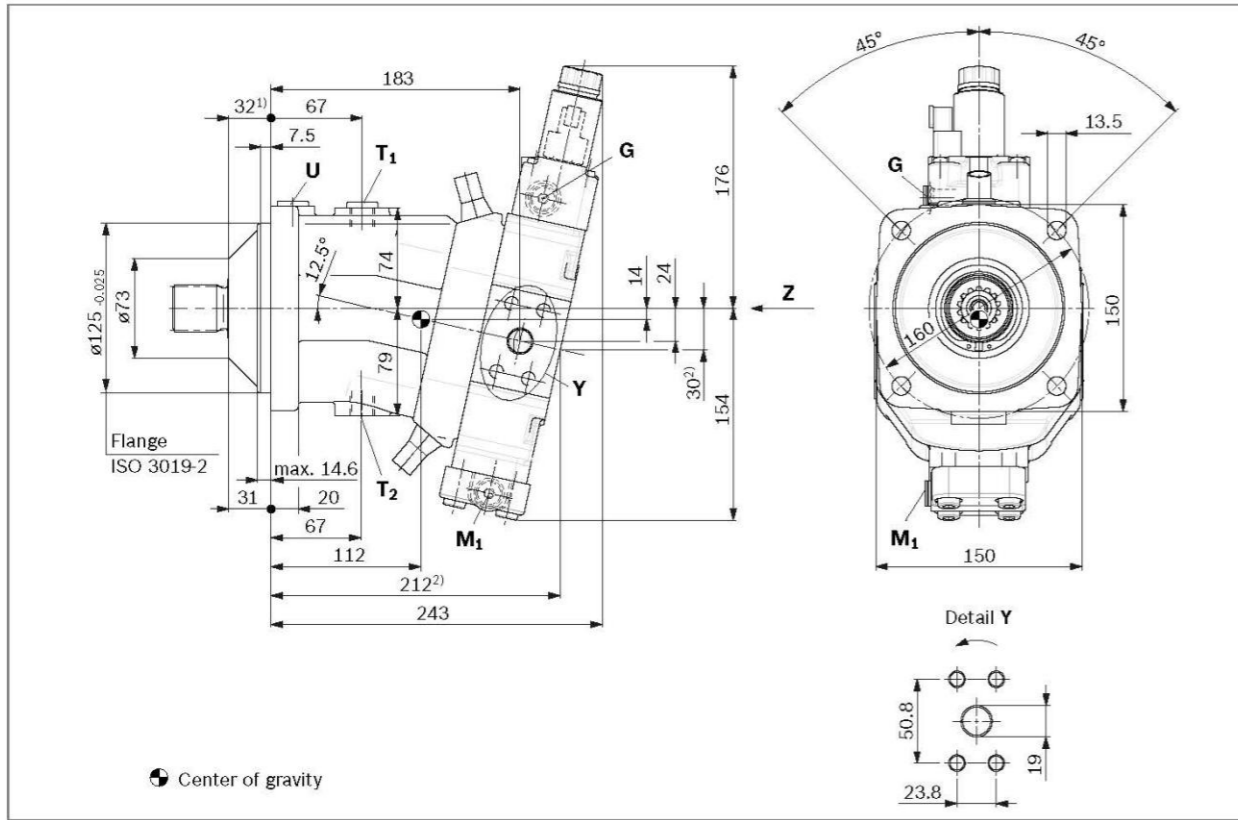

Ports	Standard	Size ³⁾	p_{max} [bar] ⁴⁾	State ⁸⁾
A, B	Working port Fastening thread A/B	SAE J518 ⁵⁾ DIN 13	3/4 in M10 x 1.5; 17 deep	450 O
T ₁	Drain port	DIN 3852 ⁶⁾	M18 x 1.5; 12 deep	3 X ⁷⁾
T ₂	Drain port	DIN 3852 ⁶⁾	M18 x 1.5; 12 deep	3 O ⁷⁾
G	Synchronous control	DIN 3852 ⁶⁾	M14 x 1.5; 12 deep	450 X
G ₂	2nd pressure setting (HD.E, EP.E)	DIN 3852 ⁶⁾	M14 x 1.5; 12 deep	100 X
U	Bearing flushing	DIN 3852 ⁶⁾	M18 x 1.5; 12 deep	3 X
X	Pilot signal (HP, HZ, HA1T/HA2T)	DIN 3852 ⁶⁾	M14 x 1.5; 12 deep	100 O
X	Pilot signal (HA1, HA2)	DIN 3852 ⁶⁾	M14 x 1.5; 12 deep	3 X
X ₁ , X ₂	Pilot signal (DA1, DA4)	DIN 2353-CL	8B-ST	40 O
X ₁	Pilot signal (DA2, DA3, DA5, DA6)	DIN 3852 ⁶⁾	M14 x 1.5; 12 deep	40 O
X ₃	Pilot signal (DA2, DA3, DA5, DA6)	DIN 3852 ⁶⁾	M14 x 1.5; 12 deep	40 X
M ₁	Stroking chamber measurement	DIN 3852 ⁶⁾	M14 x 1.5; 12 deep	450 X

- To shaft collar
- Port plate 1 - SAE working ports A and B at rear
- For notes on tightening torques, see the instruction manual
- Depending on the application momentary pressure peaks can occur.
Keep this in mind when selecting measuring devices and fittings.
- Only dimensions according to SAE J518, metric fastening thread is a deviation from the standard

- Depending on installation position, T₁ or T₂ must be connected.
- The countersink can be deeper than as specified in the standard.
- O = Must be connected (plugged when delivered)
X = Plugged (in normal operation)

▼ Location of the working ports on the port plates (view Z)

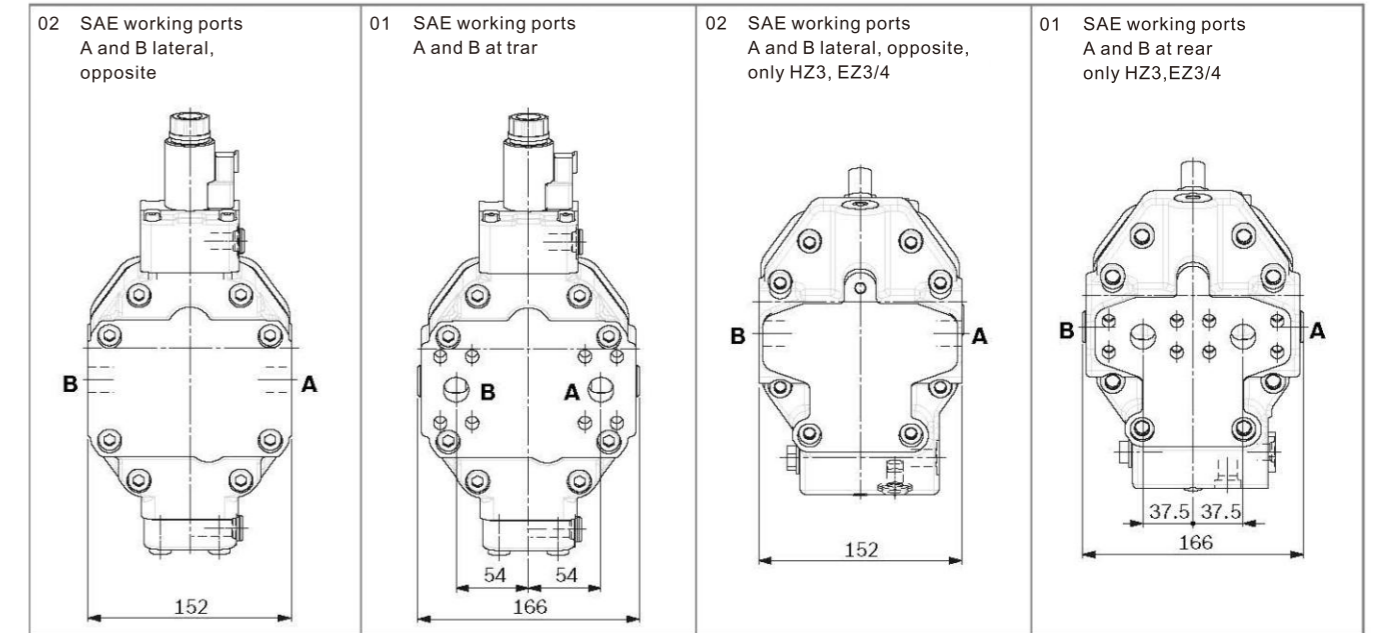

▼ Splined shaft DIN 5480

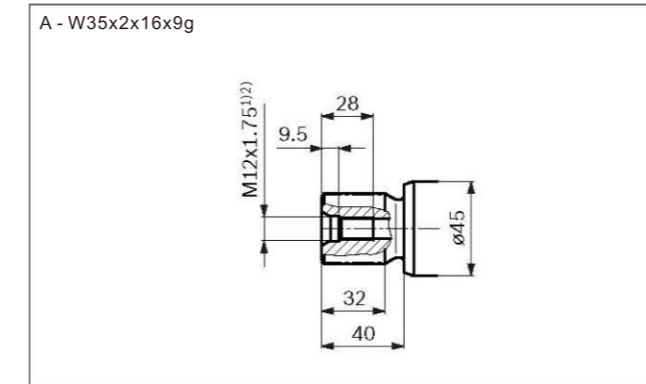

▼ Splined shaft DIN 5480

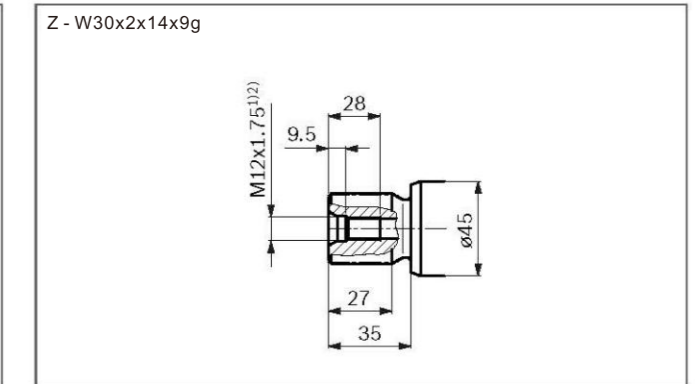

- For notes on tightening torques, see the instruction manual
- Center bore according to DIN 332 (thread according to DIN 13)

▼ EP.D - Proportional control, electric,
with pressure control fixed setting

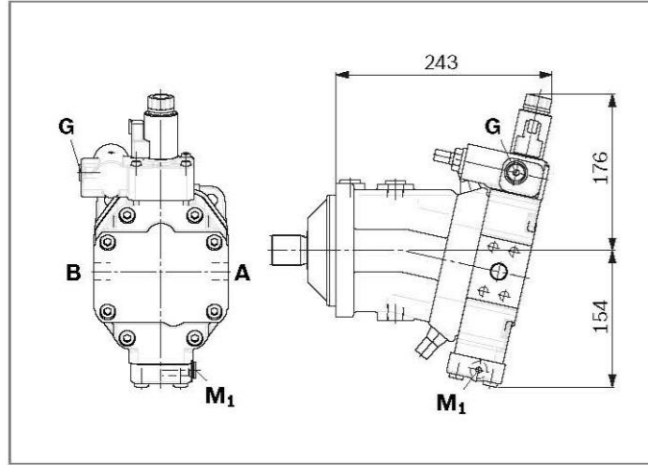

▼ EP.E - Proportional control, electric,
with pressure control hydraulic override, two-point

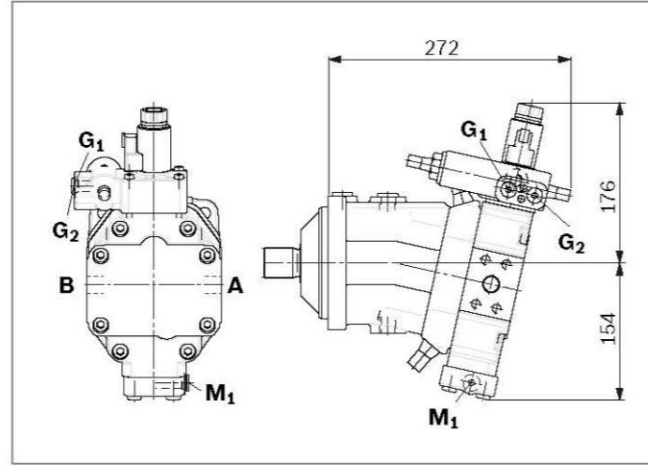

▼ HD1, HD2 - Proportional control, hydraulic

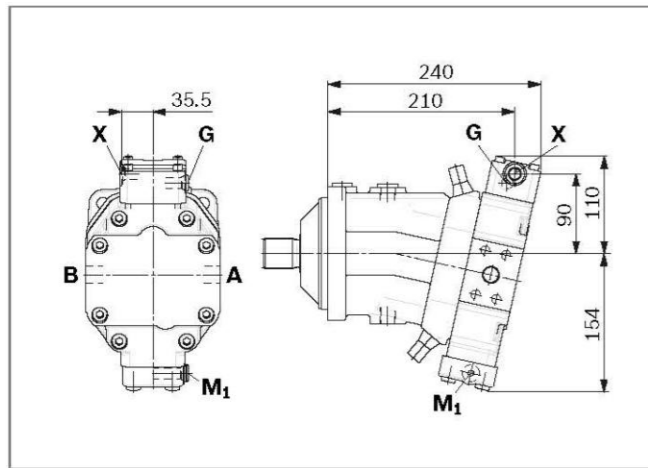

▼ HD.D - Proportional control, hydraulic,
with pressure control fixed setting

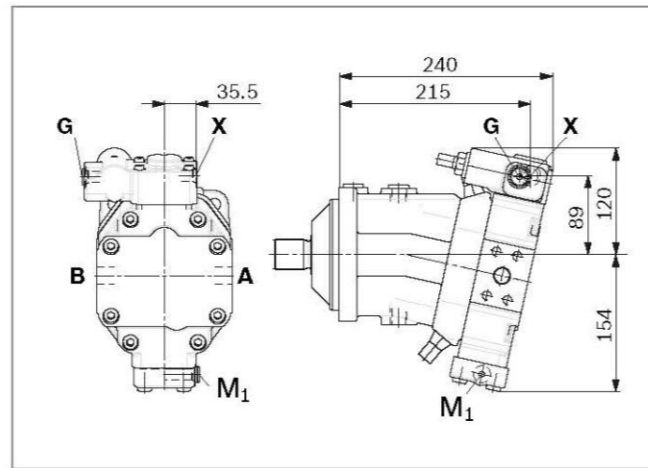

▼ HD.E - Proportional control, hydraulic,
with pressure control hydraulic override, two-point

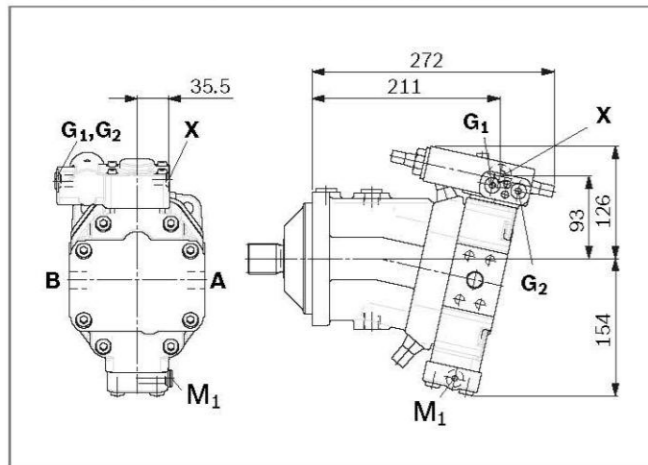

▼ HZ3 - Two-point control, hydraulic

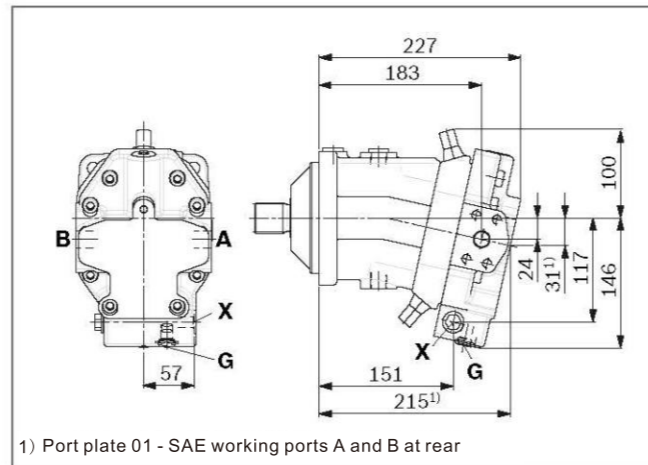

1) Port plate 01 - SAE working ports A and B at rear

▼ EZ3, EZ4 - Two -point control, electric

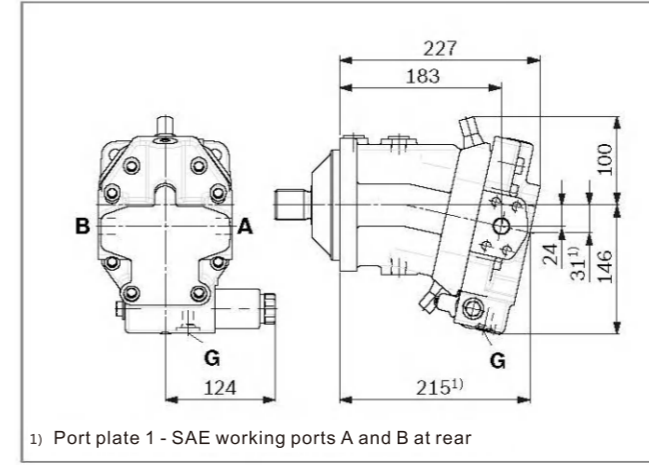

1) Port plate 1 - SAE working ports A and B at rear

▼ HA1U1, HA2U2 - Automatic high-pressure related control,
with electric override, two-point

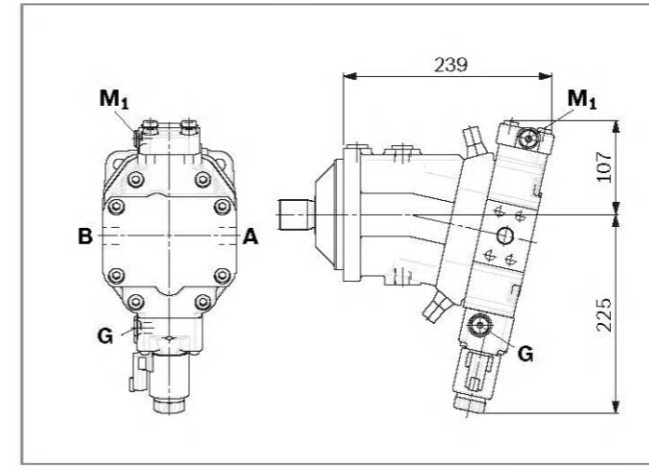

▼ DA1, DA4 - Automatic speed related control, with
hydraulic travel direction valve

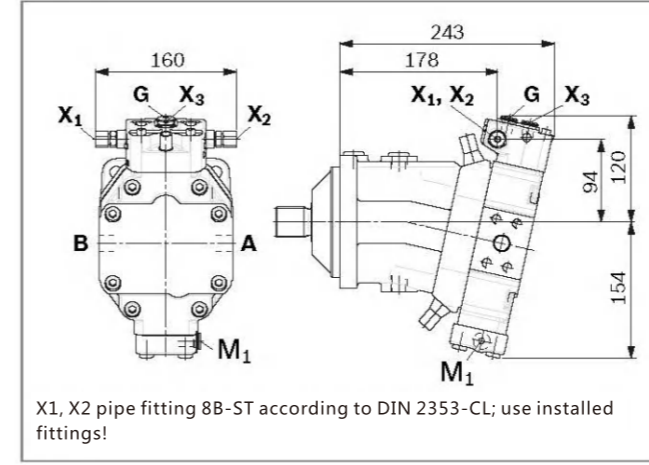

X1, X2 pipe fitting 8B-ST according to DIN 2353-CL; use installed fittings!

▼ HA1, HA2 / HA1T, HA2T - Automatic high-pressure related
control, with override, hydraulic remote control, proportional

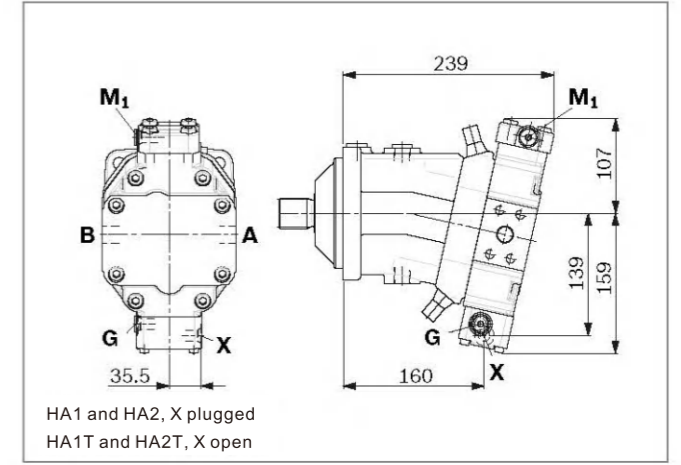

HA1 and HA2, X plugged
HA1T and HA2T, X open

HA1R1, HA2R2 - Automatic high-pressure related control,
with electric override and electric travel direction valve

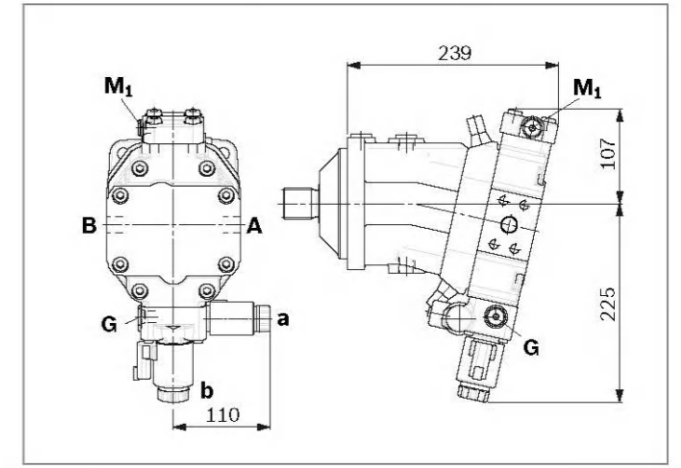

▼ DA2, DA3, DA5, DA6 - Automatic speed related control,
with electric direction valve and V_{gmax} -circuit

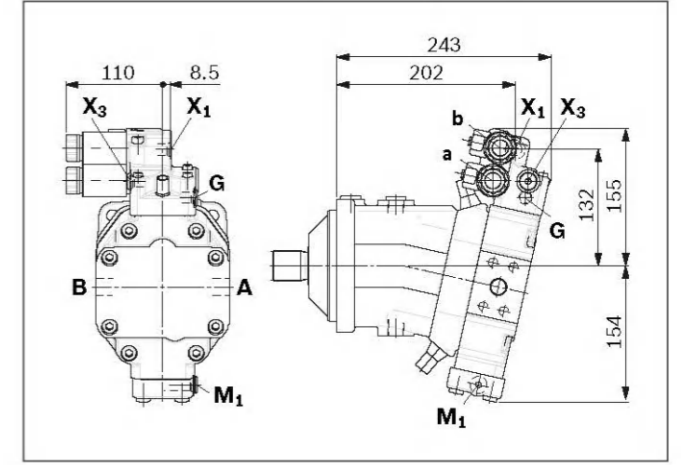

EP1, EP2 - Proportional control, electric

Port plate 2 - SAE working ports A and B lateral, opposing

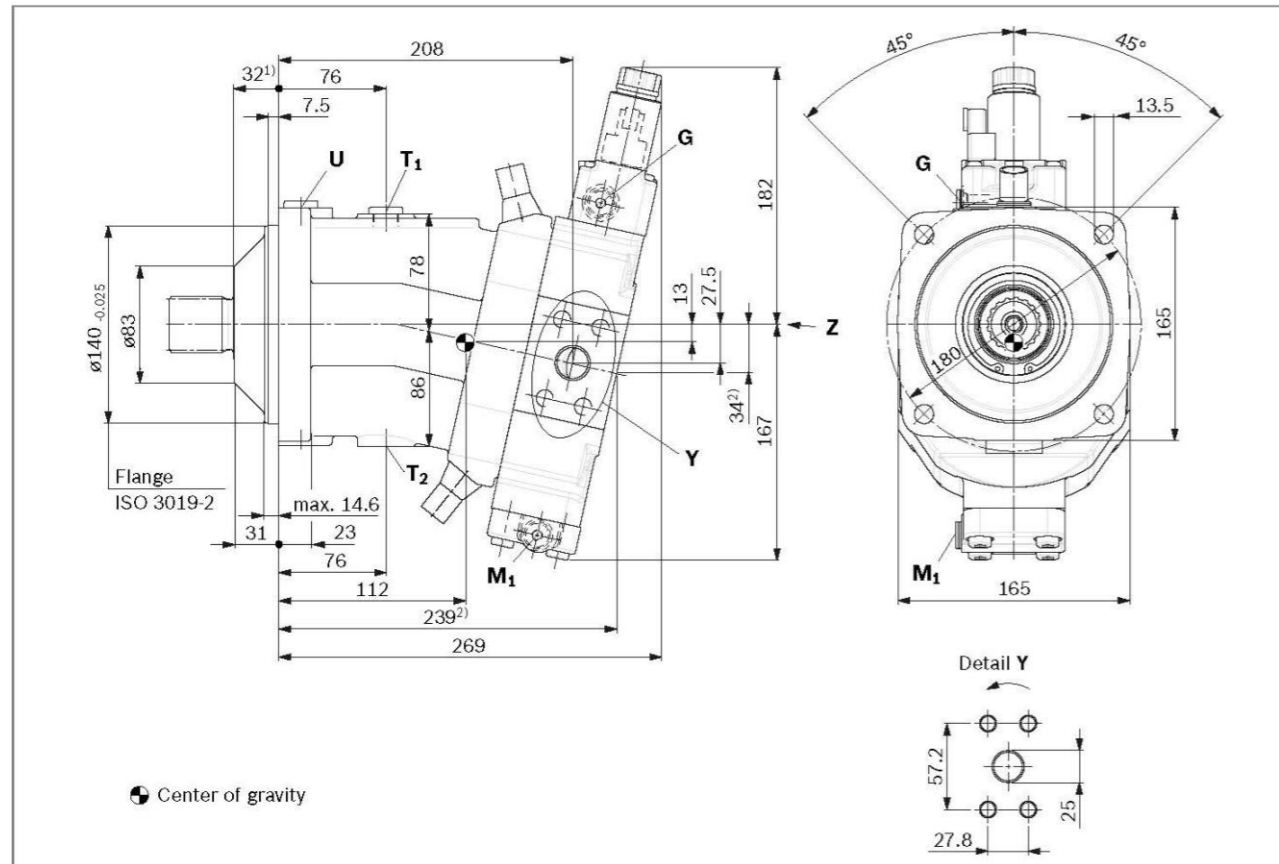

Ports	Standard	Size ³⁾	p _{max} [bar] ⁴⁾	State ⁵⁾
A, B	Working port Fastening thread A/B	SAE J518 ⁶⁾ DIN 13	1 in M12 x 1.75; 17 deep	450 O
T ₁	Drain port	DIN 3852 ⁷⁾	M18 x 1.5; 12 deep	3 X ⁸⁾
T ₂	Drain port	DIN 3852 ⁷⁾	M18 x 1.5; 12 deep	3 O ⁸⁾
G	Synchronous control	DIN 3852 ⁷⁾	M14 x 1.5; 12 deep	450 X
G ₂	2nd pressure setting (HD.E.EP.E)	DIN 3852 ⁷⁾	M14 x 1.5; 12 deep	100 X
U	Bearing flushing	DIN 3852 ⁷⁾	M18 x 1.5; 12 deep	3 X
X	Pilot signal (HP, HZ, HA1T/HA2T)	DIN 3852 ⁷⁾	M14 x 1.5; 12 deep	100 O
X	Pilot signal (HA1, HA2)	DIN 3852 ⁷⁾	M14 x 1.5; 12 deep	3 X
X ₁ , X ₂	Pilot signal (DA1, DA4)	DIN 2353-CL	8B-ST	40 O
X ₁	Pilot signal (DA2, DA3, DA5, DA6)	DIN 3852 ⁷⁾	M14 x 1.5; 12 deep	40 O
X ₃	Pilot signal (DA2, DA3, DA5, DA6)	DIN 3852 ⁷⁾	M14 x 1.5; 12 deep	40 X
M ₁	Stroking chamber measurement	DIN 3852 ⁷⁾	M14 x 1.5; 12 deep	450 X

1) To shaft collar

2) Port plate 1 - SAE working ports A and B at rear

3) For notes on tightening torque, see the instruction manual

4) Depending on the application, momentary pressure can occur.

Keep this in mind when selecting measuring devices and fittings.

5) Only dimensions according to SAE J518, metric fastening thread is a deviation from the standard

6) Depending on installation position, T1 or T2 must be connected.

7) The countersink can be deeper than as specified in the standard.

8) O = Must be connected (plugged when delivered)

X = Plugged (in normal operation)

▼ Location of the working ports on the port plates (view Z)

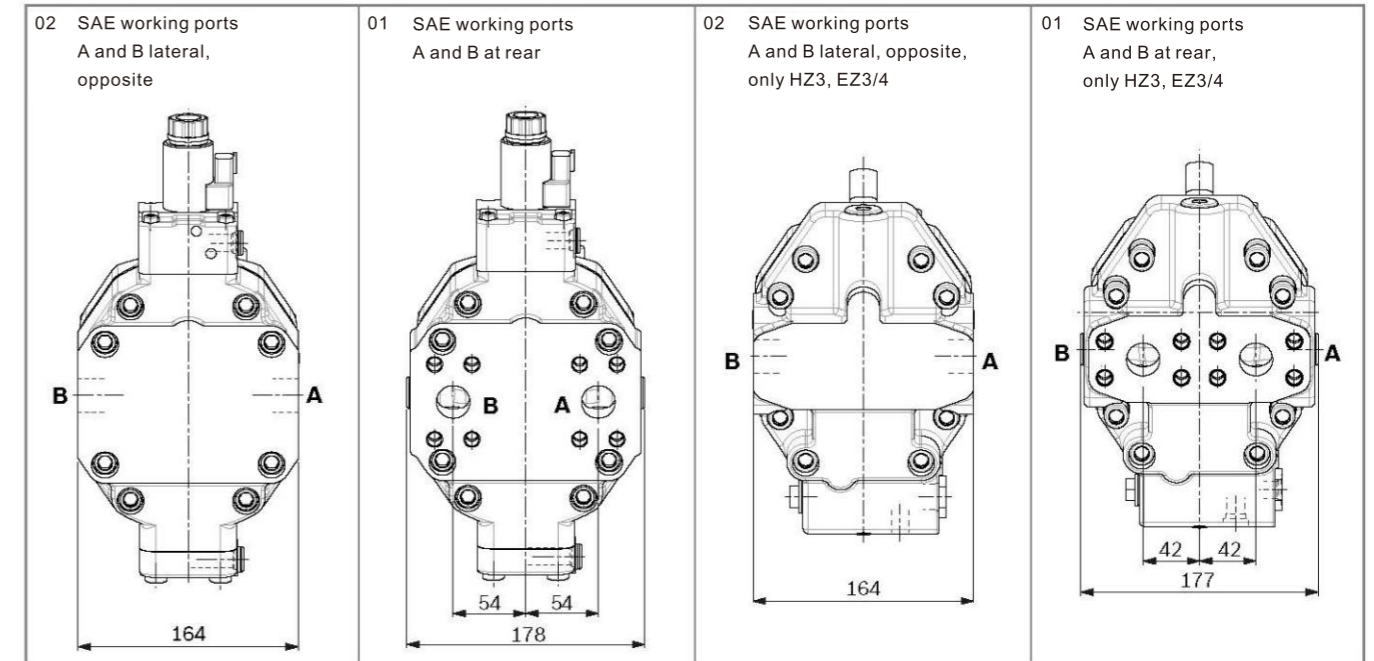

▼ Splined shaft DIN 5480

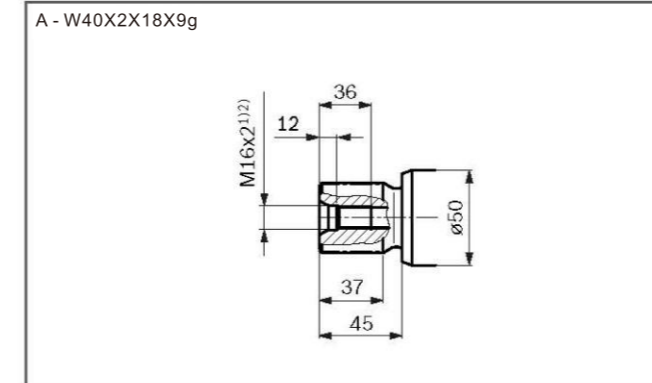

▼ Splined shaft DIN 5480

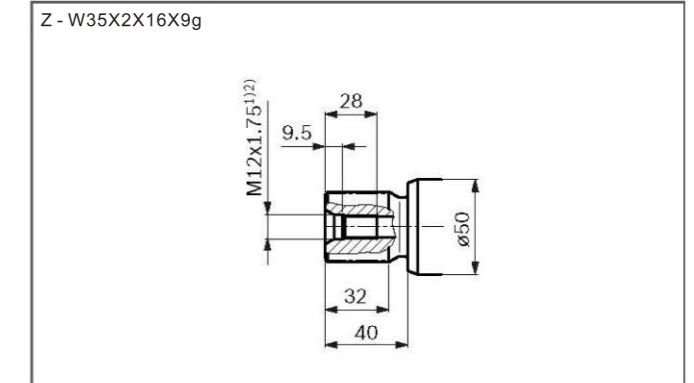

1) For notes on tightening torques, see the instruction manual

2) Center bore according to DIN 332 (thread according to DIN 13)

▼ EP.D - Proportional control, electric,
with pressure control fixed setting

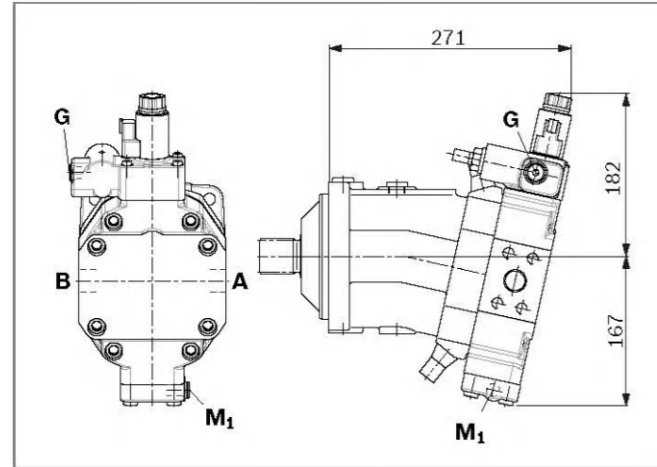

▼ EP.E - Proportional control, electric,
with pressure control hydraulic override, two-point

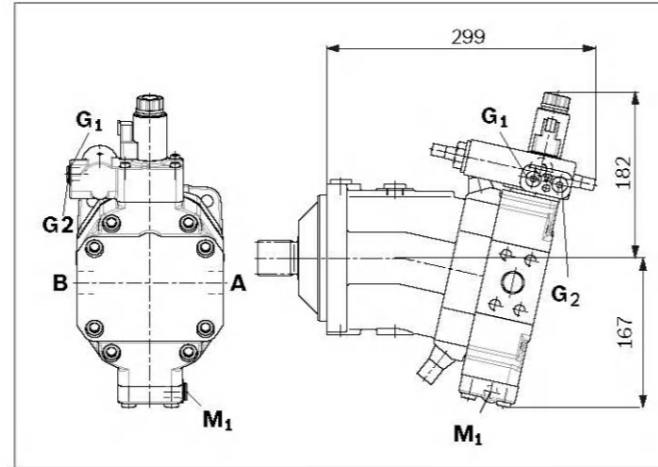

▼ HD1, HD2 - Proportional control, hydraulic

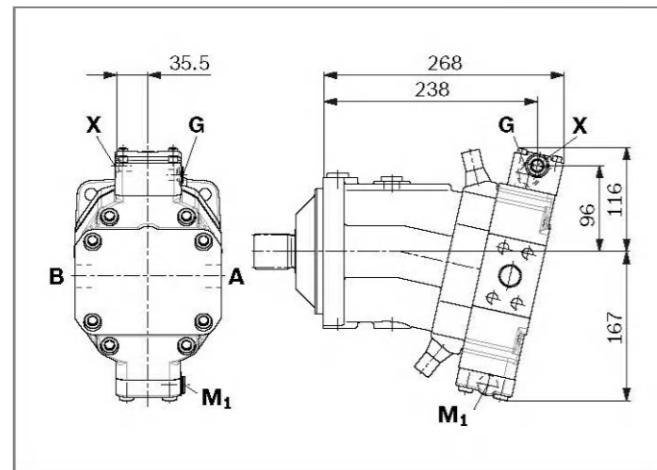

▼ HD.D - Proportional control, hydraulic,
with pressure control fixed setting

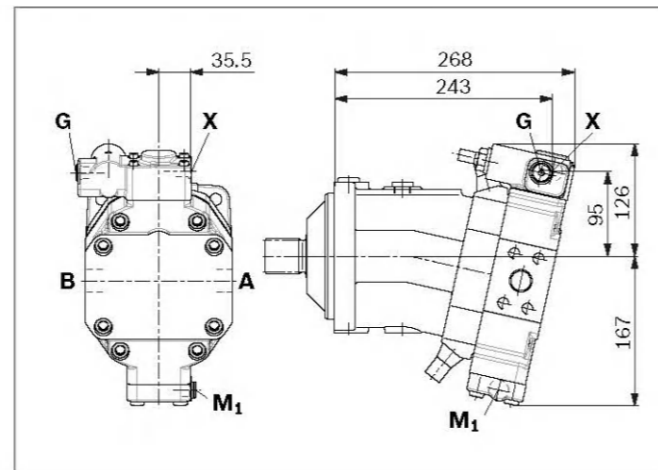

▼ HD.E - Proportional control, hydraulic,
with pressure control hydraulic override, two-point

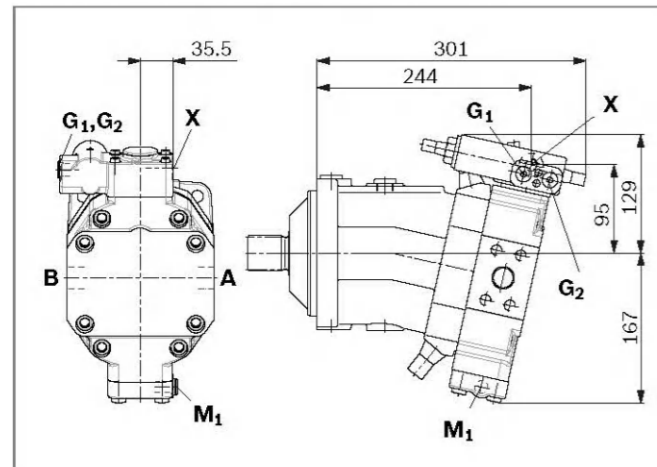

▼ HZ3 - Two-point control, hydraulic

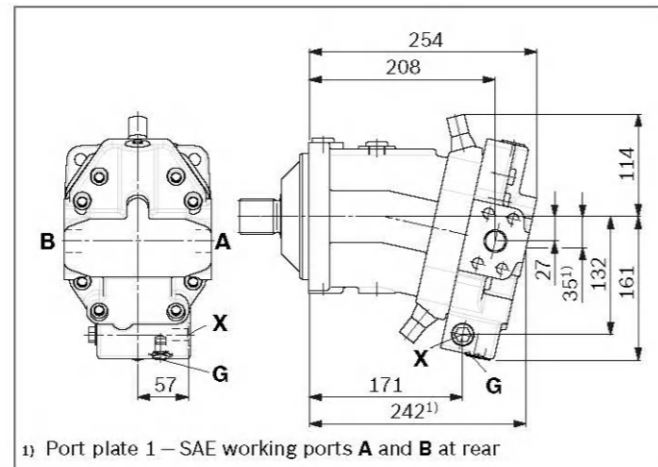

▼ EZ3, EZ4 - Two-point control, electric

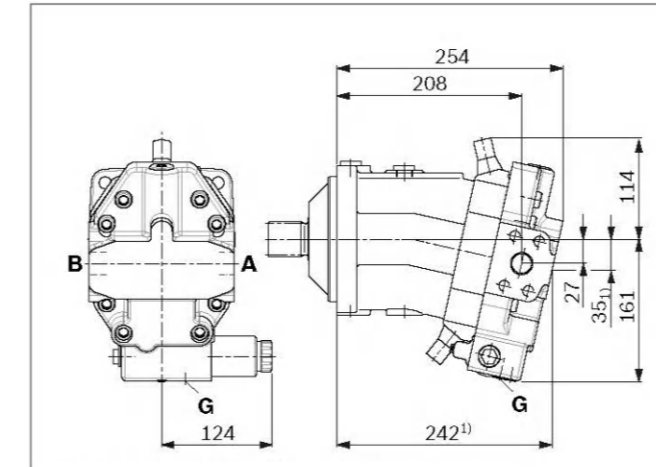

▼ HA1, HA2 / HA1T, HA2T - Automatic high-pressure related
control, with override, hydraulic remote control, proportional

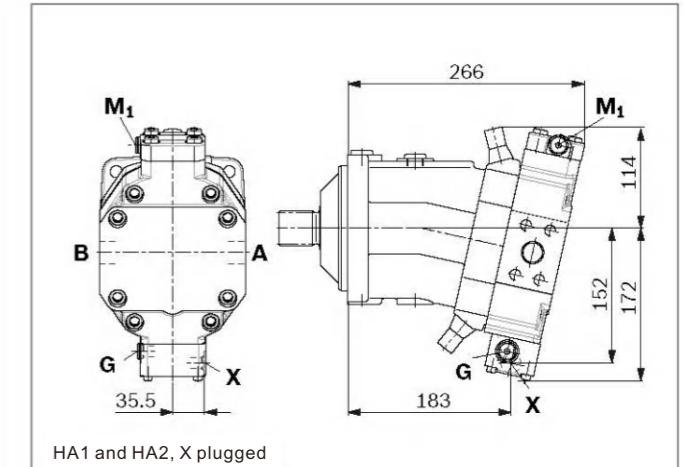

▼ HA1U1, HA2U2 - Automatic high-pressure related control,
with electric override, two-point

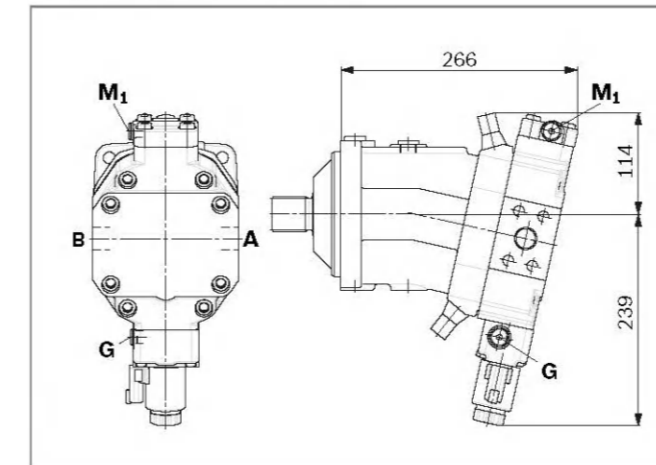

▼ HA1R1, HA2R2 - Automatic high-pressure related control,
with electric override and electric travel direction valve

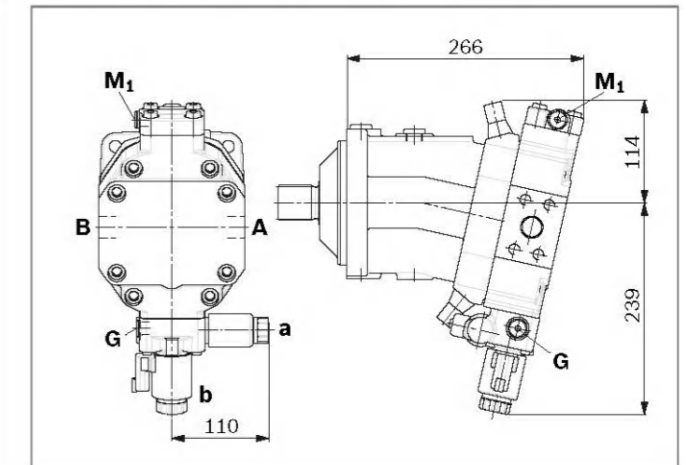

▼ DA1, DA4 - Automatic speed related control,
with hydraulic travel direction valve

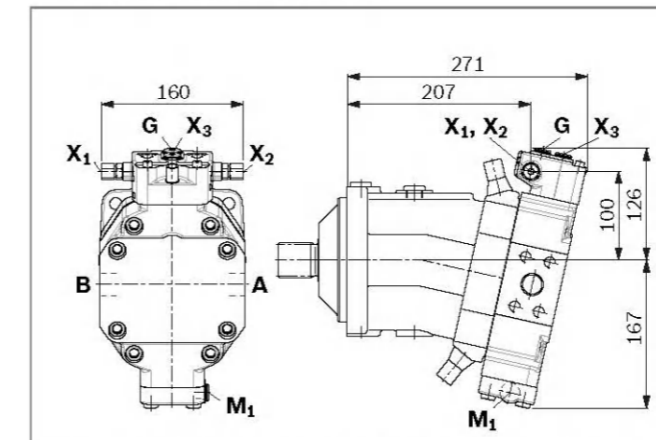

▼ DA2, DA3, DA5, DA6 - Automatic speed related control,
with electric travel direction valve and V_{gmax}-circuit

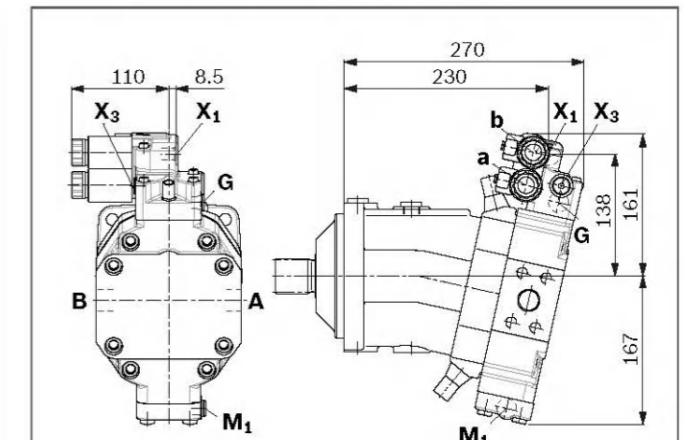

EP1, EP2 - Proportional control, electric
Port plate 2 - SAE working ports A and B lateral, opposing

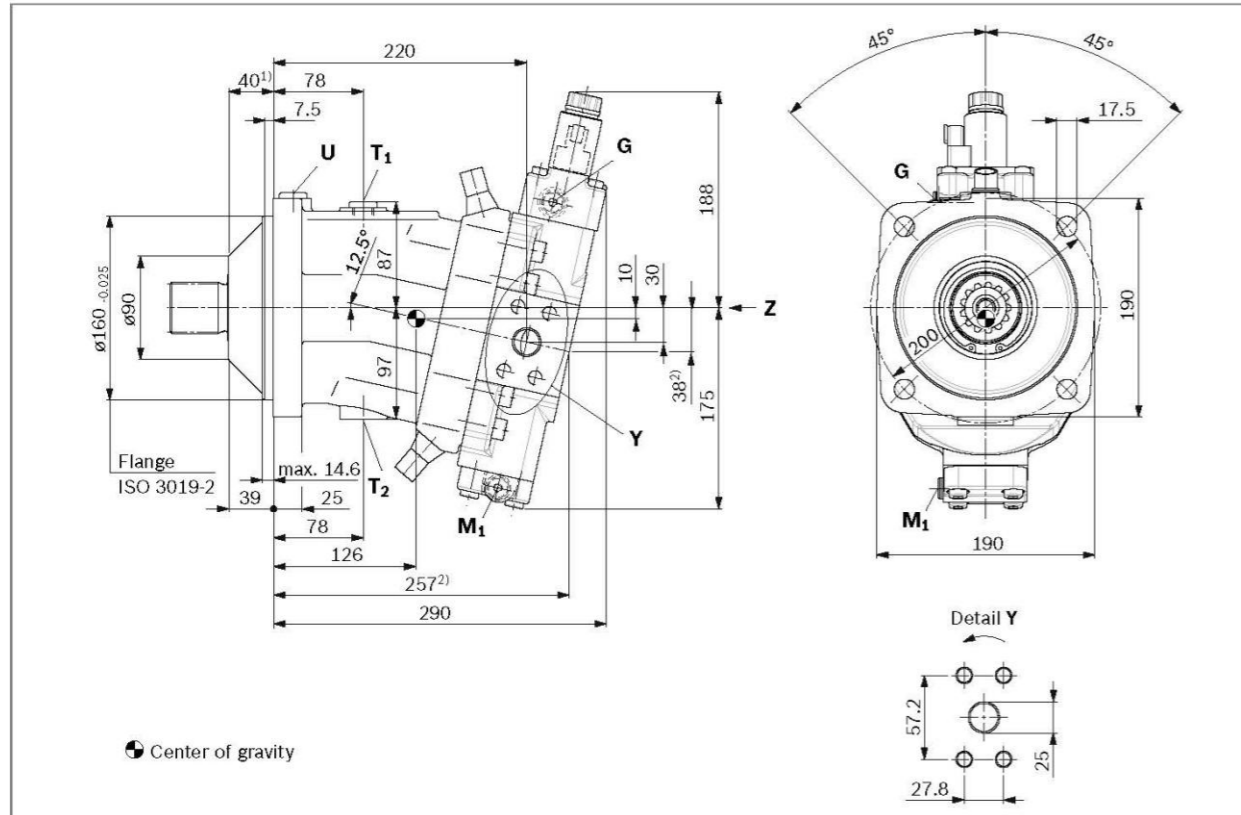

Ports	Standard	Size ³⁾	p_{max} [bar] ⁴⁾	State ⁸⁾
A, B	Working port Fastening thread A/B	SAE J518 ⁵⁾ DIN 13	1 in M12 x 1.75; 17 deep	450 O
T ₁	Drain port	DIN 3852 ⁷⁾	M18 x 1.5; 12 deep	3 X ⁶⁾
T ₂	Drain port	DIN 3852 ⁷⁾	M18 x 1.5; 12 deep	3 O ⁶⁾
G	Synchronous control	DIN 3852 ⁷⁾	M14 x 1.5; 12 deep	450 X
G ₂	2nd pressure setting (HD.E, EP.E)	DIN 3852 ⁷⁾	M14 x 1.5; 12 deep	100 X
U	Bearing flushing	DIN 3852 ⁷⁾	M18 x 1.5; 12 deep	3 X
X	Pilot signal (HP, HZ, HA1T/HA2T)	DIN 3852 ⁷⁾	M14 x 1.5; 12 deep	100 O
X	Pilot signal (HA1, HA2)	DIN 3852 ⁷⁾	M14 x 1.5; 12 deep	3 X
X ₁ , X ₂	Pilot signal (DA1, DA4)	DIN 2353-CL	8B-ST	40 O
X ₁	Pilot signal (DA2, DA3, DA5, DA6)	DIN 3852 ⁷⁾	M14 x 1.5; 12 deep	40 O
X ₃	Pilot signal (DA2, DA3, DA5, DA6)	DIN 3852 ⁷⁾	M14 x 1.5; 12 deep	40 X
M ₁	Stroking chamber measurement	DIN 3852 ⁷⁾	M14 x 1.5; 12 deep	450 X

- 1) To shaft collar
- 2) Port plate 1 - SAE working ports A and B at rear
- 3) For notes on tightening torques, see the instruction manual
- 4) Depending on the application, momentary pressure peaks can occur. Keep this in mind when selecting measuring devices and fittings
- 5) Only dimensions according to SAE J518, metric fastening thread is a deviation from the standard
- 6) Depending on installation position, T₁ or T₂, must be connected.
- 7) The countersink can be deeper than as specified in the standard
- 8) O=Must be connected (plugged when delivered)
X= Plugged (in normal operation)

▼ Location of the working ports on the port plates (view Z)

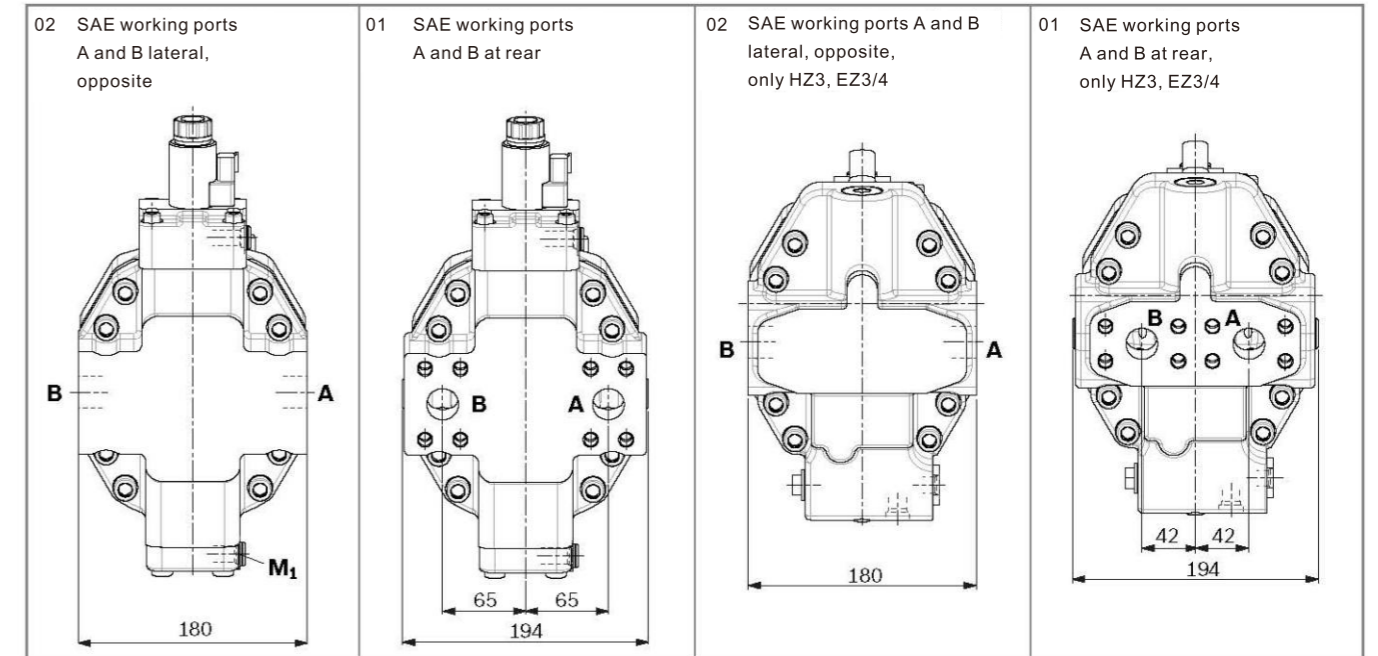

▼ Splined shaft DIN 5480

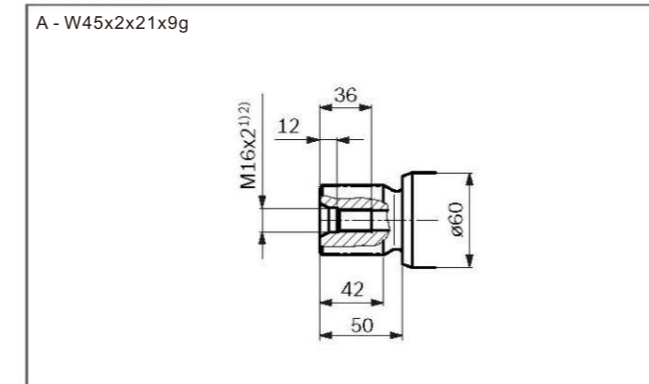

▼ Splined shaft DIN 5480

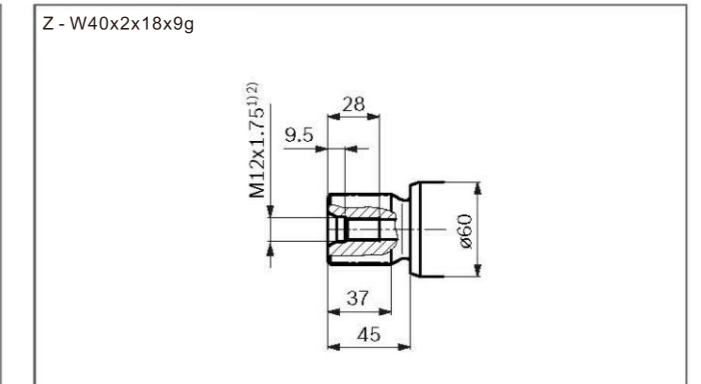

- 1) For notes on tightening torques, see the instruction manual
- 2) Center bore according to DIN 332 (thread according to DIN 13)

▼ EP.D - Proportional control, electric,
with pressure control fixed setting

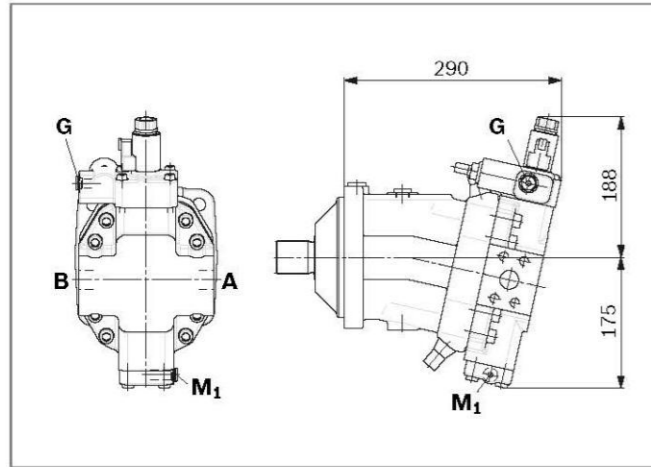

▼ EP.E - Proportional control, electric,
with pressure control hydraulic override, two-point

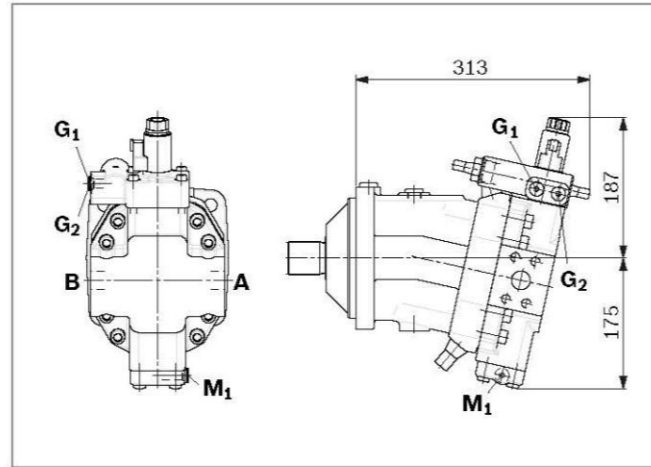

▼ HD1, HD2 - Proportional control, hydraulic

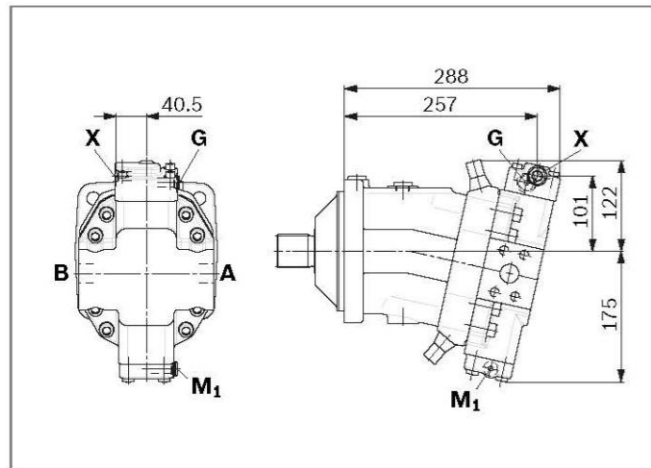

▼ HD.D - Proportional control, hydraulic,
with pressure control fixed setting

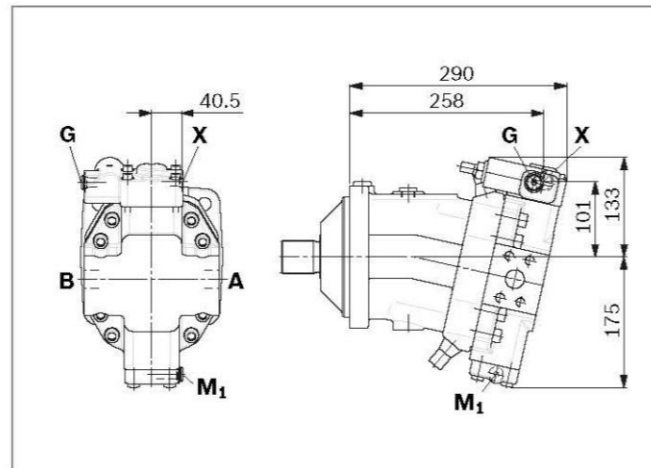

▼ HD.E - Proportional control, hydraulic,
with pressure control hydraulic override, two-point

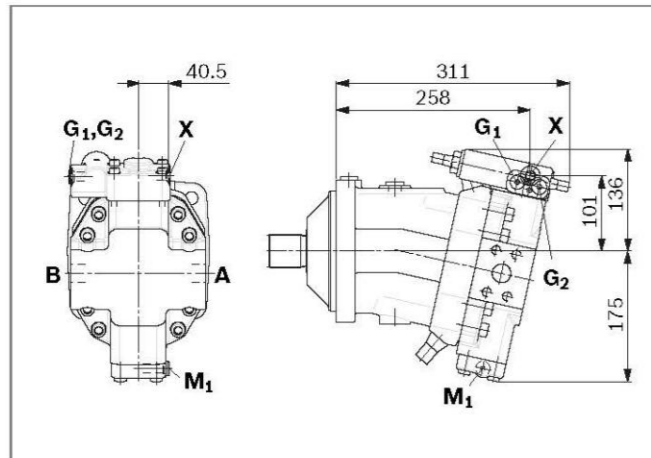

▼ HZ3 - Two-point control, hydraulic

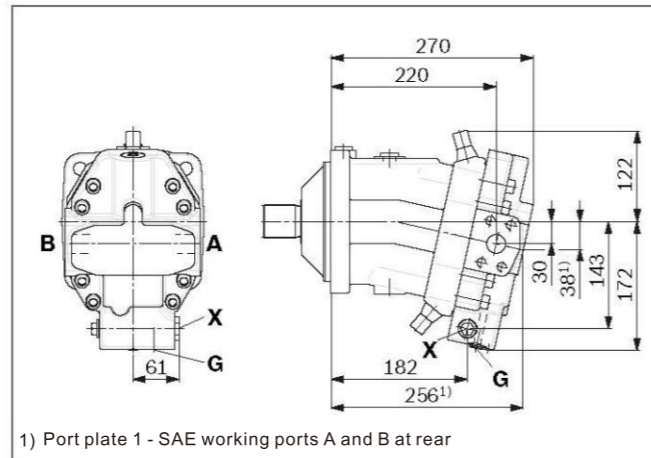

1) Port plate 1 - SAE working ports A and B at rear

▼ EZ3, EZ4 - Two-point control, electric

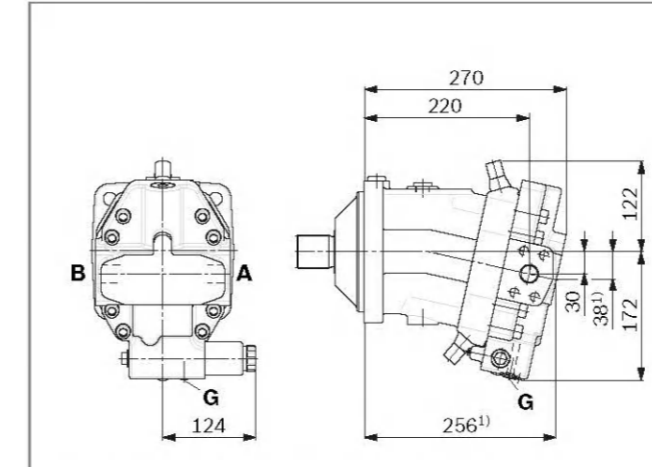

1) Port plate 1 - SAE working ports A and B at rear

▼ HA1, HA2 / HA1T, HA2T - Automatic high-pressure related
control, with override, hydraulic remote control, proportional

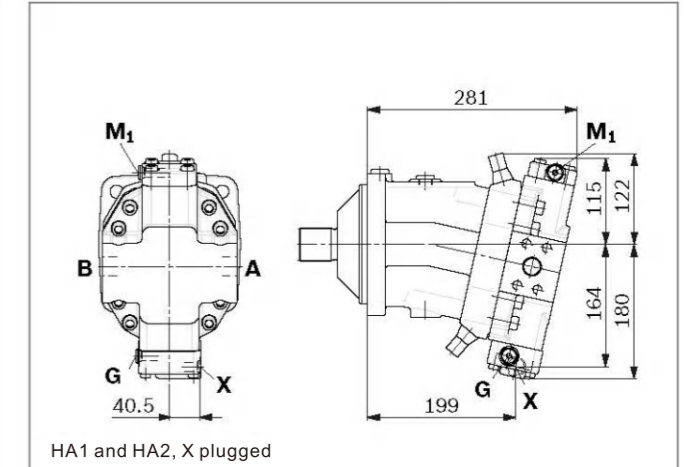

HA1 and HA2, X plugged
HA1T and HA2T, X open

▼ HA1U1, HA2U2 - Automatic high-pressure related control,
with electric override, two-point

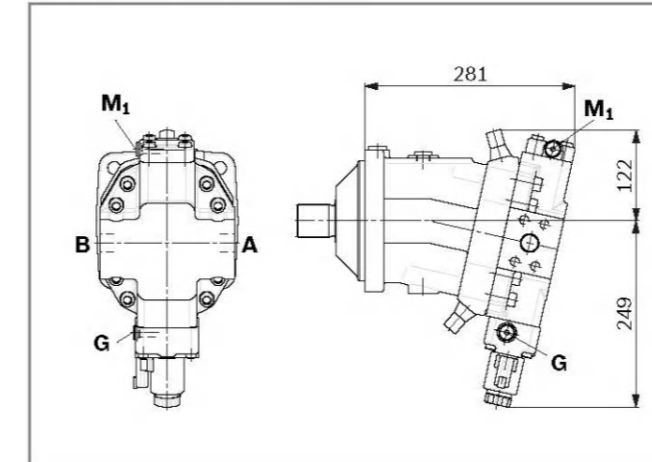

▼ HA1R1, HA2R2 - Automatic high-pressure related control
With electric override and electric travel direction valve

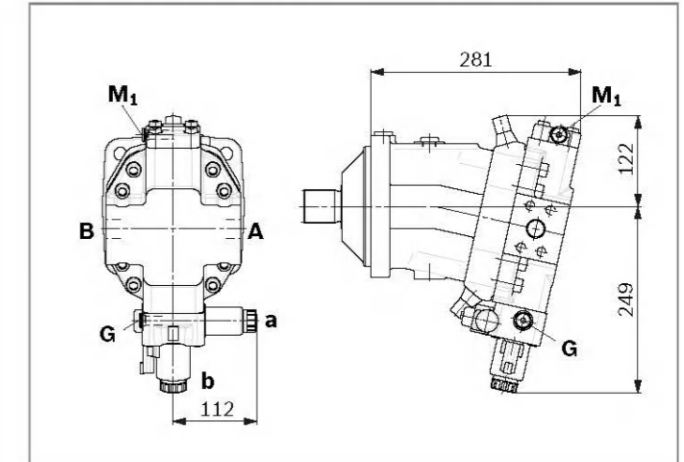

▼ DA1, DA4 - Automatic speed related control,
with hydraulic travel direction valve

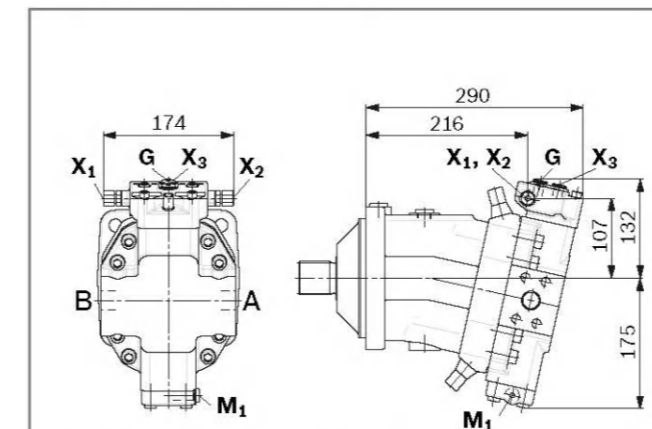

X1, X2 pipe fitting 8B-ST according to DIN 2353-CL; use installed fittings!

▼ DA2, DA3, DA5, DA6 - Automatic speed related control,
with electric travel direction valve and V_{gmax} -circuit

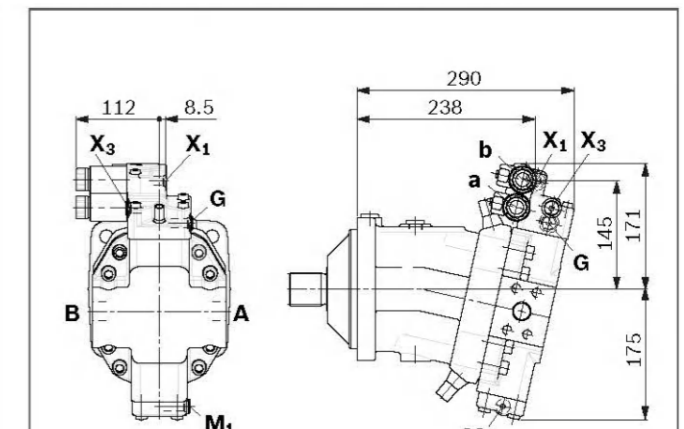

EP1, EP2 - Proportional control, electric

Port plate 2 - SAE working ports A and B lateral, opposing

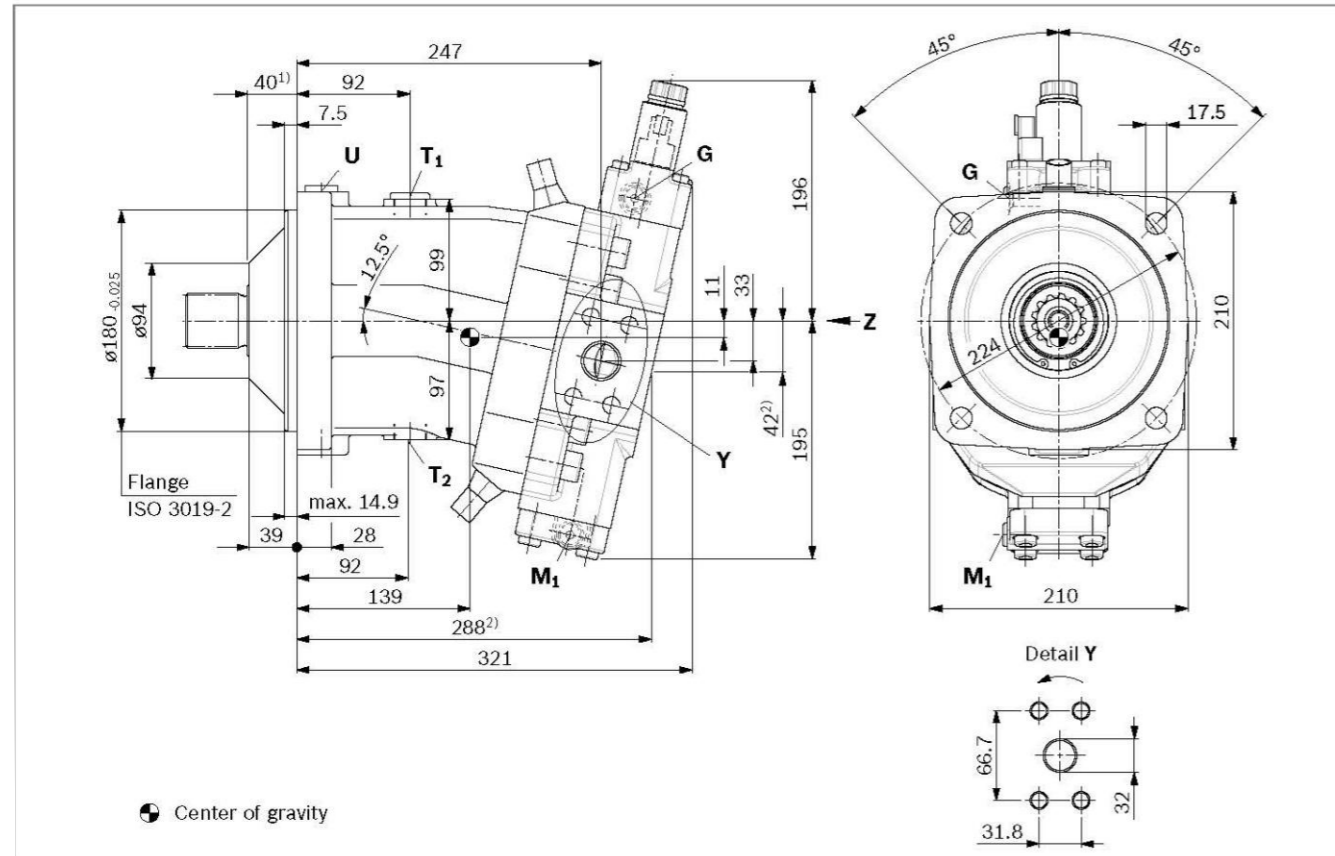

Ports	Standard	Size ³⁾	p_{max} [bar] ⁴⁾	State ⁶⁾
A, B	Working port Fastening thread A/B	SAE J518 ⁵⁾ DIN 13	1 1/4in M14 x 2; 19 deep	450 O
T ₁	Drain port	DIN 3852 ⁷⁾	M26 x 1.5; 16 deep	3 X ⁶⁾
T ₂	Drain port	DIN 3852 ⁷⁾	M26 x 1.5; 16 deep	3 O ⁶⁾
G	Synchronous control	DIN 3852 ⁷⁾	M14 x 1.5; 12 deep	450 X
G ₂	2nd pressure setting (HD.E, EP.E)	DIN 3852 ⁷⁾	M14 x 1.5; 12 deep	100 X
U	Bearing flushing	DIN 3852 ⁷⁾	M22 x 1.5; 14 deep	3 X
X	Pilot signal (HP, HZ, HA1T/HA2T)	DIN 3852 ⁷⁾	M14 x 1.5; 12 deep	100 O
X	Pilot signal (HA1, HA2)	DIN 3852 ⁷⁾	M14 x 1.5; 12 deep	3 X
X ₁ , X ₂	Pilot signal (DA1, DA4)	DIN 2353-CL	8B-ST	40 O
X ₁	Pilot signal (DA2, DA3, DA5, DA6)	DIN 3852 ⁷⁾	M14 x 1.5; 12 deep	40 O
X ₃	Pilot signal (DA2, DA3, DA5, DA6)	DIN 3852 ⁷⁾	M14 x 1.5; 12 deep	40 X
M ₁	Stroking chamber measurement	DIN 3852 ⁷⁾	M14 x 1.5; 12 deep	450 X

1) To shaft collar

2) Port plate 1 - SAE working ports A and B at rear

3) For notes on tightening torques, see the instruction manual

4) Depending on the application, momentary pressure peaks can occur.

Keep this in mind when selecting measuring devices and fittings

5) Only dimensions according to SAE J518, metric fastening thread is a deviation from the standard

6) Depending on installation position, T₁ or T₂, must be connected.

7) The countersink can be deeper than as specified in the standard

8) O=Must be connected (plugged when delivered)

X= Plugged (in normal operation)

▼ Location of the working ports on the port plates (view Z)

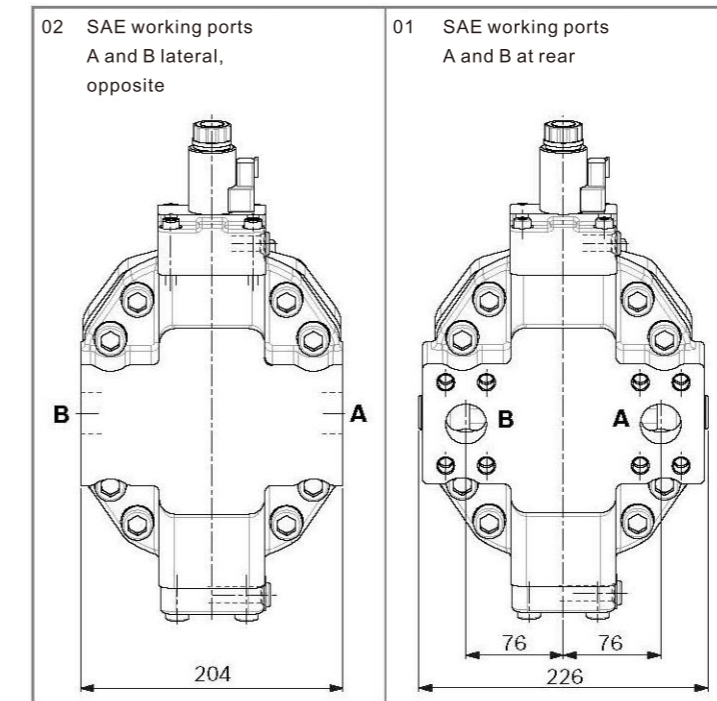

▼ Splined shaft DIN 5480

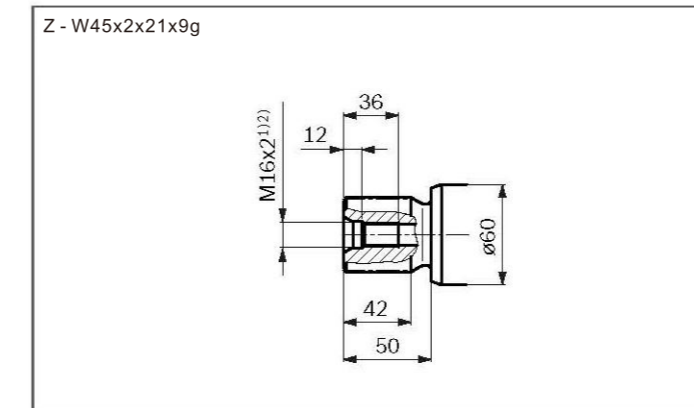

1) For notes on tightening torques, see the instruction manual

2) Center bore according to DIN 332 (thread according to DIN 13)

▼ EP.D - Proportional control, electric, with pressure control fixed setting

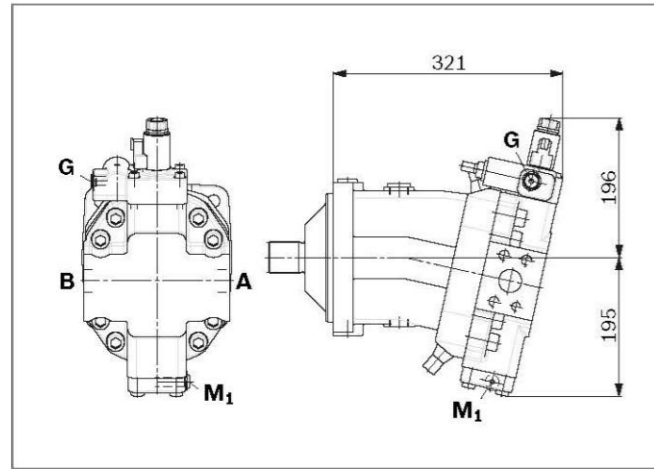

▼ EP.E - Proportional control, electric, with pressure control hydraulic override, two-point

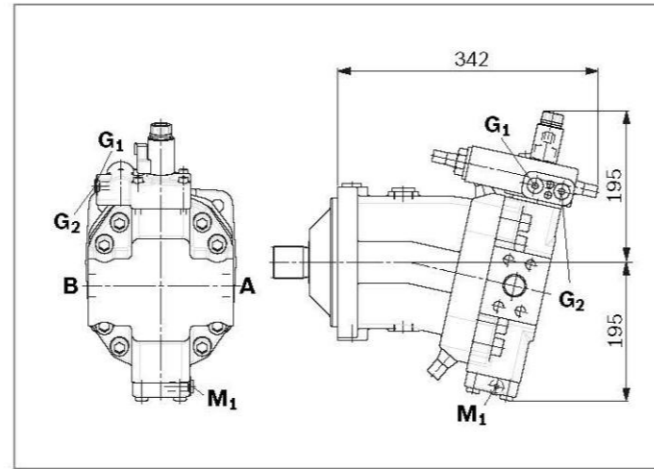

▼ HD1, HD2 - Proportional control, hydraulic

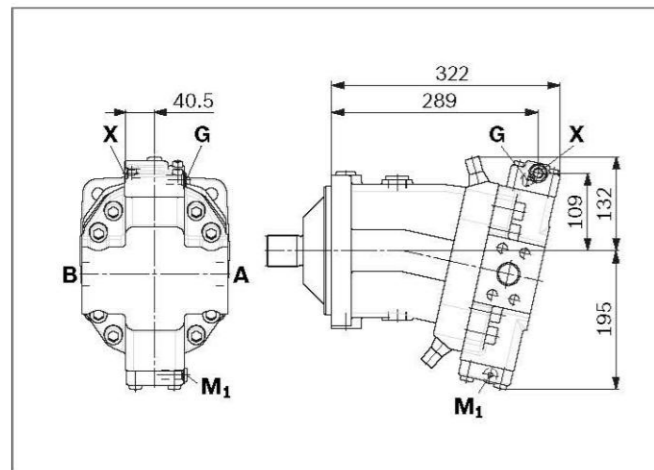

▼ HD.D - Proportional control, hydraulic, with pressure control fixed setting

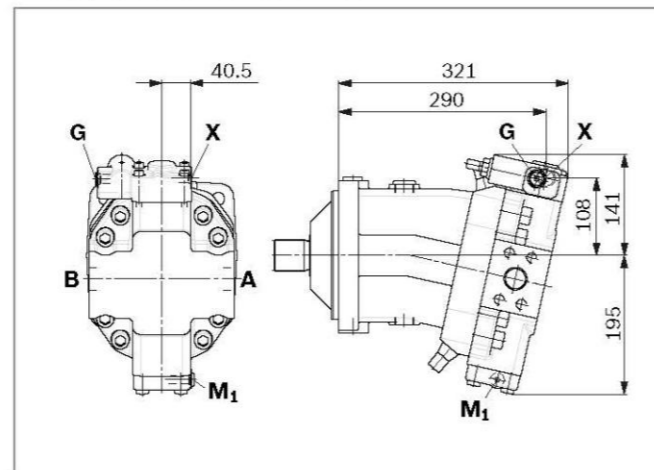

▼ HD.E - Proportional control, hydraulic, with pressure control hydraulic override, two-point

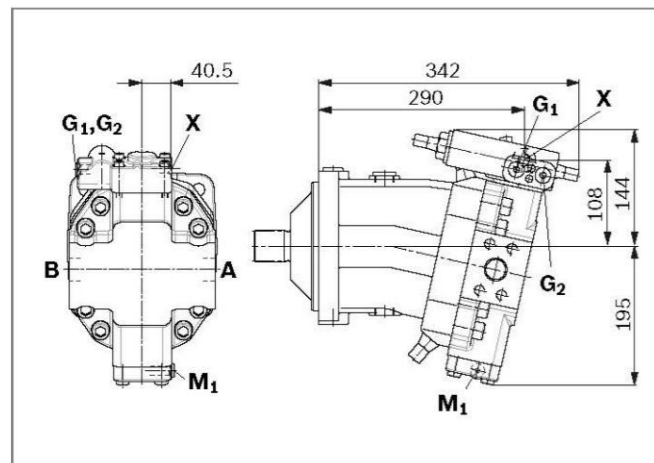

▼ HZ1 - Two-point control, hydraulic

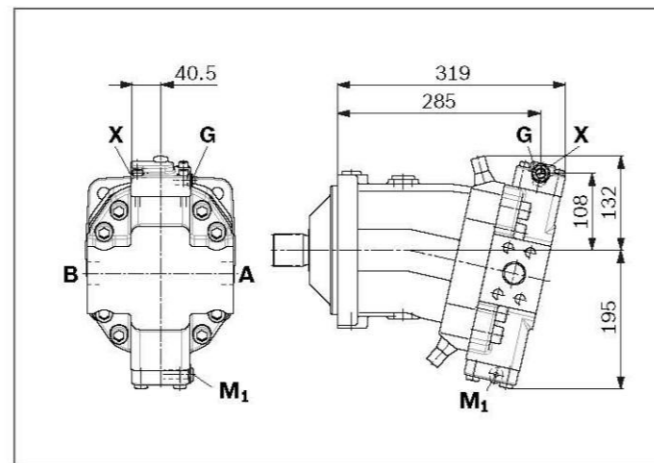

▼ EZ1, EZ2 - Two-point control, electric

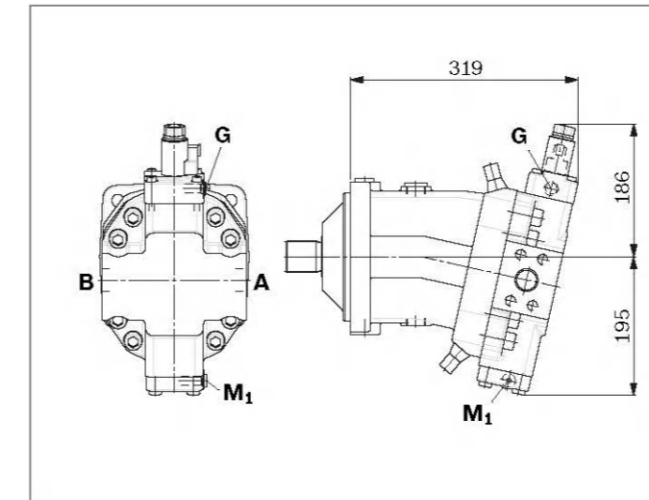

▼ HA1, HA2 / HA1T, HA2T - Automatic high-pressure related control, with override, hydraulic remote control, proportional

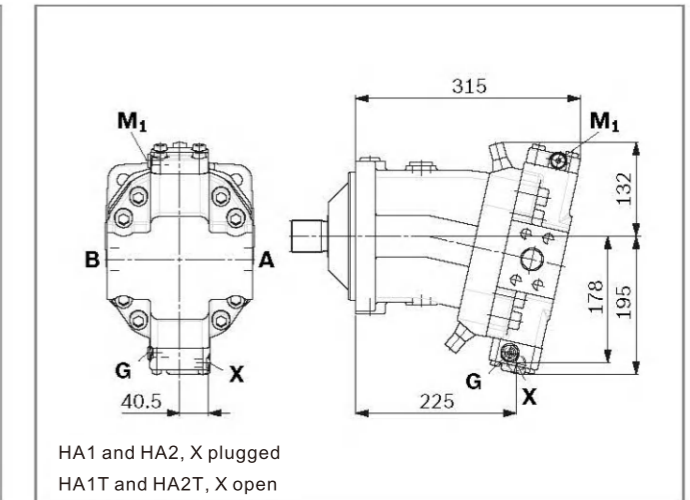

▼ HA1U1, HA2U2 - Automatic high-pressure related control, with electric override, two-point

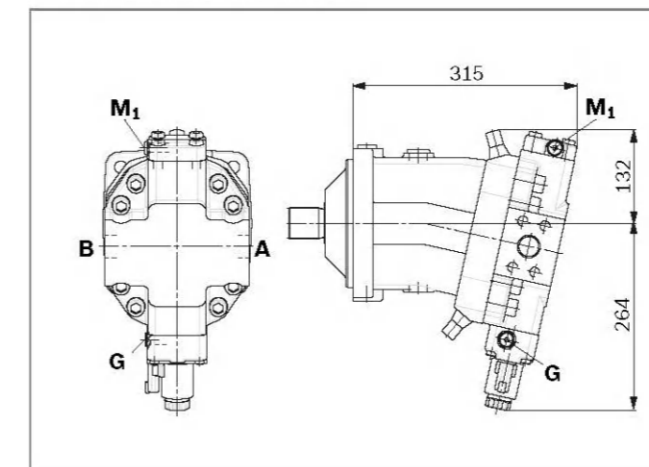

▼ HA1R1, HA2R2 - Automatic high-pressure related control With electric override and electric travel direction valve

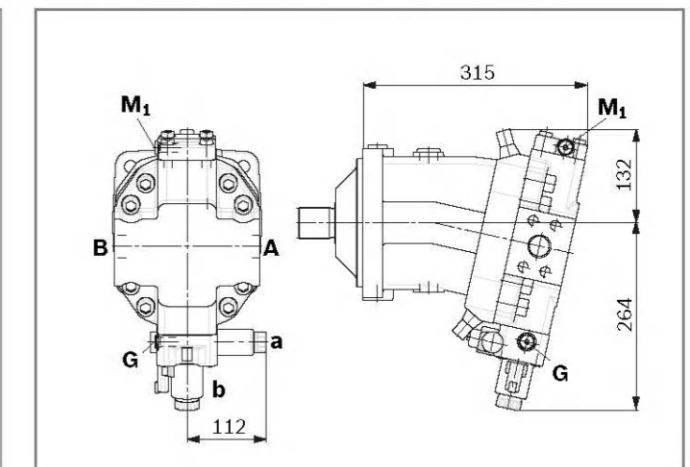

▼ DA1, DA4 - Automatic speed related control, with hydraulic travel direction valve

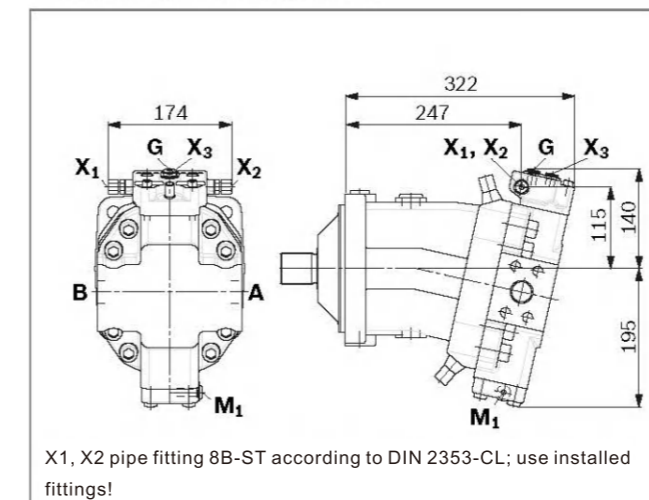

▼ DA2, DA3, DA5, DA6 - Automatic speed related control, with electric travel direction valve and V_{gmax} -circuit

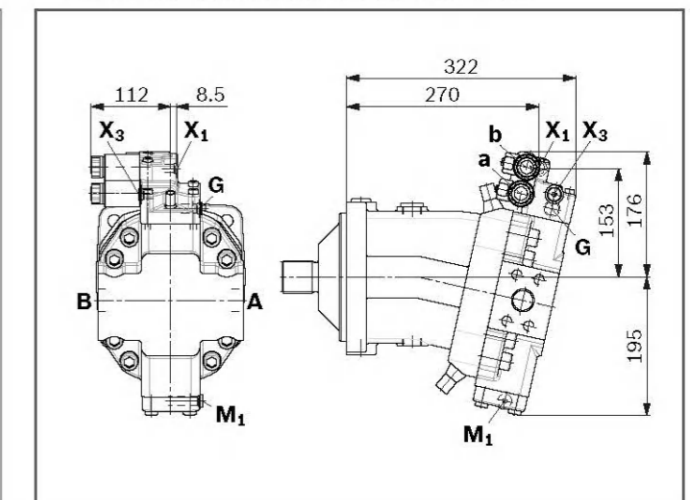

EP1, EP2 - Proportional control, electric
Port plate 2 - SAE working ports A and B lateral, opposing

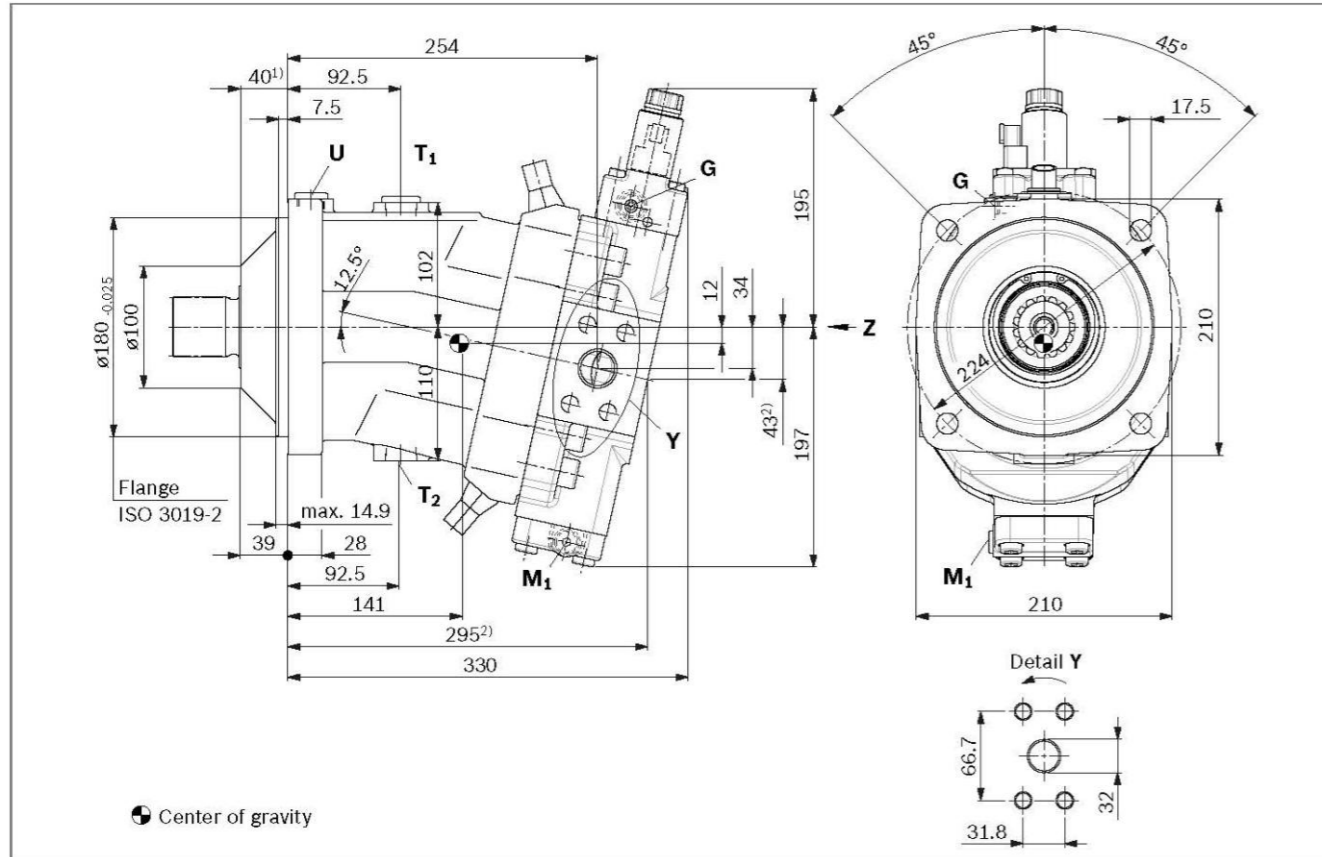

Ports	Standard	Size ³⁾	p_{max} [bar] ⁴⁾	State ⁸⁾
A, B	Working port Fastening thread A/B	SAE J518 ⁵⁾ DIN 13	1 1/4 in M14 x 2; 19 deep	450 O
T ₁	Drain port	DIN 3852 ⁷⁾	M26 x 1.5; 16 deep	3 X ⁶⁾
T ₂	Drain port	DIN 3852 ⁷⁾	M26 x 1.5; 16 deep	3 O ⁶⁾
G	Synchronous control	DIN 3852 ⁷⁾	M14 x 1.5; 12 deep	450 X
G ₂	2nd pressure setting (HD.E, EP.E)	DIN 3852 ⁷⁾	M14 x 1.5; 12 deep	100 X
U	Bearing flushing	DIN 3852 ⁷⁾	M22 x 1.5; 14 deep	3 X
X	Pilot signal (HP, HZ, HA1T/HA2T)	DIN 3852 ⁷⁾	M14 x 1.5; 12 deep	100 O
X	Pilot signal (HA1, HA4)	DIN 3852 ⁷⁾	M14 x 1.5; 12 deep	3 X
X ₁ , X ₂	Pilot signal (DA1, DA4)	DIN 2353-CL	8B-ST	40 O
X ₁	Pilot signal (DA2, DA3, DA5, DA6)	DIN 3852 ⁷⁾	M14 x 1.5; 12 deep	40 O
X ₃	Pilot signal (DA2, DA3, DA5, DA6)	DIN 3852 ⁷⁾	M14 x 1.5; 12 deep	40 X
M ₁	Stroking chamber measurement	DIN 3852 ⁷⁾	M14 x 1.5; 12 deep	450 X

- 1) To shaft collar
- 2) Port plate 1 - SAE working ports A and B at rear
- 3) For notes on tightening torques, see the instruction manual
- 4) Depending on the application, momentary pressure peaks can occur.
Keep this in mind when selecting measuring devices and fittings
- 5) Only dimensions according to SAE J518, metric fastening thread is a deviation from the standard

- 6) Depending on installation position, T₁ or T₂, must be connected.
- 7) The countersink can be deeper than as specified in the standard
- 8) O=Must be connected (plugged when delivered)
X= Plugged (in normal operation)

▼ Location of the working ports on the port plates (view Z)

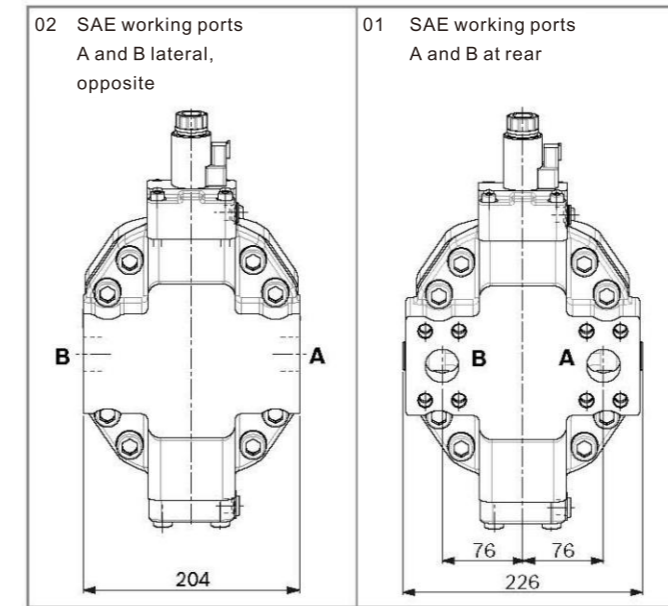

▼ Splined shaft DIN 5480

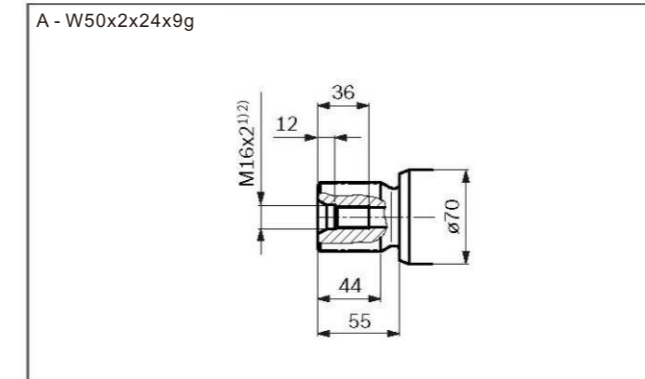

▼ Splined shaft DIN 5480

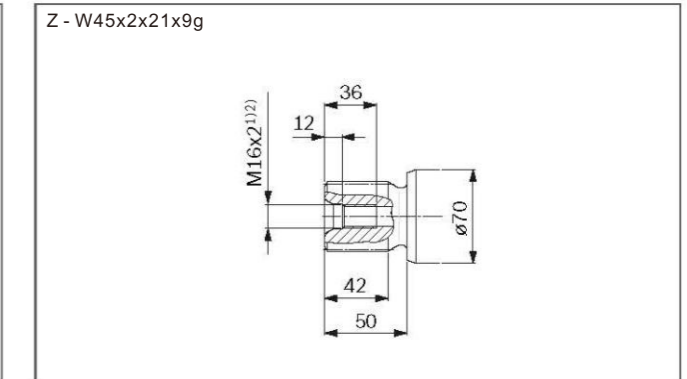

- 1) For notes on tightening torques, see the instruction manual
- 2) Center bore according to DIN 332 (thread according to DIN 13)

▼ EP.D - Proportional control, electric,
with pressure control fixed setting

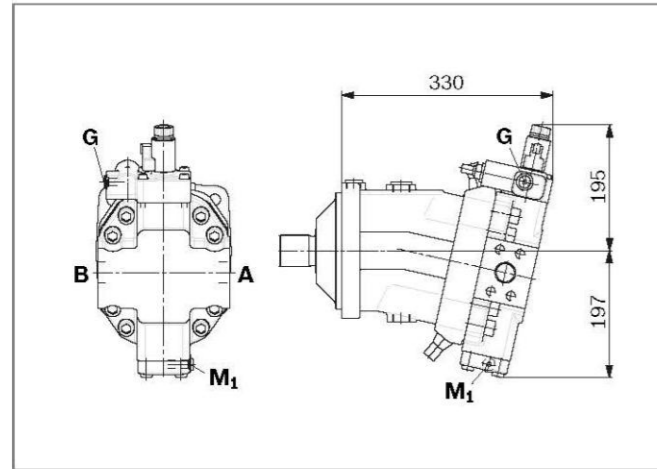

▼ EP.E - Proportional control, electric,
with pressure control hydraulic override, two-point

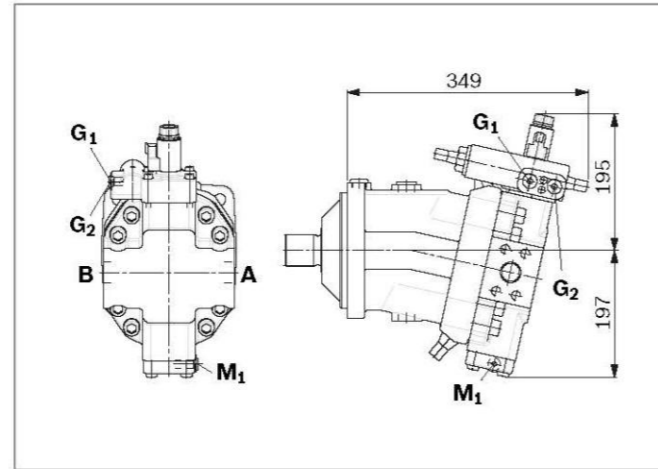

▼ HD1, HD2 - Proportional control, hydraulic

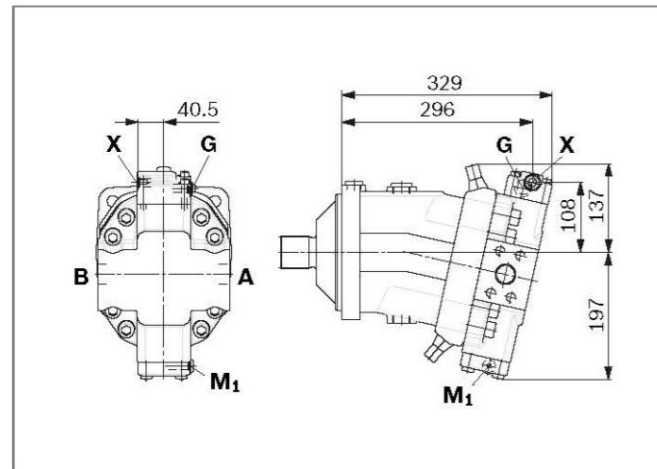

▼ HD.D - Proportional control, hydraulic,
with pressure control fixed setting

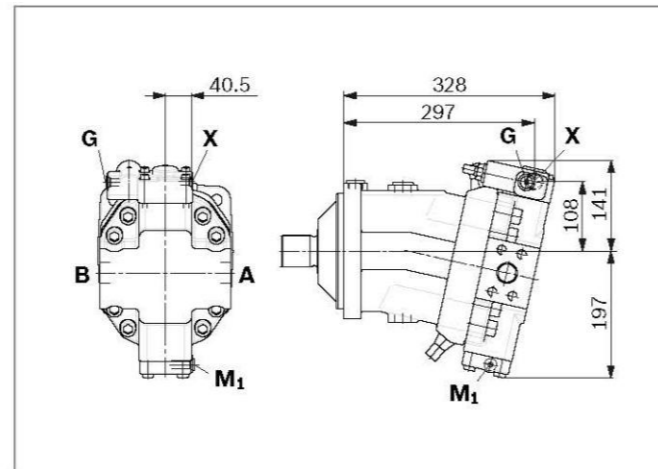

▼ HD.E - Proportional control, hydraulic,
with pressure control hydraulic override, two-point

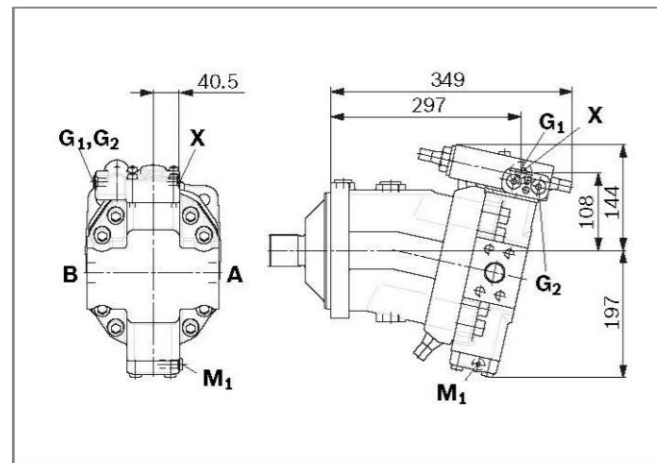

▼ HZ1 - Two-point control, hydraulic

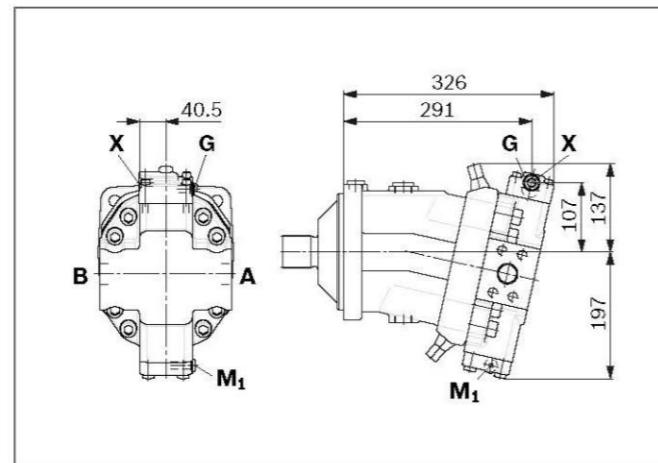

▼ EZ1, EZ2 - Two-point control, electric

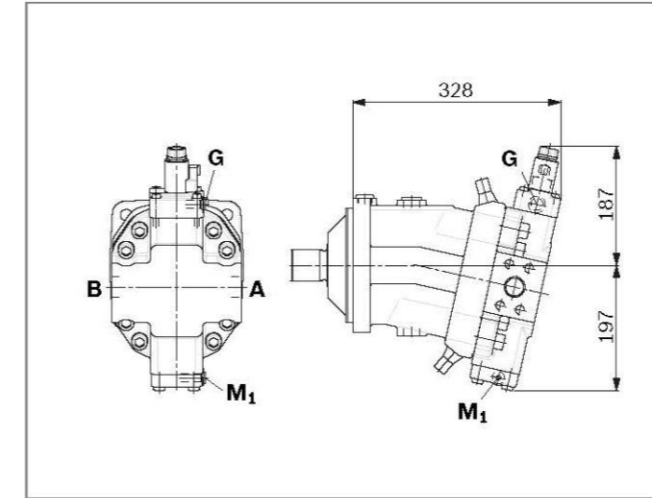

▼ HA1, HA2 / HA1T, HA2T - Automatic high-pressure related
control, with override, hydraulic remote control, proportional

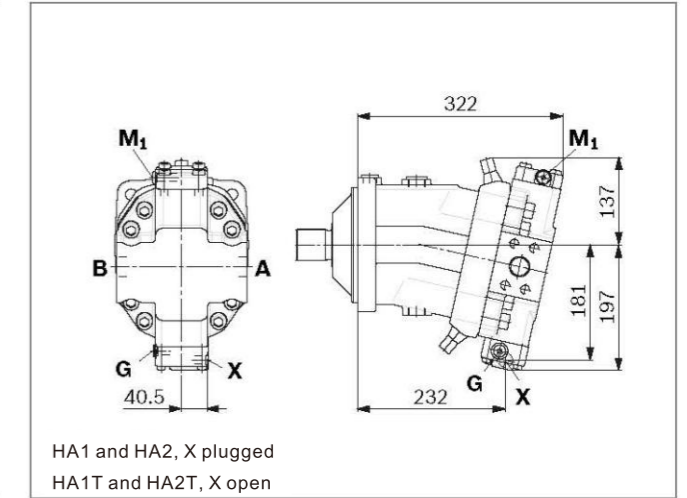

▼ HA1U1, HA2U2 - Automatic high-pressure related control,
with electric override, two-point

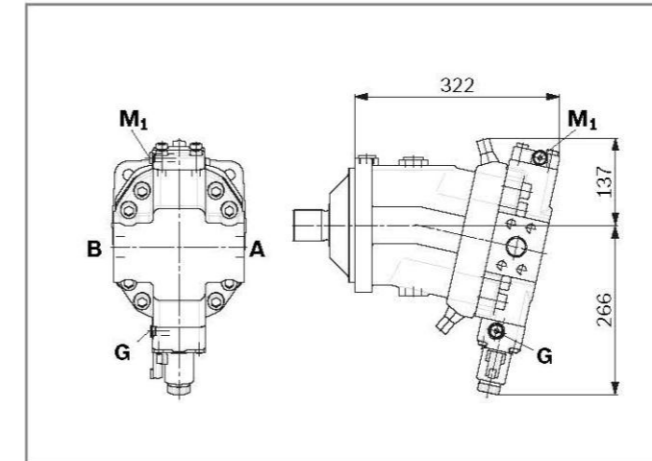

▼ HA1R1, HA2R2 - Automatic high-pressure related control
With electric override and electric travel direction valve

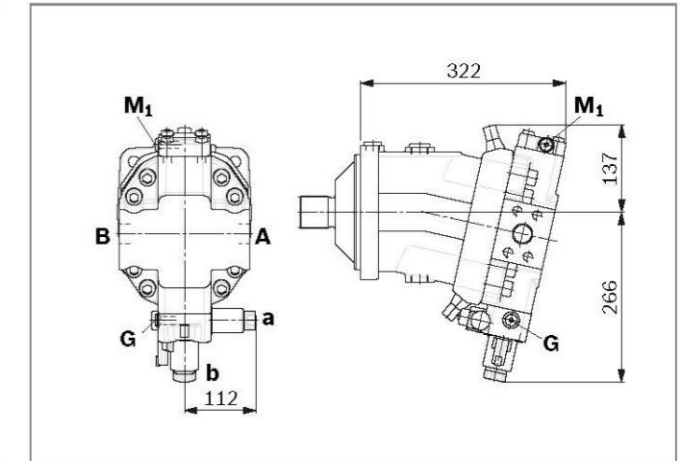

▼ DA1, DA4 - Automatic speed related control,
with hydraulic travel direction valve

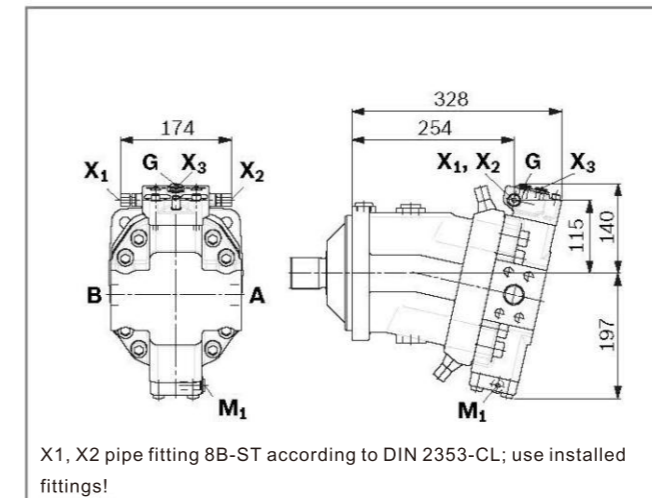

▼ DA2, DA3, DA5, DA6 - Automatic speed related control,
with electric travel direction valve and V_{gmax} -circuit

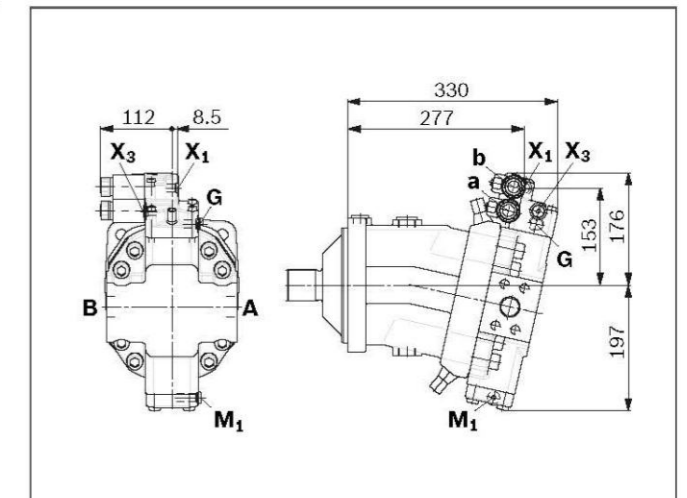

EP1, EP2 - Proportional control, electric

Port plate 2 - SAE working ports A and B lateral, opposing

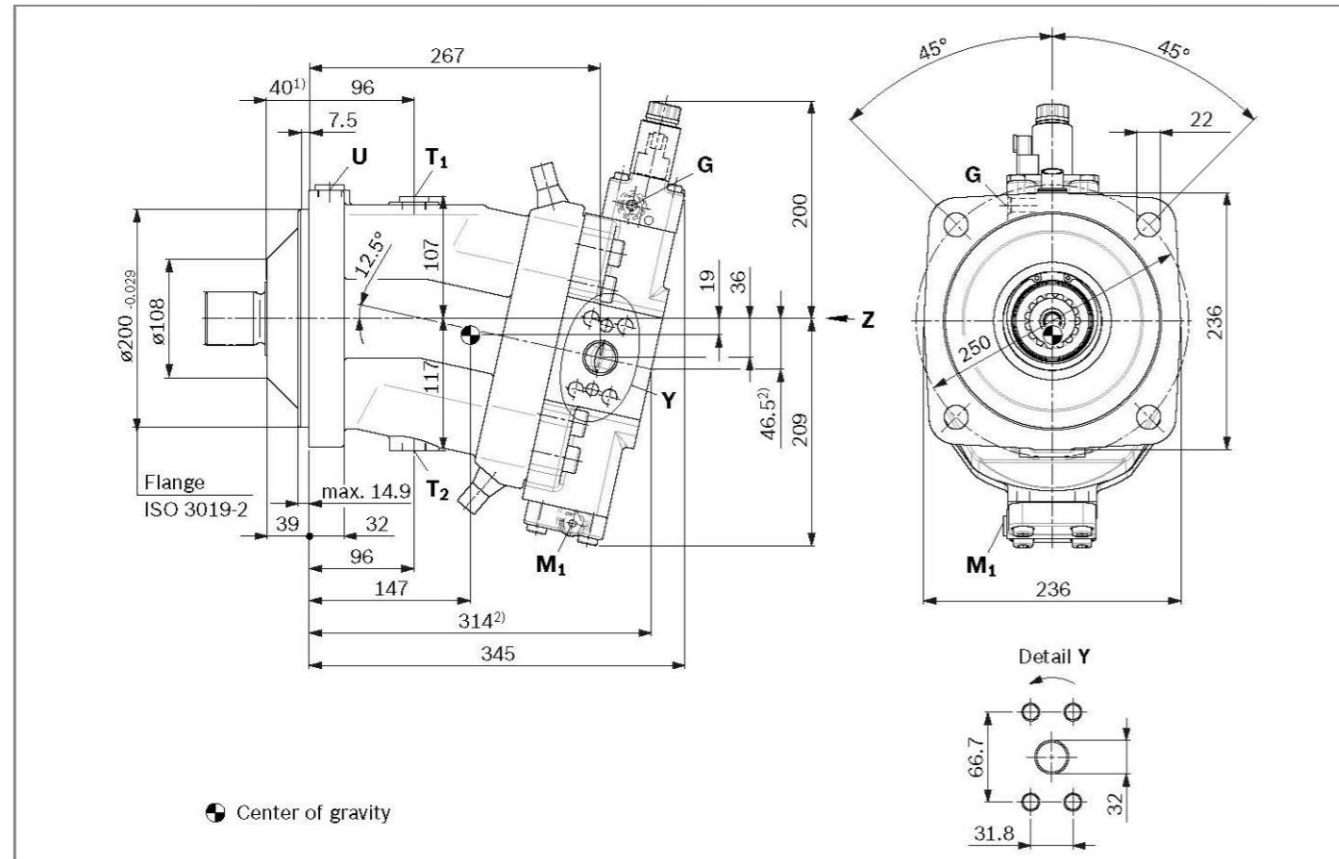

Ports	Standard	Size ³⁾	p _{max} [bar] ⁴⁾	State ⁸⁾
A, B	Working port Fastening thread A/B	SAE J518 ⁵⁾ DIN 13	1 1/4 in M14 x 2; 19 deep	450 O
T ₁	Drain port	DIN 3852 ⁷⁾	M26 x 1.5; 16 deep	3 X ⁶⁾
T ₂	Drain port	DIN 3852 ⁷⁾	M26 x 1.5; 16 deep	3 O ⁶⁾
G	Synchronous control	DIN 3852 ⁷⁾	M14 x 1.5; 12 deep	450 X
G ₂	2nd pressure setting (HD.E, EP.E)	DIN 3852 ⁷⁾	M14 x 1.5; 12 deep	100 X
U	Bearing flushing	DIN 3852 ⁷⁾	M22 x 1.5; 14 deep	3 X
X	Pilot signal (HP, HZ, HA1T/HA2T)	DIN 3852 ⁷⁾	M14 x 1.5; 12 deep	100 O
X	Pilot signal (HA1, HA2)	DIN 3852 ⁷⁾	M14 x 1.5; 12 deep	3 X
X ₁ , X ₂	Pilot signal (DA1, DA4)	DIN 2353-CL	8B-ST	40 O
X ₁	Pilot signal (DA2, DA3, DA5, DA6)	DIN 3852 ⁷⁾	M14 x 1.5; 12 deep	40 O
X ₃	Pilot signal (DA2, DA3, DA5, DA6)	DIN 3852 ⁷⁾	M14 x 1.5; 12 deep	40 X
M ₁	Stroking chamber measurement	DIN 3852 ⁷⁾	M14 x 1.5; 12 deep	450 X

1) To shaft collar

2) Port plate 1 - SAE working ports A and B at rear

3) For notes on tightening torques, see the instruction manual

4) Depending on the application, momentary pressure peaks can occur.
Keep this in mind when selecting measuring devices and fittings

5) Only dimensions according to SAE J518, metric fastening thread is a deviation from the standard

6) Depending on installation position, T₁ or T₂, must be connected.

7) The countersink can be deeper than as specified in the standard

8) O=Must be connected (plugged when delivered)

X= Plugged (in normal operation)

▼ Location of the working ports on the port plates (view Z)

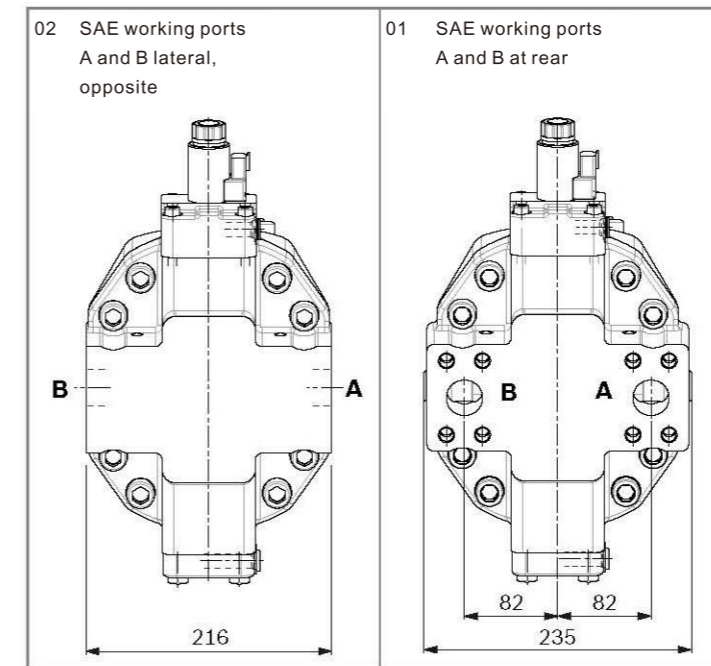

▼ Splined shaft DIN 5480

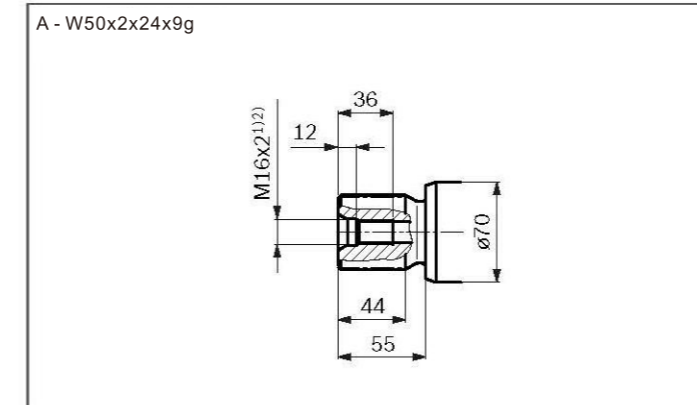

1) For notes on tightening torques, see the instruction manual

2) Center bore according to DIN 332 (thread according to DIN 13)

▼ EP.D - Proportional control, electric, with pressure control fixed setting

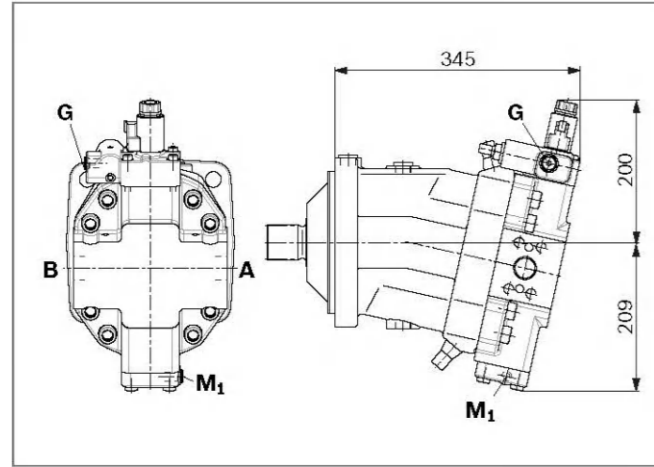

▼ EP.E - Proportional control, electric, with pressure control hydraulic override, two-point

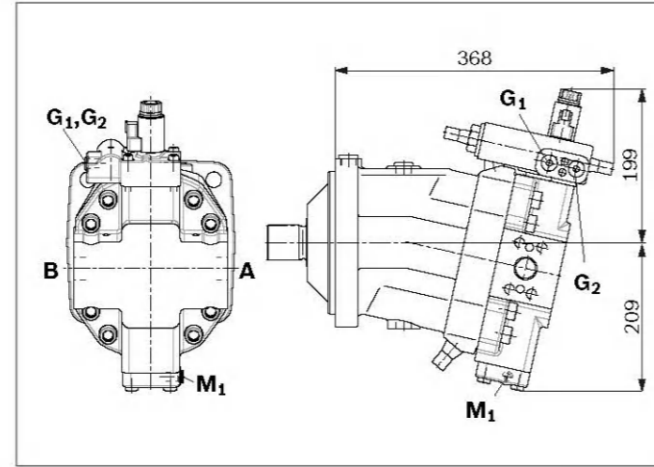

▼ HD1, HD2 - Proportional control, hydraulic

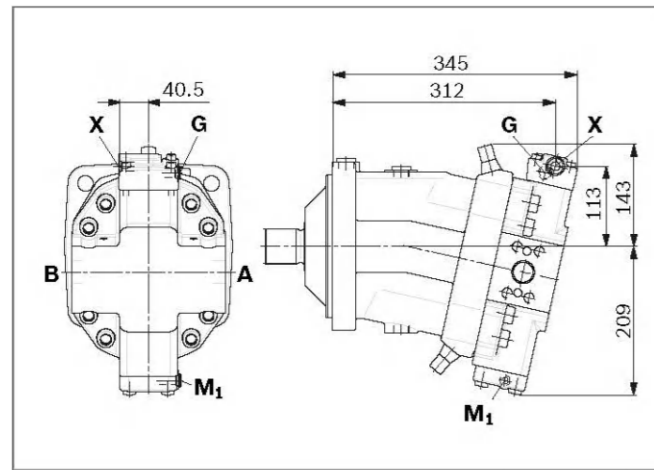

▼ HD.D - Proportional control, hydraulic, with pressure control fixed setting

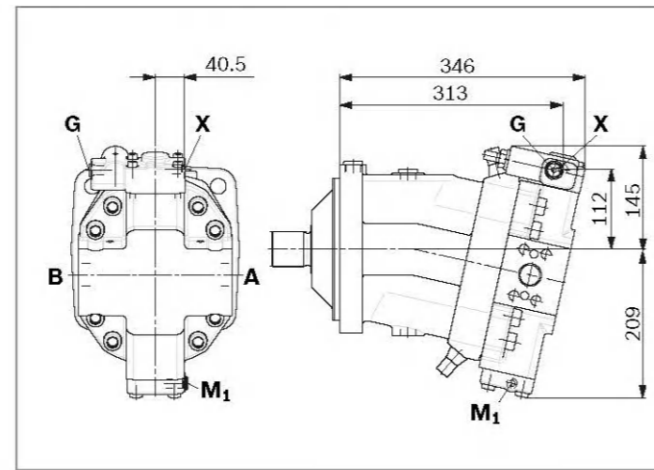

▼ HD.E - Proportional control, hydraulic, with pressure control hydraulic override, two-point

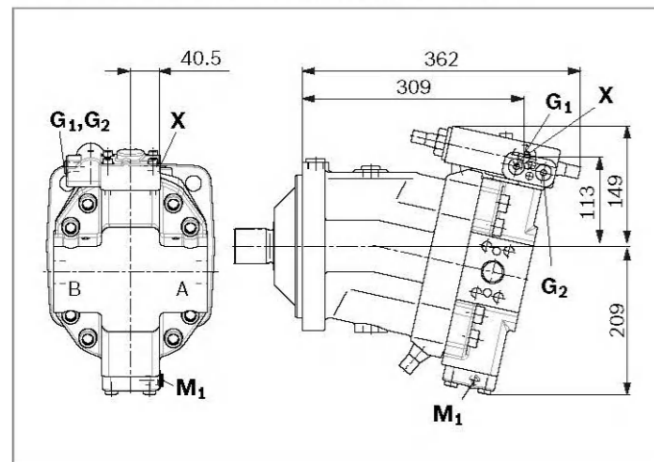

▼ HZ1 - Two-point control, hydraulic

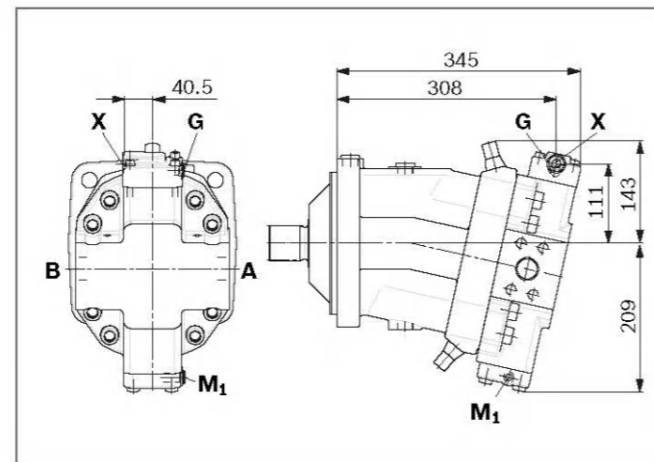

▼ EZ1, EZ2 - Two-point control, electric

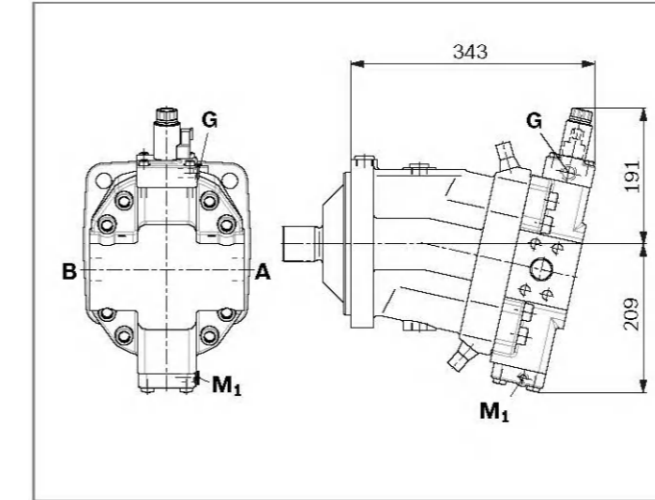

▼ HA1, HA2 / HA1T, HA2T - Automatic high-pressure related control, with override, hydraulic remote control, proportional

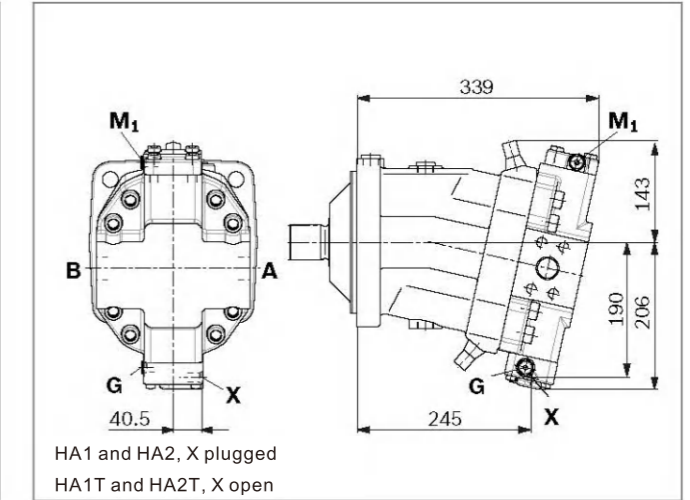

▼ HA1U1, HA2U2 - Automatic high-pressure related control, with electric override, two-point

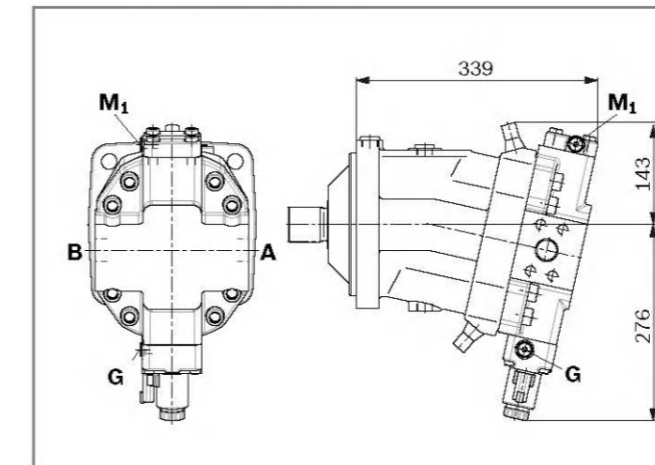

▼ HA1R1, HA2R2 - Automatic high-pressure related control With electric override and electric travel direction valve

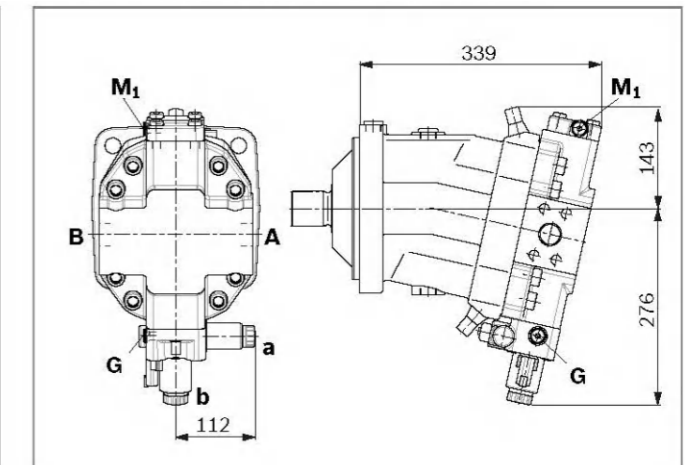

▼ DA1, DA4 - Automatic speed related control, with hydraulic travel direction valve

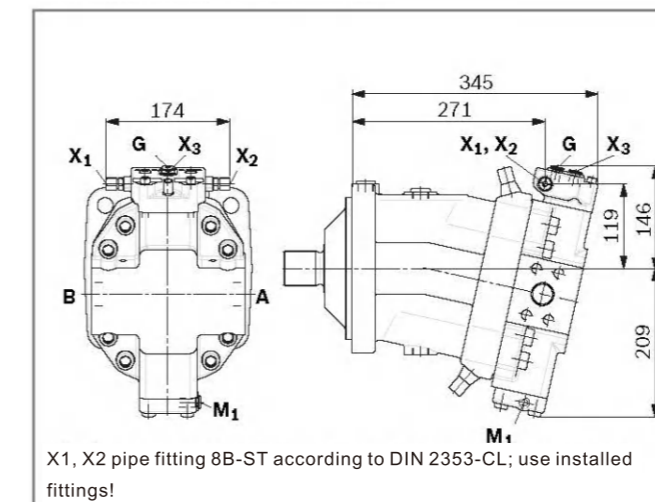

X1, X2 pipe fitting 8B-ST according to DIN 2353-CL; use installed fittings!

▼ DA2, DA3, DA5, DA6 - Automatic speed related control, with electric travel direction valve and $V_{g,max}$ -circuit

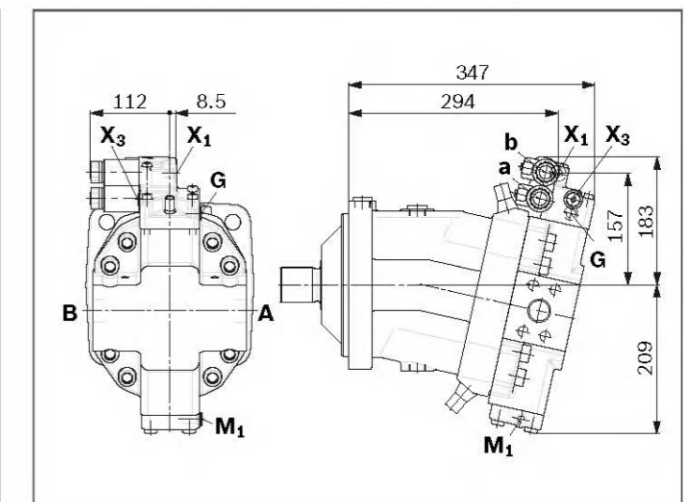

HD1, HD2 - Proportional control, hydraulic

HZ- Two-point control, hydraulic

Port plate 2 - SAE working ports A and B lateral, opposing

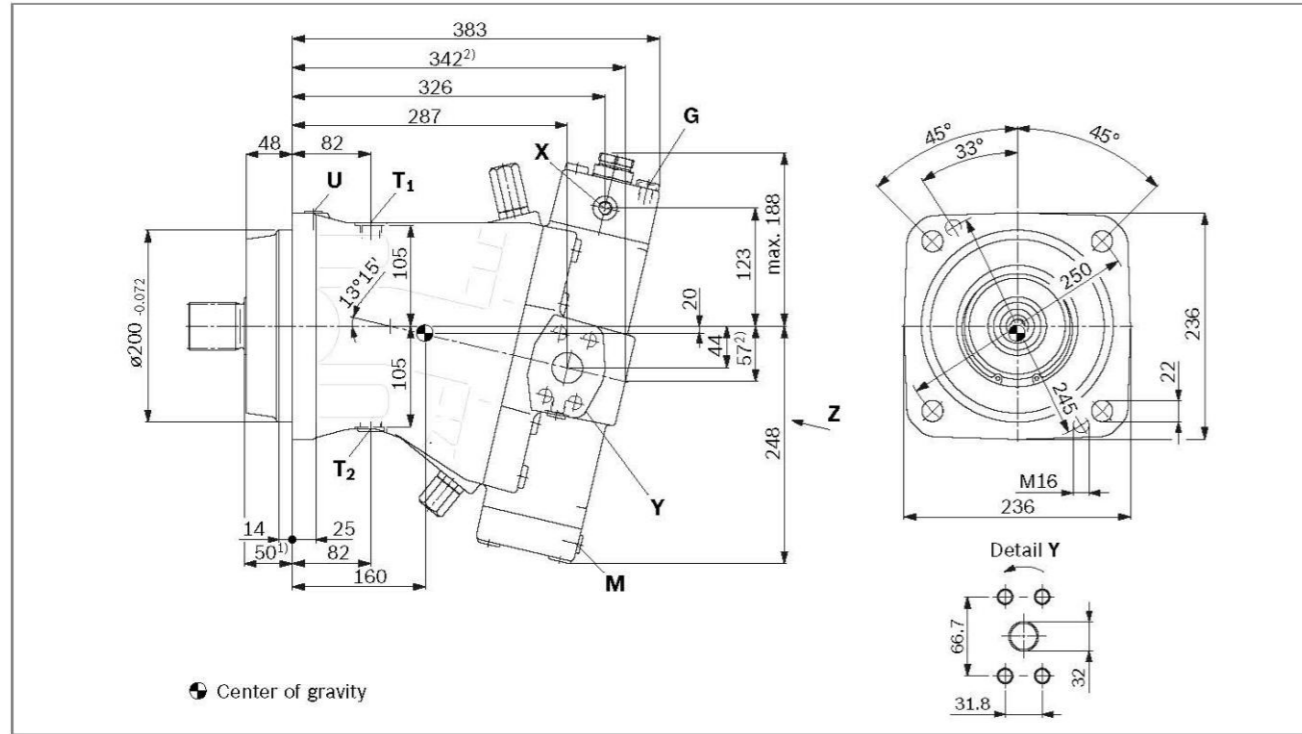

Ports	Standard	Size ³⁾	p_{max} [bar] ⁴⁾	State ⁵⁾
A, B	SAE J518 ⁵⁾ DIN 13	1 1/4 in M14 x 2; 19 deep	400	O
A ₁ , B ₁	SAE J518 ⁵⁾ DIN 13	1 1/4 in M14 x 2; 19 deep	400	O
T ₁	DIN 3852 ⁷⁾	M22 x 1.5; 14 deep	3	X ⁶⁾
T ₂	DIN 3852 ⁷⁾	M22 x 1.5; 14 deep	3	O ⁶⁾
G	DIN 3852 ⁷⁾	M14 x 1.5; 12 deep	400	X
G ₂	DIN 3852 ⁷⁾	M14 x 1.5; 12 deep	400	X
P	DIN 3852 ⁷⁾	M14 x 1.5; 12 deep	100	O
U	DIN 3852 ⁷⁾	M14 x 1.5; 12 deep	3	X
X	DIN 3852 ⁷⁾	M14 x 1.5; 12 deep	100	O
X	DIN 3852 ⁷⁾	M14 x 1.5; 12 deep	3	X
X ₁ , X ₂	DIN 2353-CL	8B-ST	40	O
X ₃	DIN 3852 ⁷⁾	M14 x 1.5; 12 deep	400	O
M	DIN 3852 ⁷⁾	M14 x 1.5; 12 deep	400	X
M _A , M _B	DIN 3852 ⁷⁾	M14 x 1.5; 12 deep	400	X
M _{st}	DIN 3852 ⁷⁾	M14 x 1.5; 12 deep	400	X

1) To shaft collar

2) Port plate 1/15 - SAE working ports A and B at rear

3) For notes on tightening torques, see the instruction manual

4) Depending on the application, momentary pressure peaks can occur. Keep this in mind when selecting measuring devices and fittings

5) Only dimensions according to SAE J518, metric fastening thread is a deviation from the standard

6) Depending on installation position, T₁ or T₂, must be connected.

7) The countersink can be deeper than as specified in the standard

8) O=Must be connected (plugged when delivered)
X= Plugged (in normal operation)

▼ Location of the working ports on the port plates (view Z)

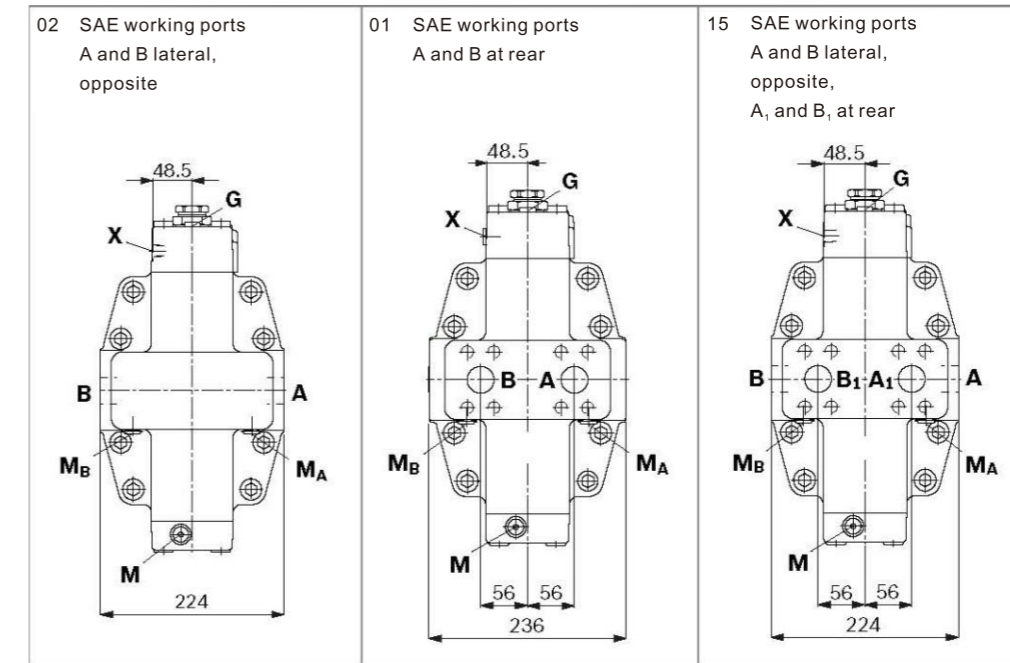

▼ Splined shaft DIN 5480

Z - W50x2x24x9g

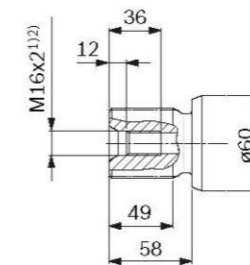

▼ Cyl. Keyed shaft, DIN 6885

P - AS14X9X80

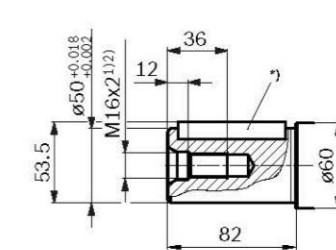

Key width 14

1) For notes on tightening torques, see the instruction manual
2) Center bore according to DIN 332 (thread according to DIN 13)

▼ Location of the working ports on the port plates (view Z)

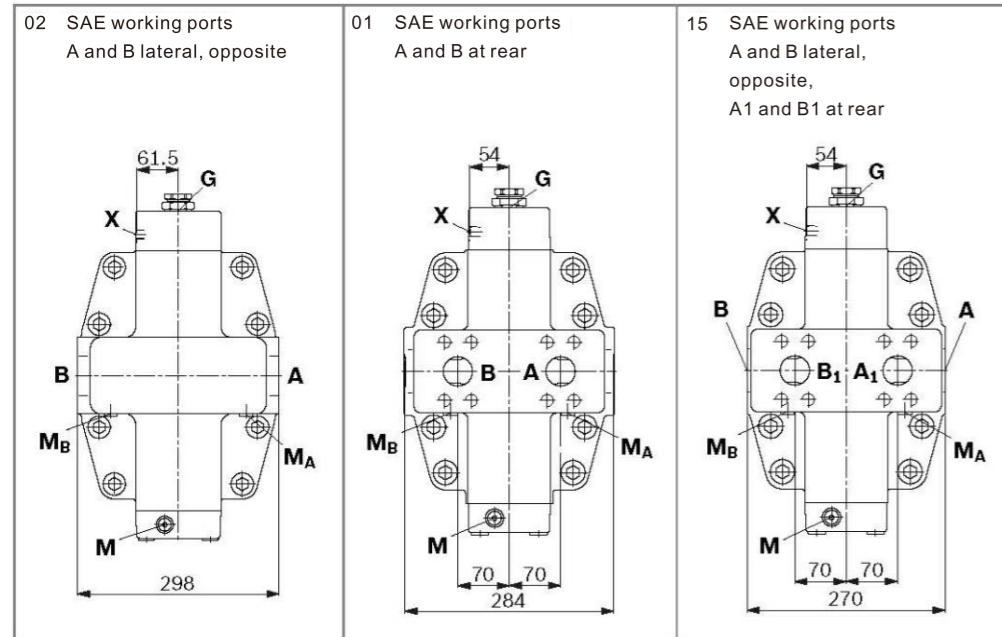

▼ Splined shaft DIN 5480

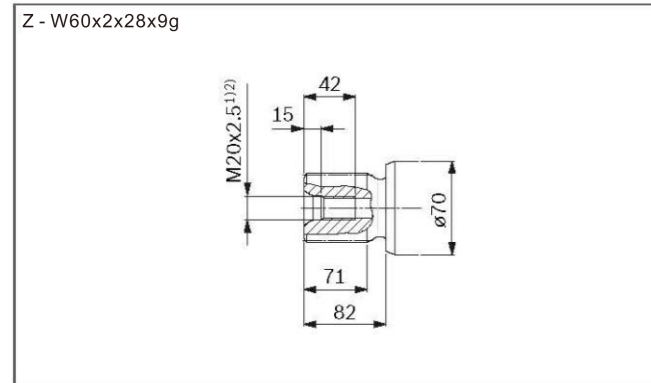

▼ Cyl. Keyed shaft, DIN 6885

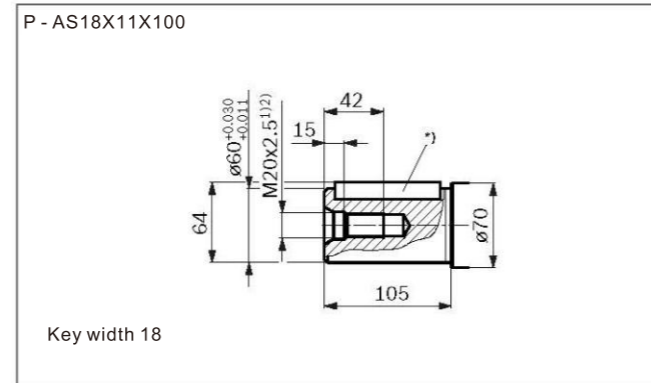

1) For notes on tightening torques, see the instruction manual
2) Center bore according to DIN 332 (thread according to DIN 13)

▼ EP1, EP2 - Proportional control, electric

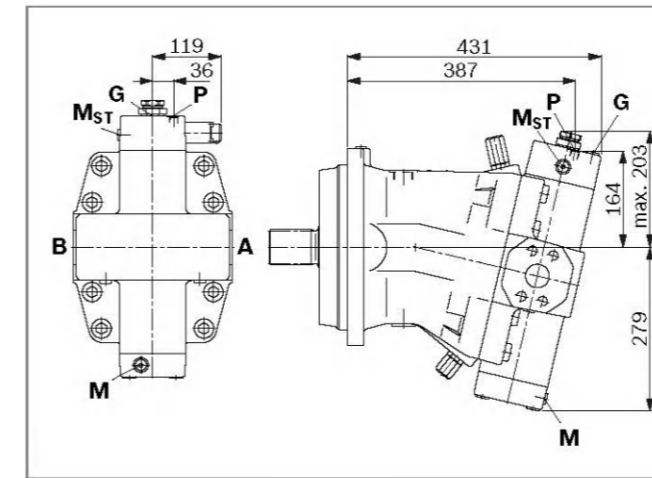

▼ EP.D, EP.G - Proportional control electric,
with pressure control fixed setting; remote controlled(EP.G)

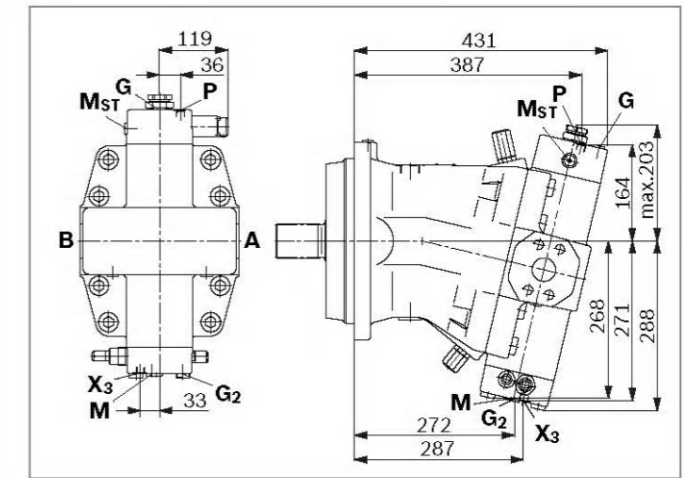

▼ HD.D, HD.G - Proportional control, hydraulic
with pressure control fixed setting; remote controlled (HD.G)

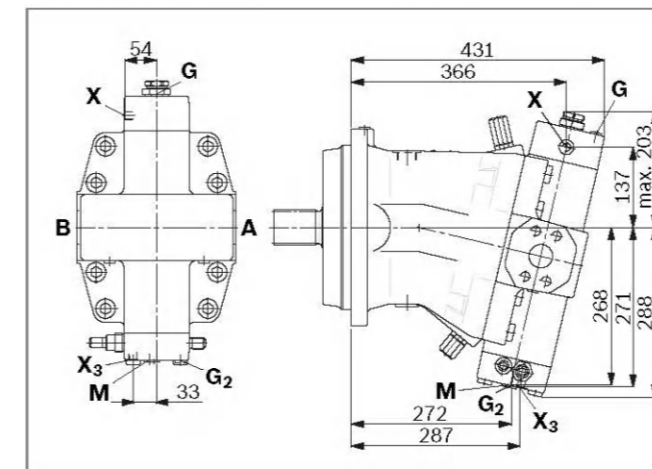

▼ EZ1, EZ2 - Two-point control, electric

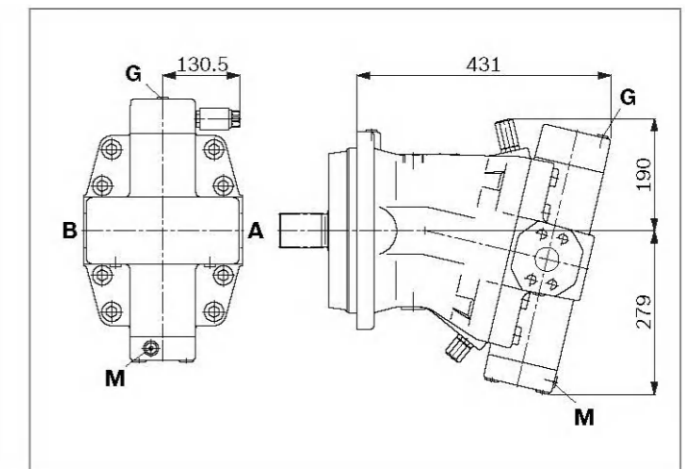

▼ HA1, HA2 / HA1T, HA2T - Automatic high-pressure related
control, with override hydraulic remote control, proportional

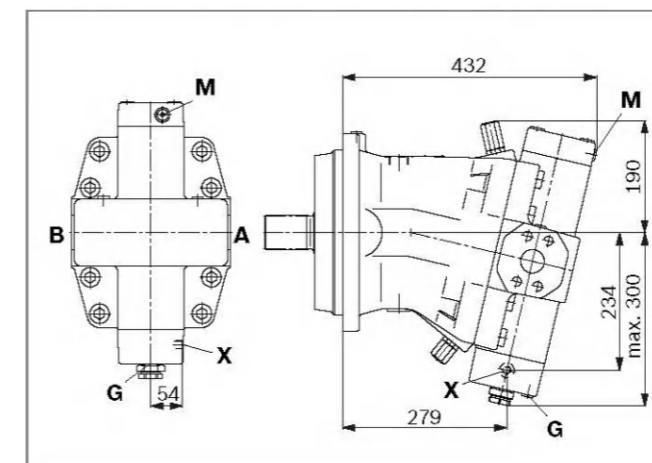

▼ DA - Automatic speed related control,
with hydraulic travel direction valve

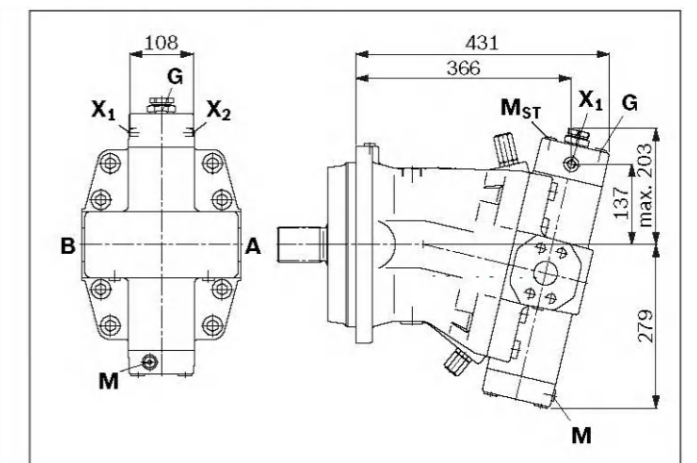

▼ EP1, EP2 - Proportional control, electric

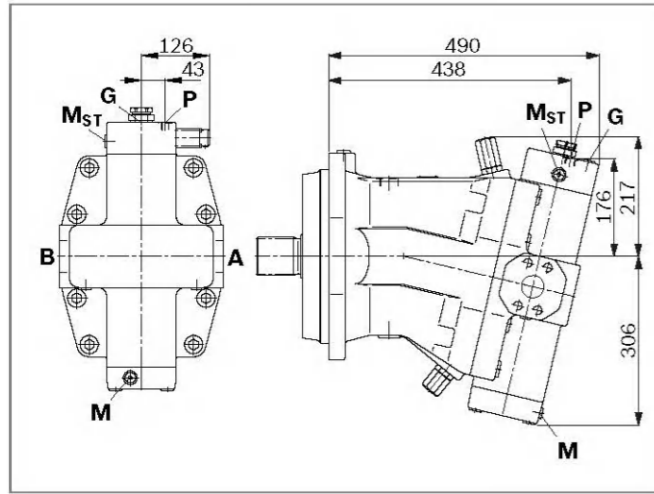

▼ EP.D, EP.G - Proportional control electric, with pressure control fixed setting; remote controlled(EP.G)

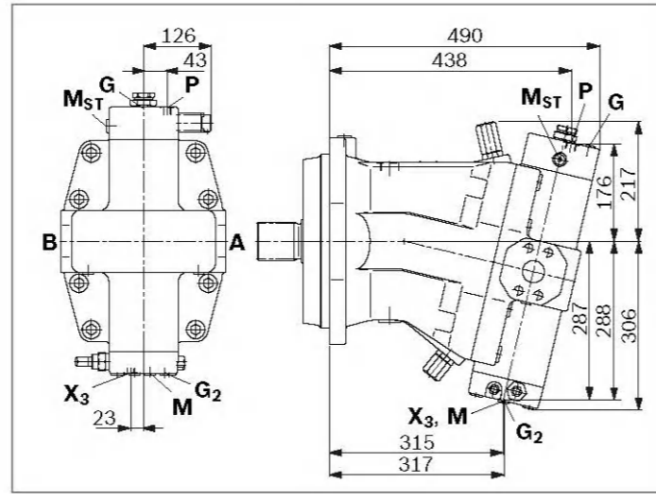

▼ HD.D, HD.G - Proportional control hydraulic with pressure control fixed setting; remote controlled (HD.G)

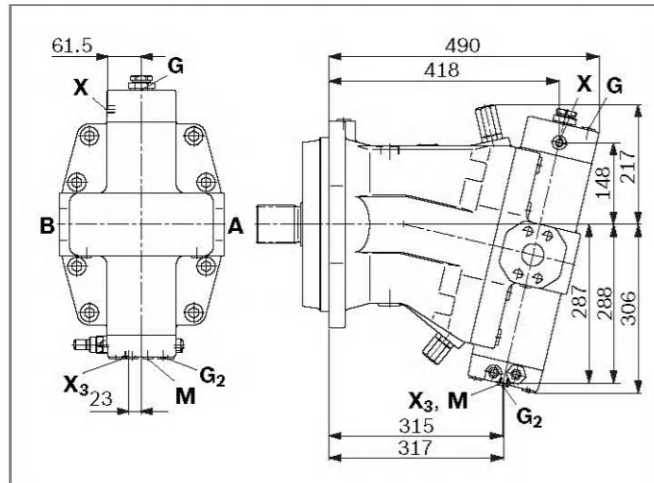

▼ EZ1, EZ2 - Two-point control, electric

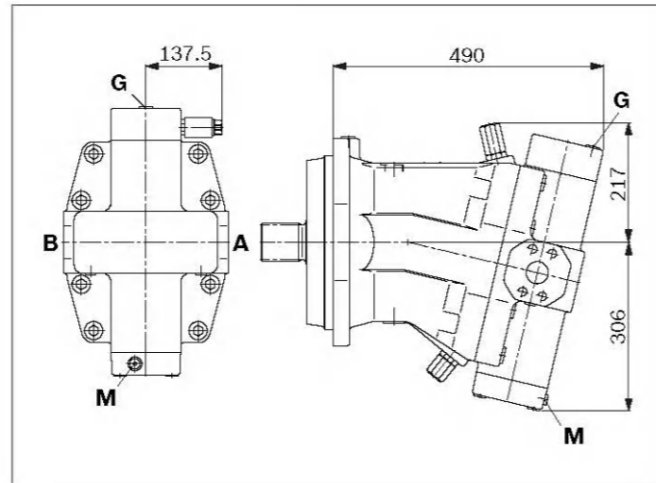

▼ HA1, HA2 / HA1T, HA2T - Automatic high-pressure related control, with override, hydraulic remote control, proportional

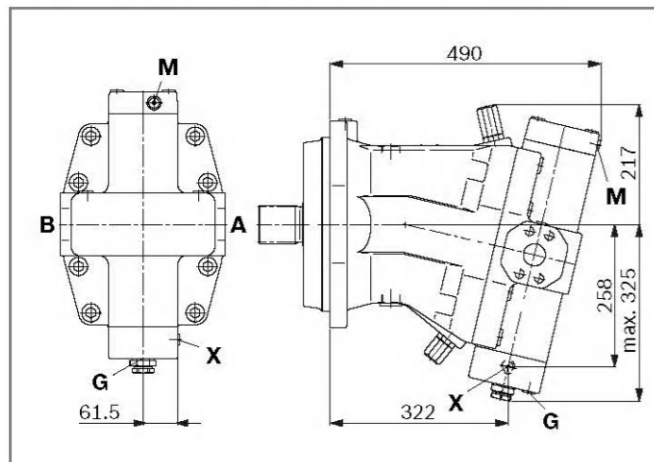

▼ DA - Automatic speed related control, with hydraulic travel direction valve

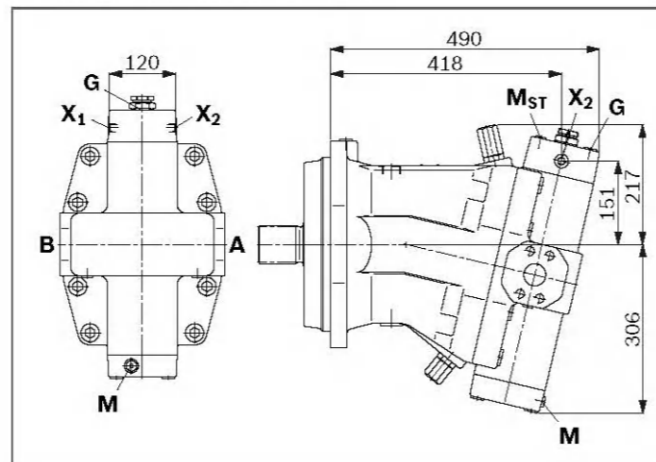

HD1, HD2 - Proportional control, hydraulic
HZ - Two-point control, hydraulic
Port plate 2 - SAE working ports A and B lateral, opposite

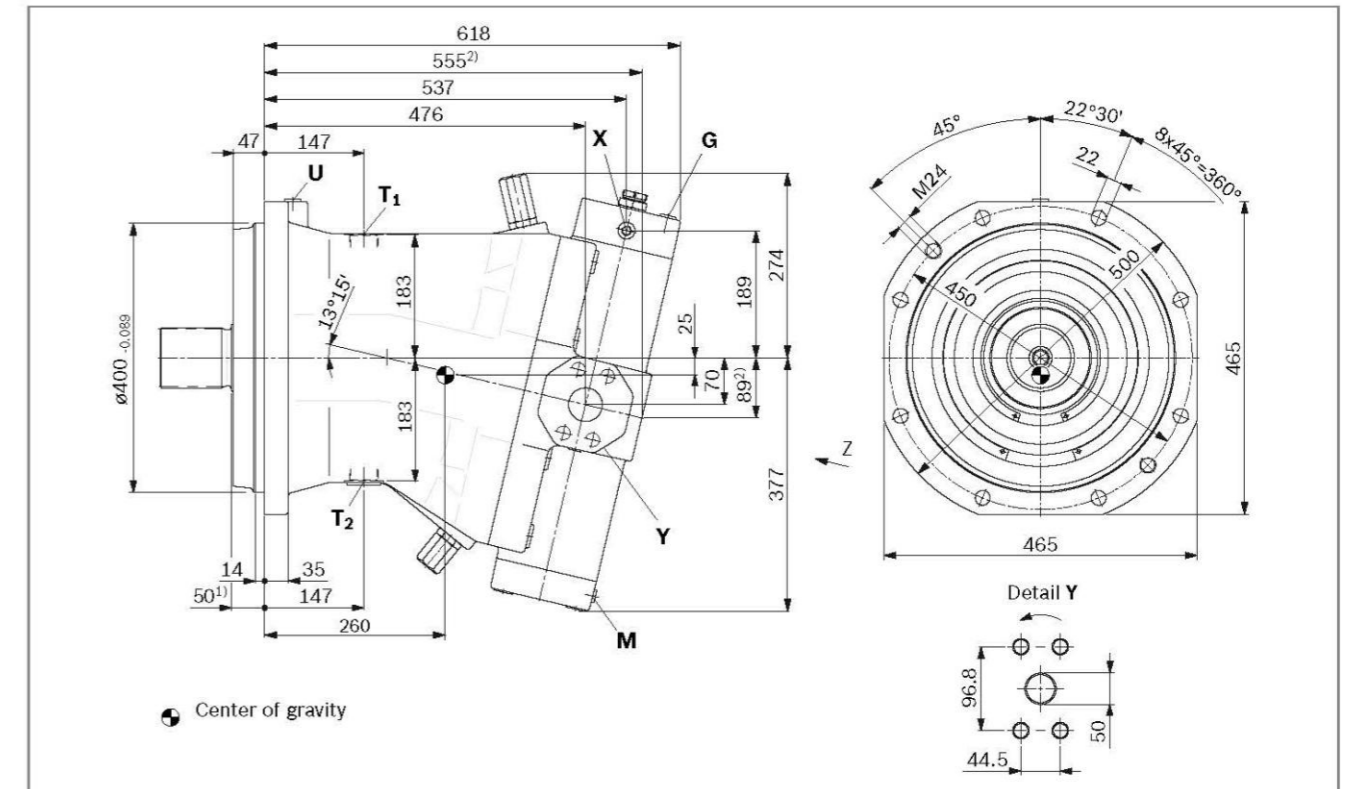

Ports	Standard	Size ³⁾	p _{max} [bar] ⁴⁾	State ⁵⁾
A, B	SAE J518 ⁶⁾	2 in	400	O
	DIN 13	M20 x 2.5; 24 deep		
A ₁ , B ₁	SAE J518 ⁶⁾	2 in	400	O
	DIN 13	M20 x 2.5; 24 deep		
T ₁	DIN 3852 ⁷⁾	M42 x 2; 20 deep	3	X ⁶⁾
T ₂	DIN 3852 ⁷⁾	M42 x 2; 20 deep	3	O ⁶⁾
G	DIN 3852 ⁷⁾	M18 x 1.5; 12 deep	400	X
G ₂	DIN 3852 ⁷⁾	M18 x 1.5; 12 deep	400	X
P	DIN 3852 ⁷⁾	M14 x 1.5; 12 deep	100	O
U	DIN 3852 ⁷⁾	M18 x 1.5; 12 deep	3	X
X	DIN 3852 ⁷⁾	M14 x 1.5; 12 deep	100	O
X	DIN 3852 ⁷⁾	M14 x 1.5; 12 deep	3	X
X ₃	DIN 3852 ⁷⁾	M14 x 1.5; 12 deep	400	O
M	DIN 3852 ⁷⁾	M14 x 1.5; 12 deep	400	X
M _A , M _B	DIN 3852 ⁷⁾	M14 x 1.5; 12 deep	400	X
M _{ST}	DIN 3852 ⁷⁾	M14 x 1.5; 12 deep	400	X

- 1) To shaft collar
- 2) Port plate 1/15 - SAE working ports A and B at rear
- 3) For notes on tightening torques, see the instruction manual
- 4) Depending on the application, momentary pressure peaks can occur. Keep this in mind when selecting measuring devices and fittings.

- 5) Only dimensions according to SAE J518, metric fastening thread is a deviation from the standard
- 6) Depending on installation position, T₁ or T₂, must be connected.
- 7) The countersink can be deeper than as specified in the standard
- 8) O=Must be connected (plugged when delivered)
X= Plugged (in normal operation)

▼ Location of the working ports on the port plates (view Z)

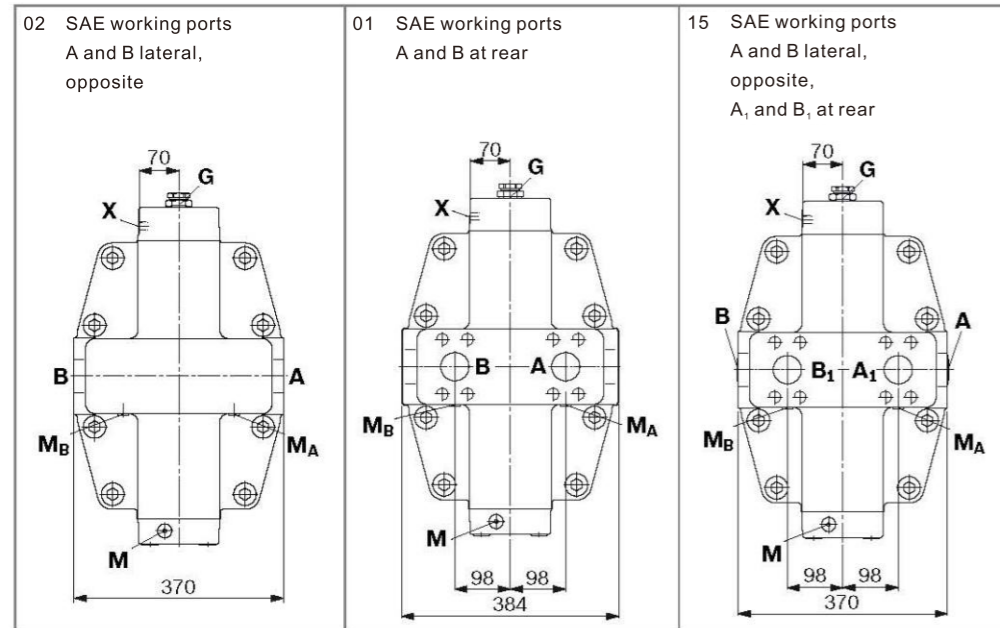

▼ Splined shaft DIN 5480

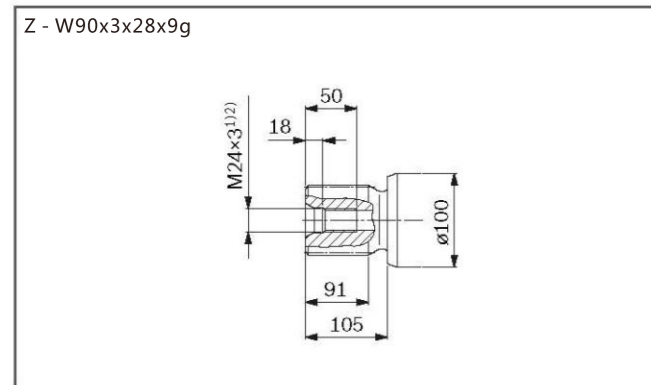

▼ Cyl. Keyed shaft, DIN 6885

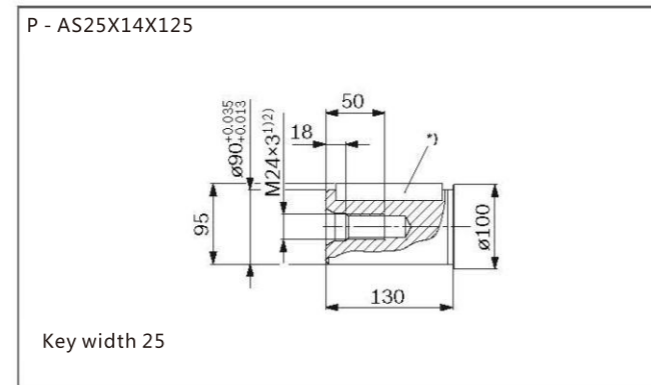

1) For notes on tightening torques, see the instruction manual
2) Center bore according to DIN 332 (thread according to DIN 13)

▼ EP1, EP2 - Proportional control, electric

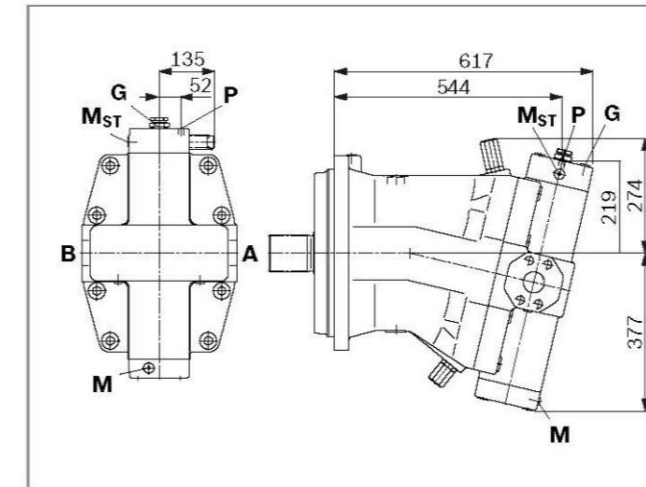

▼ EP.D, EP.G - Proportional control electric,
with pressure control fixed setting; remote controlled(EP.G)

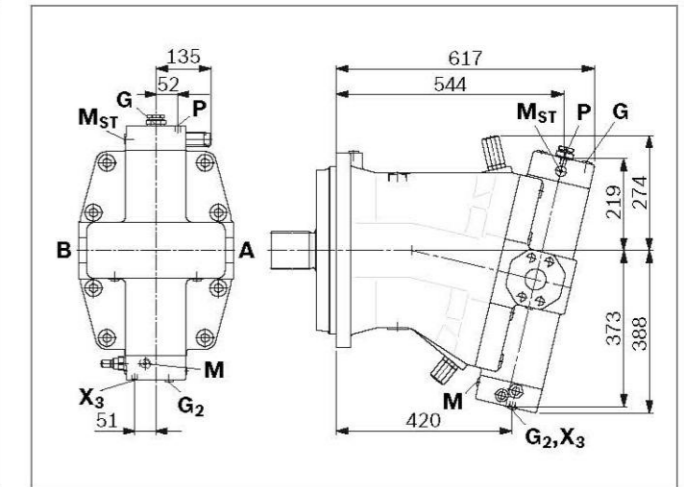

▼ HD.D, HD.G - Proportional control, hydraulic
with pressure control fixed setting; remote controlled (HD.G)

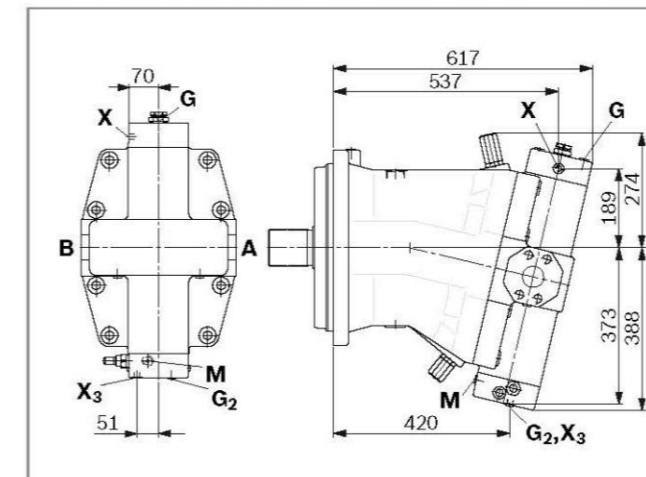

▼ EZ1, EZ2 - Two-point control, electric

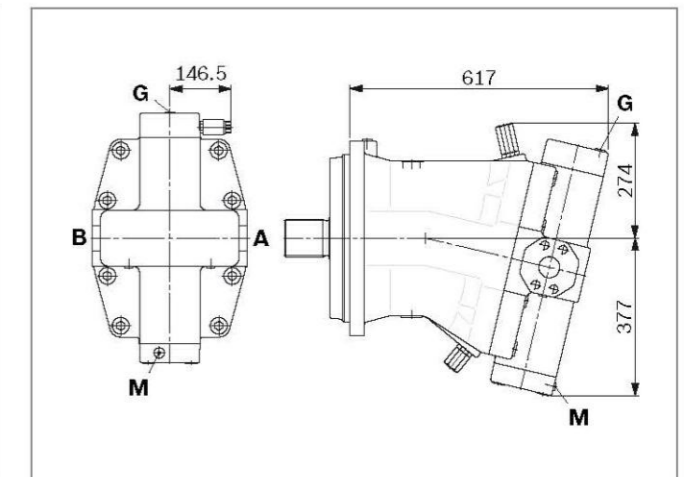

▼ HA1, HA2 / HA1T, HA2T - Automatic high-pressure related
control, with override hydraulic remote control, proportional

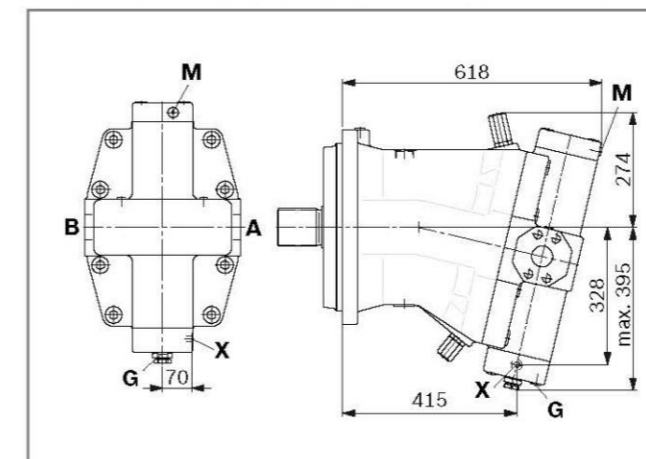

Connector for solenoids

DEUTSCH DT04-2P-EP04

Sizes 28 to 200

Molded connector, 2-pin, without bidirectional suppressor diode

The following type of protection ensues with an installed mating connector:

- ▶ IP67 (DIN/EN 60529) and
- ▶ IP69K (DIN 40050-9)

▼ Switching symbol

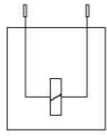

▼ Mating connector DEUTSCH DT06-2S-EP04

Consisting of	DT designation
1 housing	DT06-2S-EP04
1 wedge	W2S
2 sockets	0462-201-16141

Notice

- ▶ If necessary, you can change the position of the connector by turning the solenoid.
- ▶ The procedure is defined in the instruction manual.

HIRSCHMANN DIN EN 175 301-803-A/ISO 4400

Sizes 250 to 1000

Without bidirectional suppressor diode

Type of protection:

- ▶ IP65 (DIN/EN 60529)

The seal ring the cable fitting is suitable for lines of diameter 4.5mm to 10mm.

The mating connector is included in the scope of delivery.