

#### T6 Series-Vane Pumps

High pressure and high performance dowel pin type vane pumps are widely used for plastic machinery, casting machinery, metallurgy machinery, pressing machinery, refining machinery, construction machinery, marine-Machinery.

**Features**

1. With dowel pin vane structure, it can work in high pressure, low noise and long lifetime.
2. This vane pump can fit wide viscosity hydraulic medium, and be started at low temperature and work at high temperature.
3. As the vane pump adopts bilabial structure vane, it has high oil pollution resistance and wide speed scope.

#### T6 Series—single pumps

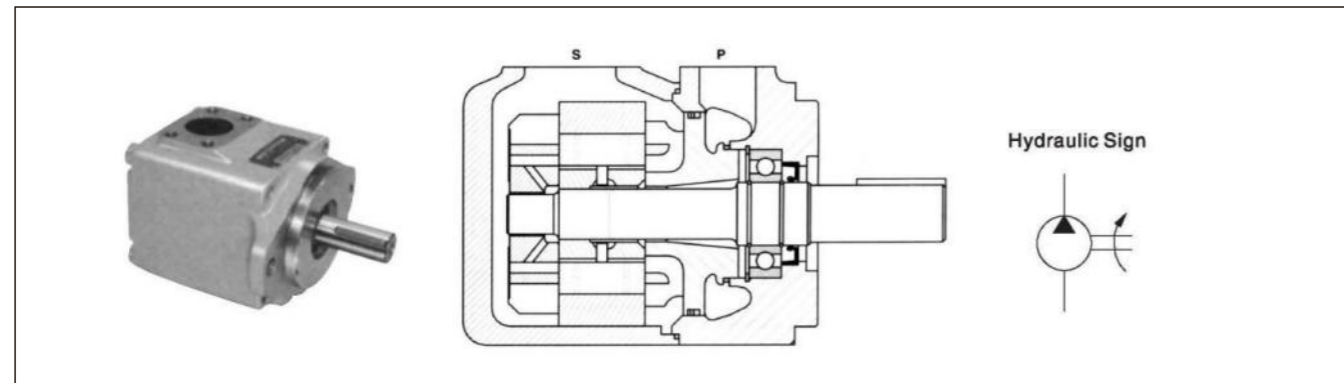

#### Model Designation

(F3-)	T6C	-17	-1	R	00	-A
Note	Series	Displacement	shaft type	Rotation	Outlet positions	Design Number
No-marking: Petroleum series oil	T6C	03, 05, 06, 08, 10, 12, 14, 17, 20, 22, 25, 28, 31	See installation dimensions	(Views from shaft end of pump) R-right hand for clockwise L-left hand for counterclockwise	(Viewed from shaft end of pump) 00-Opposite inlet port 01-Inline with inlet 02-90° CCW from inlet 03-90° CW from inlet	A
emulsification fluid water glycol-fluid	T6D	14, 17, 20, 24, 28, 31, 35, 38, 42, 45, 50				
F3: phosphate ester fluid	T6E	42, 45, 50, 52, 57, 62, 66, 72, 85				

#### Technical Data

series	Flow code (USgpm)	Geometric displacement mL/r	Max. pressure Mpa						Max. speed r/min		Min. speed r/min
			Antiwear hydraulic oil		General hydraulic oil or phosphate ester fluid		Water glycol fluid or water-oil emulsions		General hydraulic oil or antiwear hydraulic oil	Water glycol fluid or phosphate ester fluid or water emulsions	
			Instant	Continuous	Instant	Continuous	Instant	Continuous			
T6C	03	10.8	28	24.5	21	17.5	17.5	14	2800	1800	600
	05	17.2									
	06	21.3									
	08	26.4									
	10	34.1									
	12	37.1									
	14	46.0									
	17	58.3									
	20	63.8									
	22	70.3									
	25	79.3									
T6D	28	88.8	24.5	21	21	17.5	17.5	14	2500	1800	600
	31	100.0									
	14	47.6									
	17	58.2									
	20	66.0									
	24	79.5									
	28	89.7									
	31	98.3									
	35	111.0									
	38	120.3									
	42	136.0									
45	145.7										
T6E	50	158.0	24.5	21	21	17.5	17.5	14	2200	1800	600
	42	132.3									
	45	142.4									
	50	158.5									
	52	164.8									
	57	179.8									
	62	196.7									
	66	213.3									
	72	227.1									
	85	269.0									

#### Operation Performance

(Series)	(Geological Displacement) mL/rev	(Rotation speed) r/min	(Flow)L/min				(Input Power) KW			
			P=0 MPa	P=14 MPa	P=21 MPa	P=28 MPa	P=0.7 MPa	P=14 MPa	P=21 MPa	P=28 MPa
			L/min	L/min	L/min	L/min	KW	KW	KW	KW
T6C - 03	10.8	1000	10.8	5.8	—	—	1.0	3.6	—	—
		1500	16.2	11.2	7.7	—	1.3	5.3	8.4	—
T6C - 05	17.2	1000	17.2	12.2	8.7	—	1.1	5.1	8.4	—
		1500	25.8	20.8	17.3	12.8	1.4	7.5	12.2	13.8
T6C - 06	21.3	1000	21.3	16.3	12.8	—	1.1	6.0	10.0	—
		1500	31.9	26.9	23.4	18.9	1.5	8.9	14.7	17.2
T6C - 08	26.4	1000	26.4	21.4	17.9	13.4	1.2	7.2	12.1	14.2
		1500	39.6	34.6	42.2	37.7	1.6	10.7	17.1	21.4
T6C - 10	34.1	1000	34.1	29.1	25.6	21.1	1.3	8.9	15.1	18.4
		1500	51.1	46.1	42.6	38.1	1.7	13.9	22.3	27.5
T6C - 12	37.1	1000	37.1	32.1	28.6	24.1	1.3	9.6	16.3	20.0
		1500	55.6	50.6	47.1	42.6	1.7	14.4	24.1	30.0
T6C - 14	45.8	1000	45.8	40.8	37.3	32.5	1.4	11.7	19.9	24.7
		1500	68.7	63.7	60.2	55.7	1.9	17.6	29.5	37
T6C - 17	58.0	1000	58.0	53.0	49.5	45.0	1.6	14.5	24.8	31.3
		1500	87.0	82.0	78.5	74.0	2.1	21.9	36.9	46.9
T6C - 20	63.8	1000	63.8	58.3	56.3	53.8	1.5	16.0	23.7	31.4
		1500	95.7	90.2	88.2	86.6	2.2	24.0	35.4	46.8
T6C - 22	70.3	1000	70.3	65.3	61.8	57.3	1.7	17.3	29.6	37.9
		1500	105.4	100.4	96.9	92.4	2.3	26.1	44.1	56.9
T6C - 25	79.3	1000	79.3	74.3	70.8	66.3	1.8	19.3	33.2	42.8
		1500	118.9	113.9	110.4	105.9	2.5	29.1	49.5	64.2
T6C - 28*	88.8	1000	88.8	84.0	—	—	1.9	21.9	—	—
		1500	133.2	128.2	—	—	3.8	32.7	—	—
T6C - 31*	100.0	1000	100.0	95.0	—	—	2.0	24.4	—	—
		1500	150.0	145.0	—	—	2.8	36.5	—	—

#### Operatiol Performance

( Series )	(Geological Displacement) mL/rev	(Rotation speed) r/min	(Flow)L/min				(Input Power) KW			
			P=0 MPa	P=14 MPa	P=21 MPa	P=24.5 MPa	P=0.7 MPa	P=14 MPa	P=21 MPa	P=24.5 MPa
			L/min	L/min	L/min	L/min	KW	KW	KW	KW
T6D - 14	47.6	1000	47.6	38.3	32.1	27.5	1.5	12.5	20.7	23.8
		1500	71.4	62.1	55.9	51.3	2.3	18.5	30.6	35.8
T6D - 17	58.2	1000	58.2	48.9	45.2	42.7	1.7	15.0	22.0	25.0
		1500	87.3	78	74.3	71.8	2.5	22.2	32.6	37.0
T6D - 20	66.0	1000	66.0	56.7	50.5	45.9	1.7	16.8	28.0	33.0
		1500	99.0	89.7	83.5	78.9	2.8	24.9	41.7	49.5
T6D - 24	79.5	1000	79.5	70.2	64.0	54.9	1.9	19.9	33.4	39.7
		1500	119.3	110.0	103.8	99.2	3.0	29.6	49.8	59.6
T6D - 28	89.7	1000	89.7	80.4	74.2	69.6	2.0	22.3	37.5	44.8
		1500	134.5	125.2	119.0	114.4	3.2	33.2	55.9	67.2
T6D - 31	98.3	1000	98.3	89.0	82.8	78.2	2.1	24.3	40.9	49.1
		1500	147.4	138.1	131.9	127.3	3.3	36.2	61.0	73.7
T6D - 35	111.0	1000	111.0	101.7	95.5	90.9	2.3	27.3	46.0	55.5
		1500	166.5	157.2	151.0	146.4	3.5	40.7	68.7	83.2
T6D - 38	120.3	1000	120.3	111.0	104.8	100.2	2.4	29.4	49.8	60.1
		1500	180.4	171.1	164.9	160.3	3.7	43.9	74.3	90.2
T6D - 42	136.0	1000	136.0	126.7	120.5	115.9	2.6	33.1	56.0	68
		1500	204.0	194.7	188.5	183.9	4.0	49.4	83.7	102
T6D - 45	145.7	1000	145.7	136.4	130.2	125.6	2.7	35.3	59.9	72.8
		1500	218.5	209.3	203.0	198.4	4.1	52.8	89.5	109.2
T6D - 50*	158.0	1000	158.0	148.7	—	—	2.8	38.2	—	—
		1500	237.0	227.7	—	—	4.4	57.0	—	—
T6E - 42	132.3	1000	132.3	122.3	115.2	110.6	3.2	32.9	55.2	64.5
		1500	198.5	188.5	181.3	176.7	5.2	49.4	82.9	96.8
T6E - 45	142.4	1000	142.4	132.4	125.3	120.7	3.4	35.3	59.2	69.4
		1500	312.6	203.6	196.5	191.9	5.4	52.9	88.7	152.5
T6E - 50	158.5	1000	158.5	148.5	141.4	136.8	3.5	39.0	65.6	77.3
		1500	237.7	227.7	220.6	216	5.7	58.5	98.3	115.9
T6E - 52	164.8	1000	164.8	154.8	147.7	143.1	3.6	40.5	68.2	80.4
		1500	247.2	237.2	203.1	198.5	5.8	60.8	102.1	120.6
T6E - 57	179.8	1000	179.8	169.8	164.8	162.8	3.9	44.1	65.2	74.2
		1500	269.7	259.7	254.7	252.7	6.0	66.0	97.6	111.2
T6E - 62	196.7	1000	196.7	186.7	179.6	175	4.0	47.9	80.9	95.9
		1500	295.0	285.0	277.9	273.3	6.4	71.9	121.3	143.9
T6E - 66	213.3	1000	213.3	203.3	196.2	191.6	4.2	51.8	87.6	104.0
		1500	319.9	309.9	302.8	298.2	6.7	77.7	131.2	156.1
T6E - 72	227.1	1000	227.1	217.1	210.0	205.4	4.3	55.0	93.1	110.8
		1500	340.6	330.6	323.5	318.9	6.9	82.6	139.5	166.3
T6E - 85*	296.8	1000	269.0	—	—	—	—	—	—	—
		1500	403.0	—	—	—	—	—	—	—

\*050: the max intermittent pressure is 21 Mpa

\*085: the max rotation speed is 2000r/min, and the max intermittent pressure is 9MPa.

#### Installation Dimensions

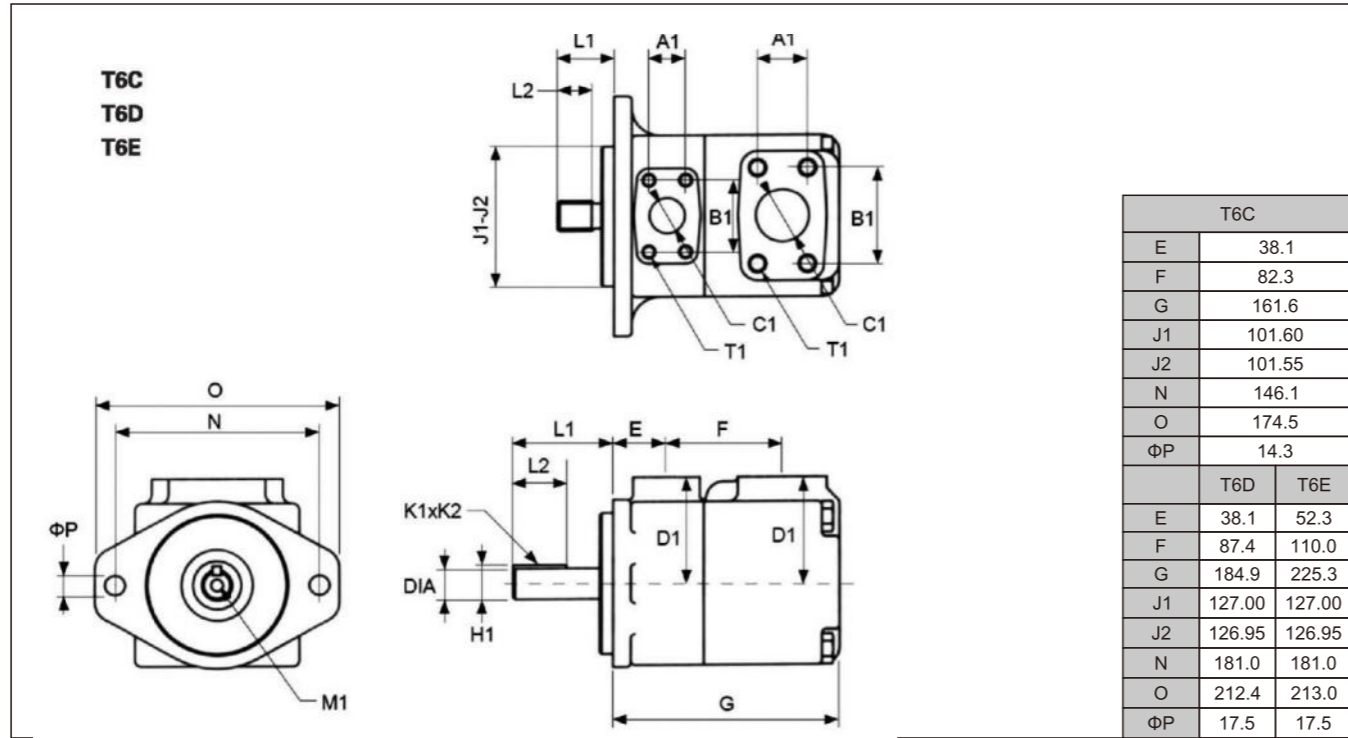

Shaft extension	Max torque(Nm)	Install Dimensions(mm)								
		T6C	T6D	T6E	L1	L2	Diameter	K1*K2	H1	M1
1	275	Parallel Keyed SAE B(Φ22)			71.4	38.1	22.225-22.200	6.35×6.30	24.95	M8x16
		Parallel Keyed SAE C(Φ31)	•		83.6	49.3	31.750-31.700	7.94×7.89	35.27	M10X20
		Parallel Keyed SAE CC(Φ38)		•	90.9	50.8	38.100-38.050	9.52×9.47	42.36	M10X20
2	238	Parallel Keyed Non SAE (Φ22)			58.2	31.7	22.225-22.200	4.76×4.71	24.53	—
		Parallel Keyed Non SAE (Φ31)		577	73.2	38.1	31.750-31.700	7.94×7.89	35.27	—
3	343	Parallel Keyed Non SAE (Φ31)		577	61.9	38.1	31.750-31.700	7.94×7.89	35.27	—
		Splined Keyed SAE B			40.7	24.5	SAE J498b1 Level,diameter Pitc 16/32,13 teeth		—	—
4	577	Splined Keyed SAE C	•	•	55.2	38.0	SAE J498b1 Level,diameter Pitc 12/24,14 teeth		—	—
		Splined Keyed SAE BB	•		45.5	24.5	SAE J498b1 Level,diameter Pitc 16/32,15 teeth		—	—
		Splined Keyed Non SAE		•	77.7	48.0	SAE J498b1 Level,diameter Pitc 12/24,14 teeth		—	—
		Splined Keyed SAE CC		•	62.2	31.5	SAE J498b1 Level,diameter Pitc 12/24,17 teeth		—	—

•work at maximum flow and pressure.

oil port	Flange	Install Dimensions(mm)						kg weight
		A1	B1	∅C1	D1	T1 Thread		
T6C	P 1"	F08	26.2	52.4	25.4	76.2	3/8"-16UNCX19.0	15.7
	S 1 1/2"	F12	35.8	70.0	38.1	76.2	1/2"-13UNC X 22.4	
T6D	P 1 1/4"	F10	30.2	58.7	31.8	82.6	7/16"-14UNC×22.3	24
	S 2"	F16	42.9	77.8	50.8	82.6	1/2"-13UNCx23.9	
T6E	P 1 1/2"	F12	35.7	69.8	37.1	98.6	1/2"-13UNCX23.4	43
	S 3"	F24	61.9	106.4	75.0	98.6	3/4"-11UNCx24.0	

#### T6 Series-Double pumps

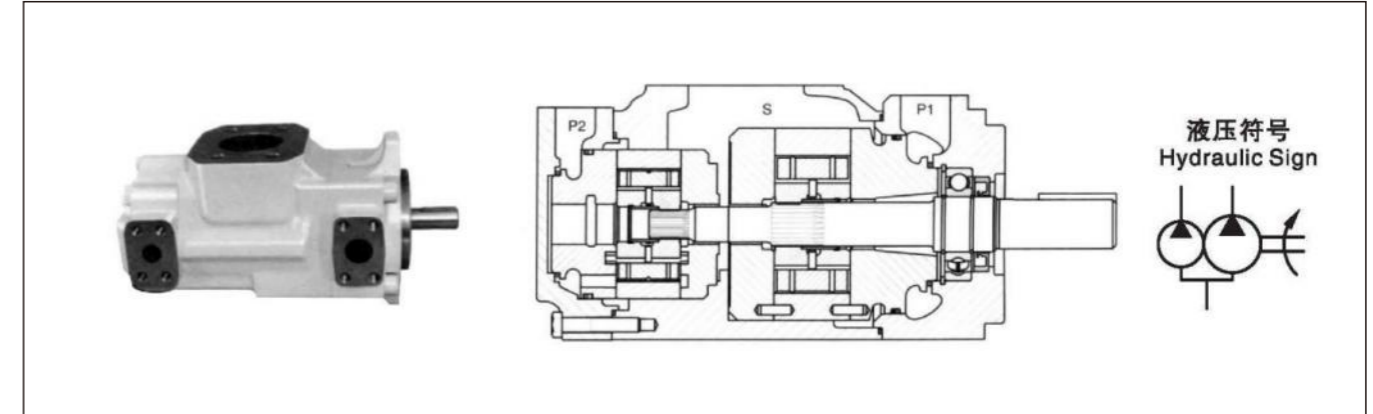

#### Model Designation

(F3-)	T6CC	-25	-17	-1	R	02	-C	10
Note	Series	Flow-shaft end Pump	Flow-cover and pump	Shaft type	Rotation	port positions	Design number	port dimensions
No-Marking: Petroleum series oil emulsification fluid water glycol-fluid F3 : phosphate ester fluid	T6CC	03, 05, 06, 08, 10, 12, 14, 17 20, 22, 25, 28, 31	03, 05, 06, 08, 10, 12, 14, 17 20, 22, 25, 28, 31	See installation dimensions	(Views from shaft end of pump) R-right hand for clockwise L-left hand for counter-clockwise	see picture below	C	00, 01, 10, 11 See installation dimensions
	T6DC	14, 17, 20, 24, 28, 31, 35, 38, 42, 45, 50	03, 05, 06, 08, 10, 12, 14, 17 20, 22, 25, 28, 31					no options
	T6EC	42, 45, 50, 52 57, 62, 66, 72, 85	03, 05, 06, 08 10, 12, 14, 17 20, 22, 25, 28, 31					
	T6ED	42, 45, 50, 52 57, 62, 66, 72, 85	14, 17, 20, 24 28, 31, 35, 38 42, 45, 50					

Specification is as the same as similar single pump, please refer to Page T6 single pump specification

#### Port positions( Views from shaft end of pump)

T6CC T6DC T6EC

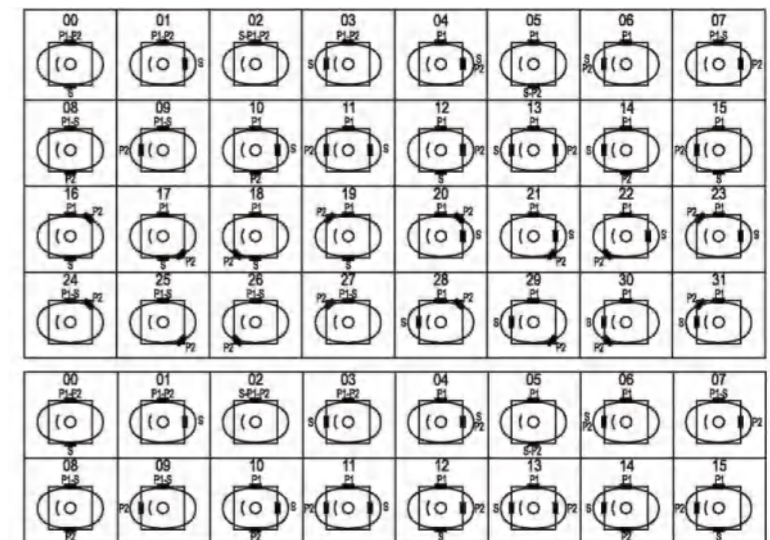

T6ED

#### Installation Dimensions

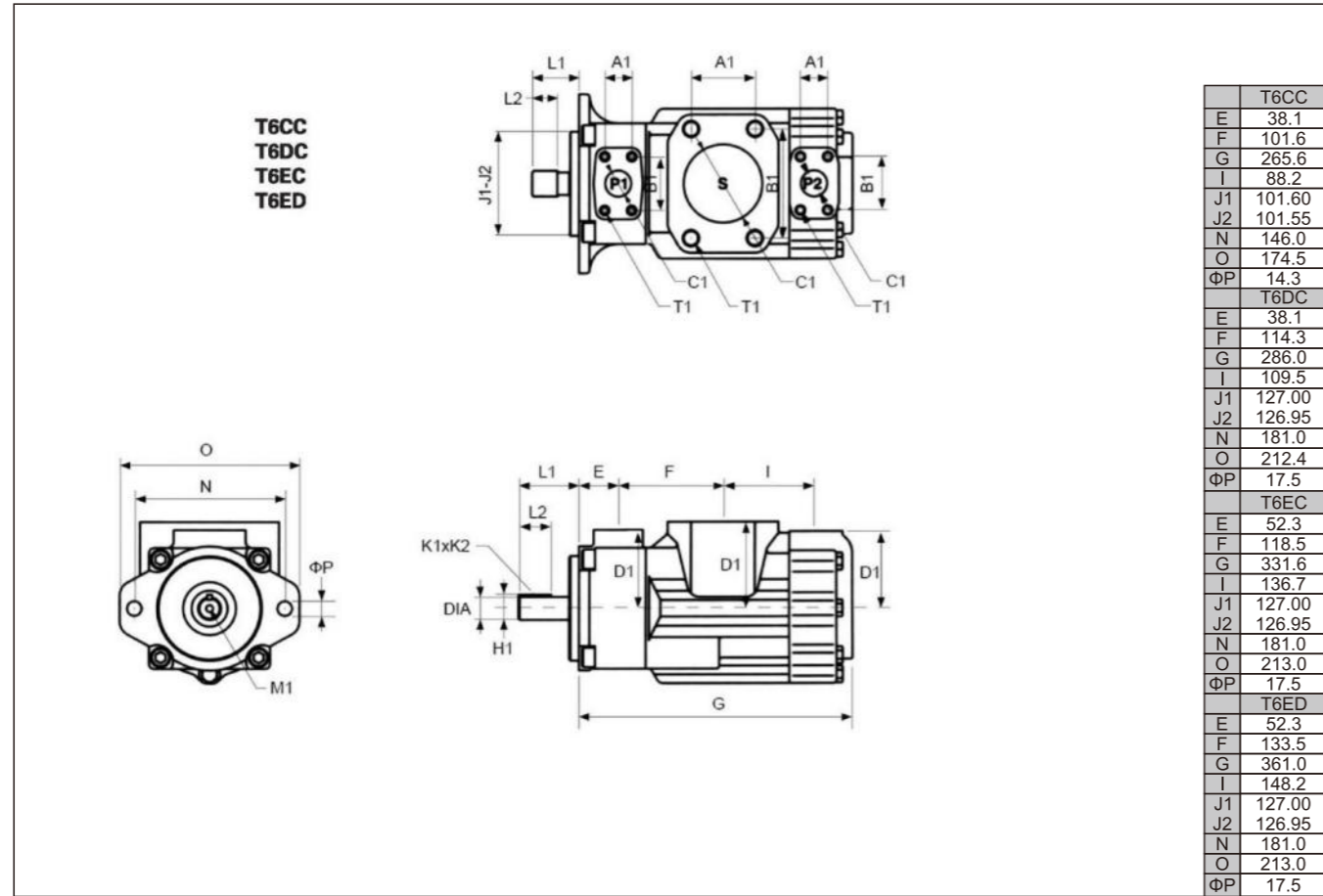

oil port	Flange	Dimensions(mm)						Kg weight		
		A1	B1	ΦC1	D1	T1 Thread				
						UNC				
T6CC	P1	1"	F08	26.2	52.4	25.4	76.2	3/8"-16UNCX19.0	26	
	P2	01-11:3/4"	F06	26.2	47.7	19.0	76.2	3/8"-16UNCX19.0		
		00-10:1"	F08	22.2	52.4	25.4	74.7			
T6DC	S	10-11:2 1/2"	F20	50.8	88.9	63.5	84.1	1/2"-13UNC X 23.9	36.6	
		00-01:3"	F24	61.9	106.4	76.2	84.1	5/8"-11UNCx28.4		
		1 1/4"	F10	30.2	58.7	31.8	82.6	7/16"-14UNCx22.3		
T6EC	P2	1"	F08	26.2	52.4	25.0	74.7	3/8"-16UNCX19.0	55	
		S	3"	F24	62.0	106.4	76.0	88.9		5/8"-11UNCx28.4
			3 1/2"	F28	69.9	120.6	88.9	102.4		5/8"-11UNCx29.5
T6ED	P1	1 1/4"	F12	35.7	69.8	37.1	98.4	1/2"-13UNC X 23.4	66	
		P2	1"	F08	26.2	52.4	25.0	74.7		3/8"-16UNCX19.0
			4"	F32	77.8	130.2	101.6	102.4		5/8"-11UNCx30.0

#### Installation Dimensions

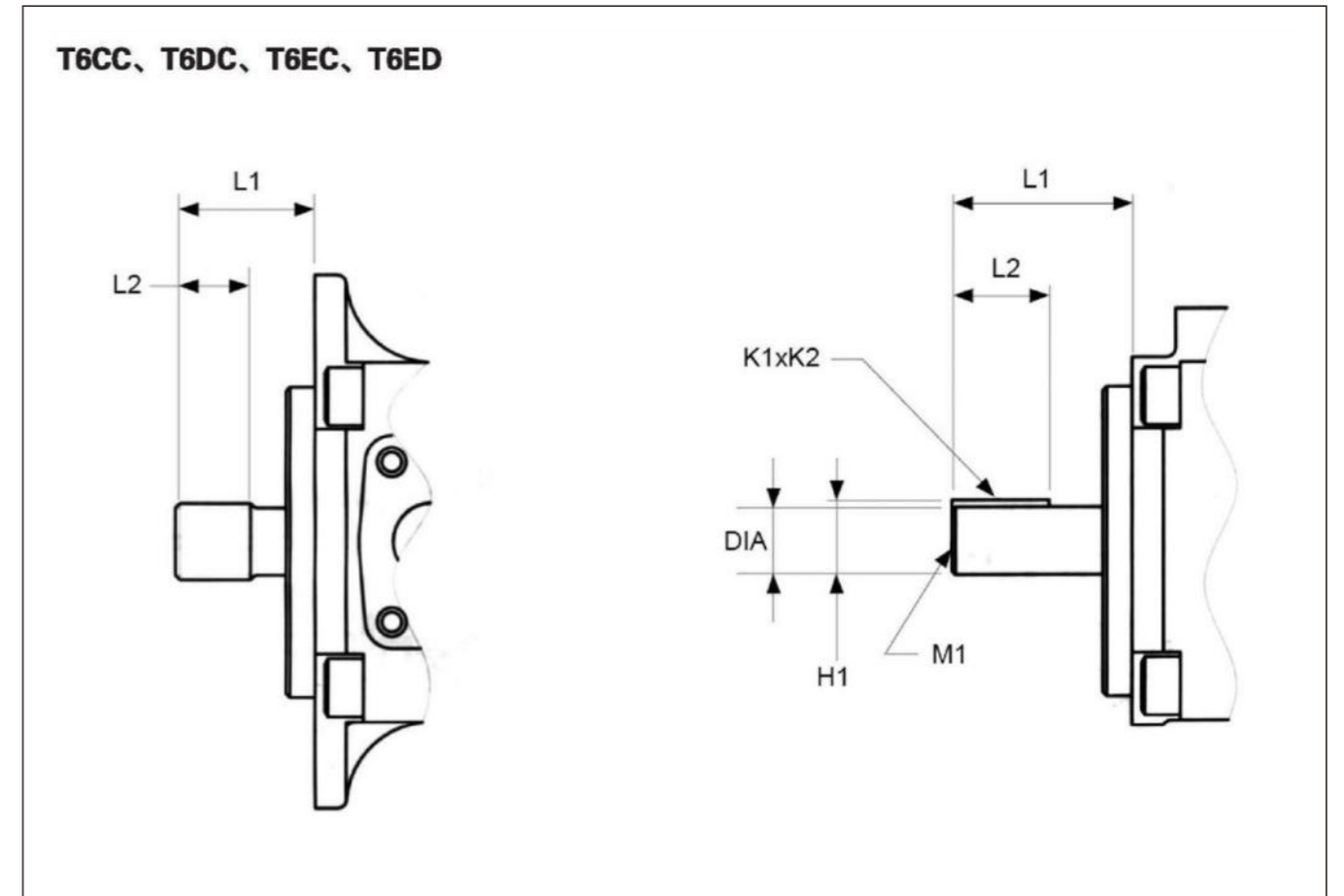

Shaft extension	Max torque(N. m)			Install Dimensions(mm)					
	T6CC	T6DC	T6EC T6DC	L1	L2	Diameter	K1xK2	H1	M1
1	Parallel Keyed Non SAE(Φ22)	238		58.2	31.7	22.225-22.200	6.35x6.30	24.95	M10x20.0
	Parallel Keyed SAE C(Φ31)		721	83.6	49.3	31.750-31.700	7.94x7.89	35.27	M10x20.0
	Parallel Keyed SAE CC(Φ38)			90.9	50.8	38.100-38.050	9.25x9.47	42.36	-
2	Parallel Keyed Non SAE (Φ31)		577	73.2	38.1	31.750-31.700	7.94x7.89	35.27	-
	Parallel Keyed Non SAE (Φ31)			61.9	38.1	31.750-31.700	7.94x7.89	35.27	-
3	Splined Keyed SAE BB	545		45.5	24.5	SAE J498b1 Level,diameter Pitc 16/32,15 teeth			-
	Splined Keyed SAE C			55.7	38.0	SAE J498b1 Level,diameter Pitc 12/24,14 teeth			-
4	Splined Keyed Non SAE			77.7	48.0	SAE J498b1 Level,diameter Pitc 12/24,14 teeth			-
	Splined Keyed SAE CC			62.2	31.5	SAE J498b1 Level,diameter Pitc 12/24,17 teeth			-
5	Splined Keyed SAE B	343		40.7	24.5	SAE J498b1 Level,diameter Pitc 16/32,13 teeth			-

•work at maximum flow and pressure.

## T6 Series- cartridge Model designation

(F3-)	PC-	T6D	-45	R	-10
Note	Cartridge mark	Series	Flow code	Rotation	Design number
No- marking: Petroleum series oil emulsification fluid water glycolfluid F3: phosphate ester fluid	PC-Cartridge kit of Single pump double pump shaft end PCT-Cartridge kit of double pump cover end	T6C	03、05、06、08、10、 12、14、17、20、22、 25、28、31	(Views form shaft end of pump) R-right hand for clockwise L- left hand for counterclockwise	10
		T6D	14、17、20、24、28、 31、35、38、42、45、 50		
		T6E	42、45、50、52、57、 62、66、72、85		

The data of relevant series, model are unanimous. Please see T6 series-single pumps data.

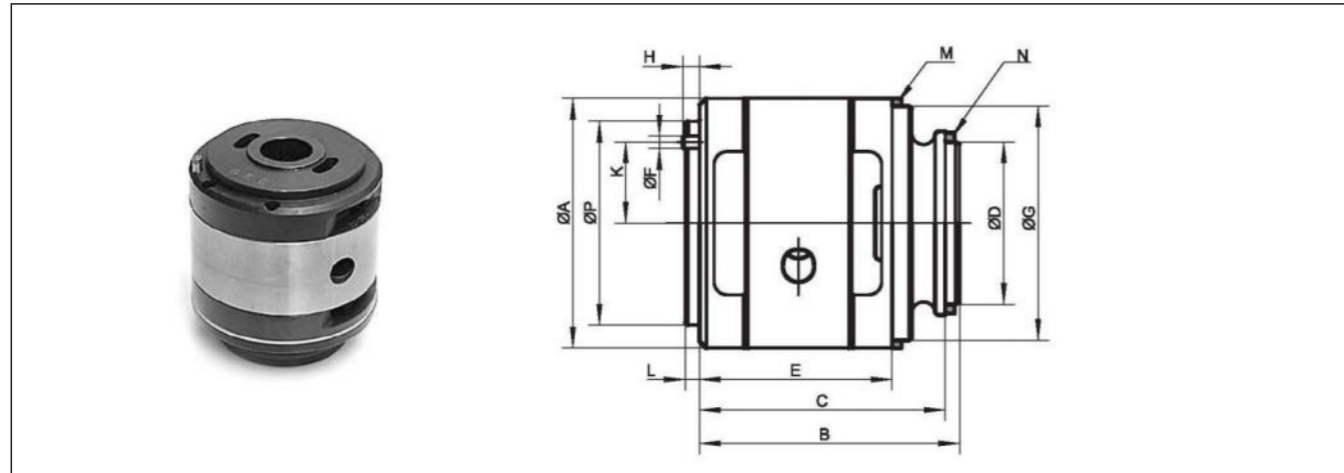

Series	ΦA	B	C	ΦD	E	ΦF	ΦG	H	K	M(Rubber washer)	N(Rubber washer)	ΦP	L
T6C	95.25	99.4	93.9	61.9	73.6	4.8	89.3	4.8	43.7	88.5x3.53	60x3.53	77.7	5.5
T6D	123.03	132.4	125.8	71.9	103	8.7	108.3	6.4	41.2	107.5x3.53	69.5x3.53	no step	
T6E	143.12	150.3	14.25	88	112.7	10.8	136.8	7.9	49.2	136.1x3.53	85.3x3.53		
Series	Inside spline tooth outline parameter of rotor												
	Number of teeth		Pitch		Pressure angle		Major diameter		Minor diameter				
T6C	28		40/80		45°		18.87		17.4				
T6D	25		2448		45°		28.19		25.82				
T6E	34		24/48		45°		37.72		35.35				